

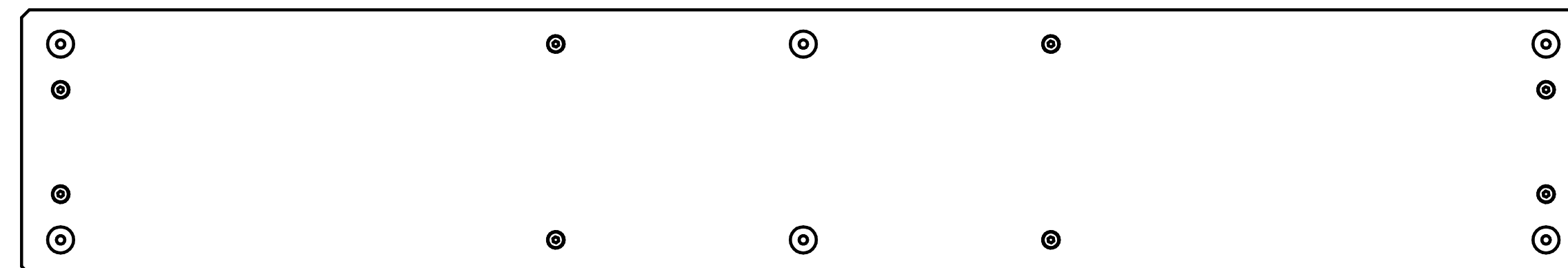

CHECK-PRINT
newbry
02-11-2022 05:10:19 PM

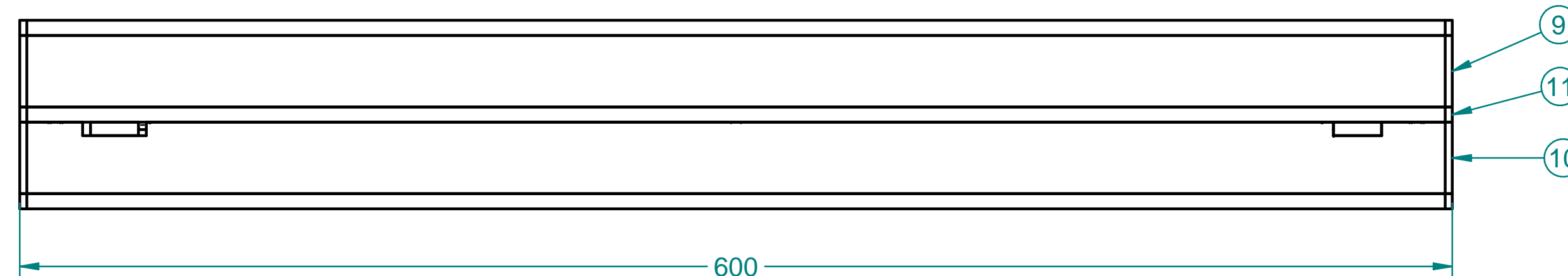
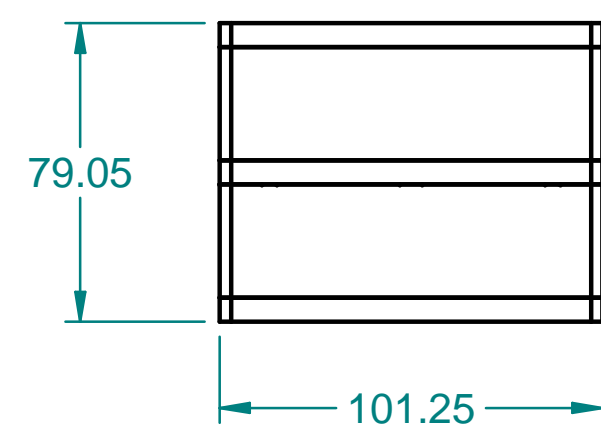
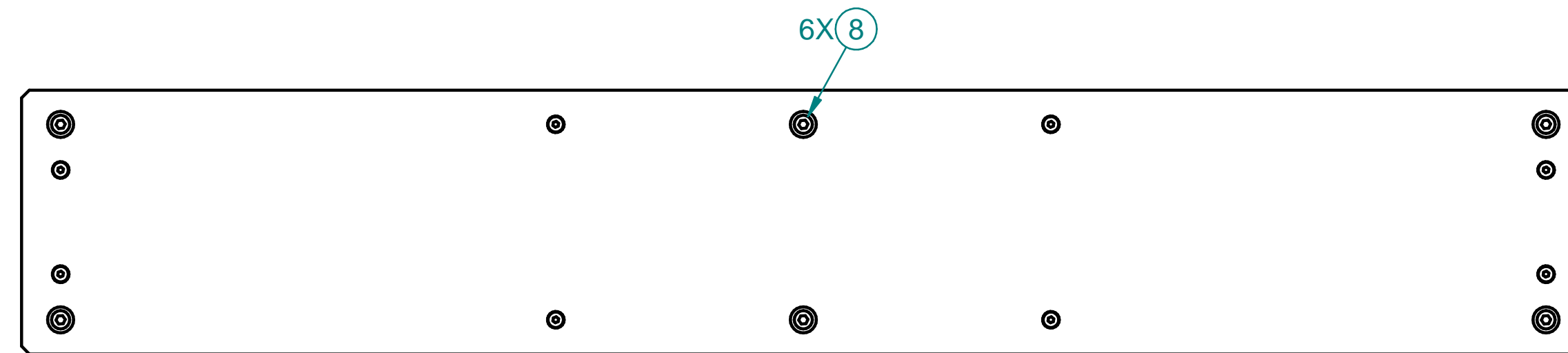
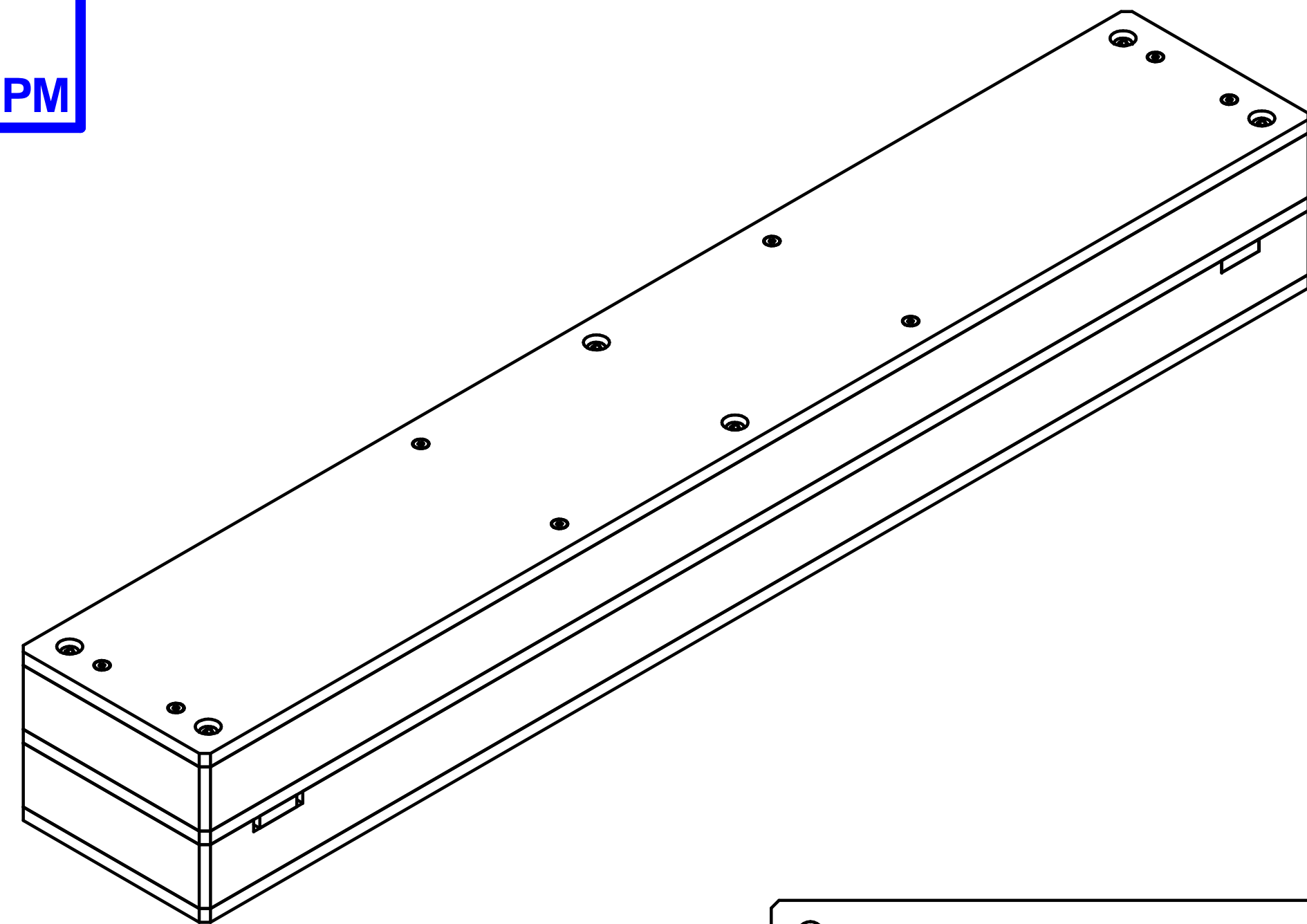

ITEM	PART NO	TITLE OR DESCRIPTION	QTY
11	REF-000203023	HANDLING FRAME, OB STAVE, 19-1	1
10	REF-000203022	BOTTOM COVER, SHIPPING FIXTURE, OB STAVE, 19-1	1
9	REF-000203021	TOP COVER, SHIPPING FIXTURE, OB STAVE, 19-1	1
8	SL050101-20961	SCREW, CAP, SCH, HEX, DIN 912, M4 X 0.7 X 50 mm, PART THD, SST 304,	6

DIMENSIONING AND TOLERANCING IS IAW ASME Y14.5-2009		SCALE: 1:2 DO NOT SCALE DRAWING	ESTIMATED MASS: 3.643 kg	DWG TYPE: ASSY																
UNLESS OTHERWISE SPECIFIED DIMENSIONS ARE IN MILLIMETERS		  ATLAS ITk RD53a, 19-1 OB STAVE FIXTURE, SHIPPING / STORAGE																		
TOLERANCES: BREAK EDGES 0.13 - 0.4 INTERNAL CORNERS R 0.4 MAX ANGLE ± 1° ALL SURF 125		THE DRAWINGS, SPECIFICATIONS AND OTHER DATA HEREIN PROVIDED SHALL NOT BE COPIED, PUBLISHED OR OTHERWISE FURTHER DISSEMINATED WITHOUT PRIOR WRITTEN PERMISSION OF STANFORD UNIVERSITY/SLAC																		
NEXT ASSEMBLIES:		ENGR S. NEWBRY DWN S. NEWBRY CHKR ---	DATE 20220211	APPROVALS																
<table border="1"> <thead> <tr> <th>DIMENSIONS</th> <th>< 6</th> <th>> 6</th> <th>> 30</th> <th>> 120</th> <th>> 315</th> <th>> 1000</th> <th>> 2000</th> </tr> </thead> <tbody> <tr> <td>GENERAL TOLERANCES</td> <td>± 0.1</td> <td>± 0.2</td> <td>± 0.3</td> <td>± 0.5</td> <td>± 0.8</td> <td>± 1.2</td> <td>± 2</td> </tr> </tbody> </table>		DIMENSIONS	< 6	> 6	> 30	> 120	> 315	> 1000	> 2000	GENERAL TOLERANCES	± 0.1	± 0.2	± 0.3	± 0.5	± 0.8	± 1.2	± 2	DRAWING NUMBER REF-000202479		REVISION NUMBER A D
DIMENSIONS	< 6	> 6	> 30	> 120	> 315	> 1000	> 2000													
GENERAL TOLERANCES	± 0.1	± 0.2	± 0.3	± 0.5	± 0.8	± 1.2	± 2													

CHECK-PRINT
newbry
02-11-2022 03:31:54 PM

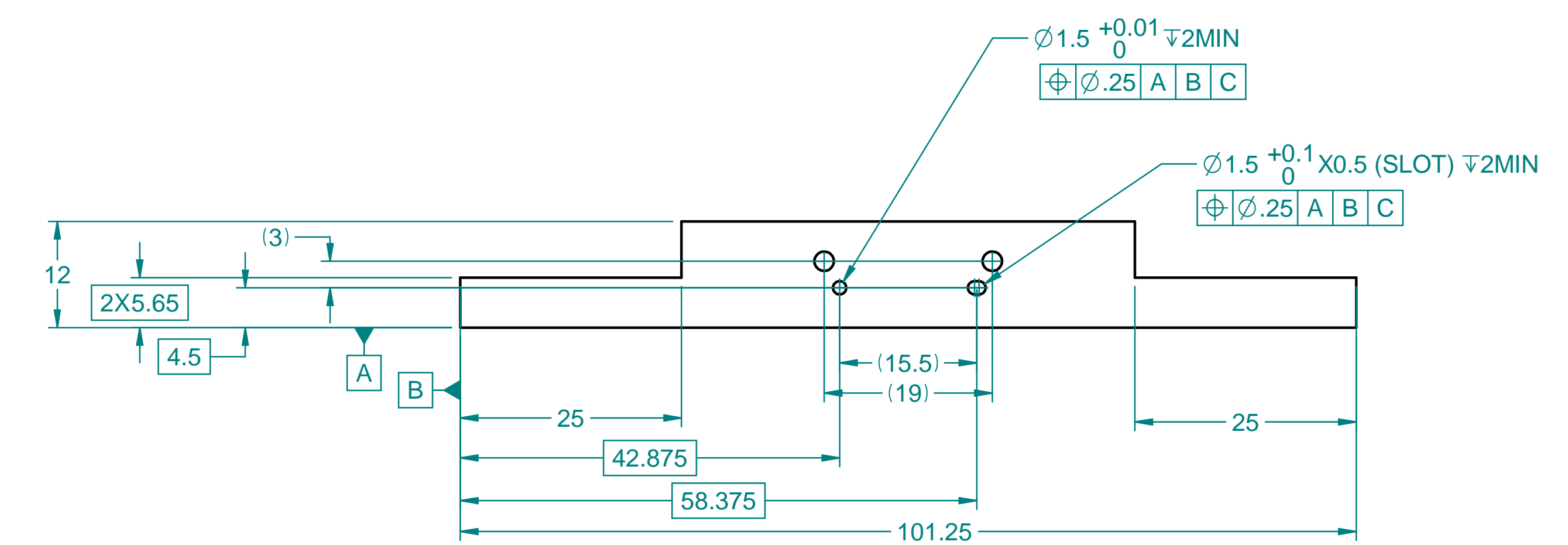
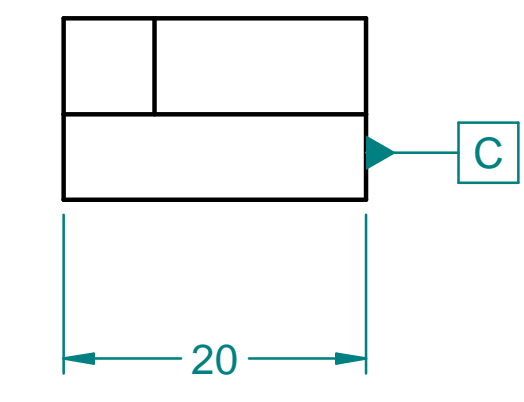
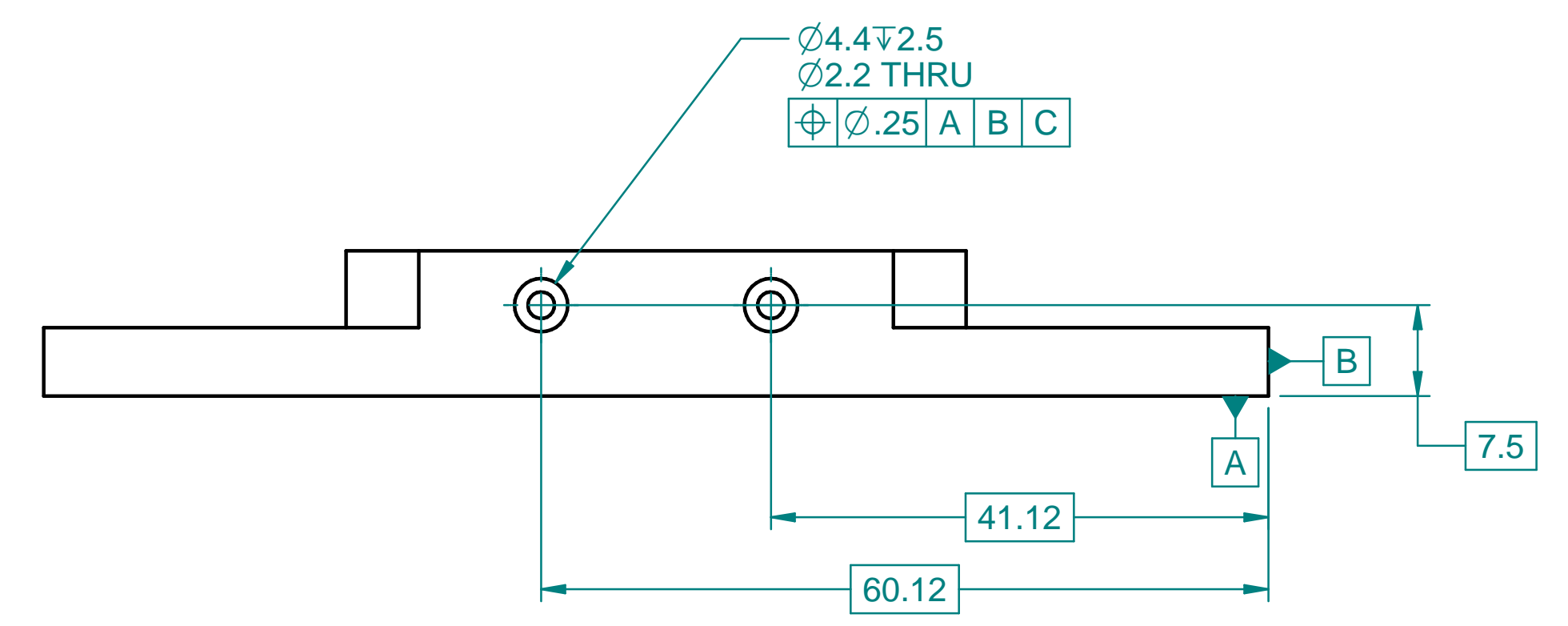
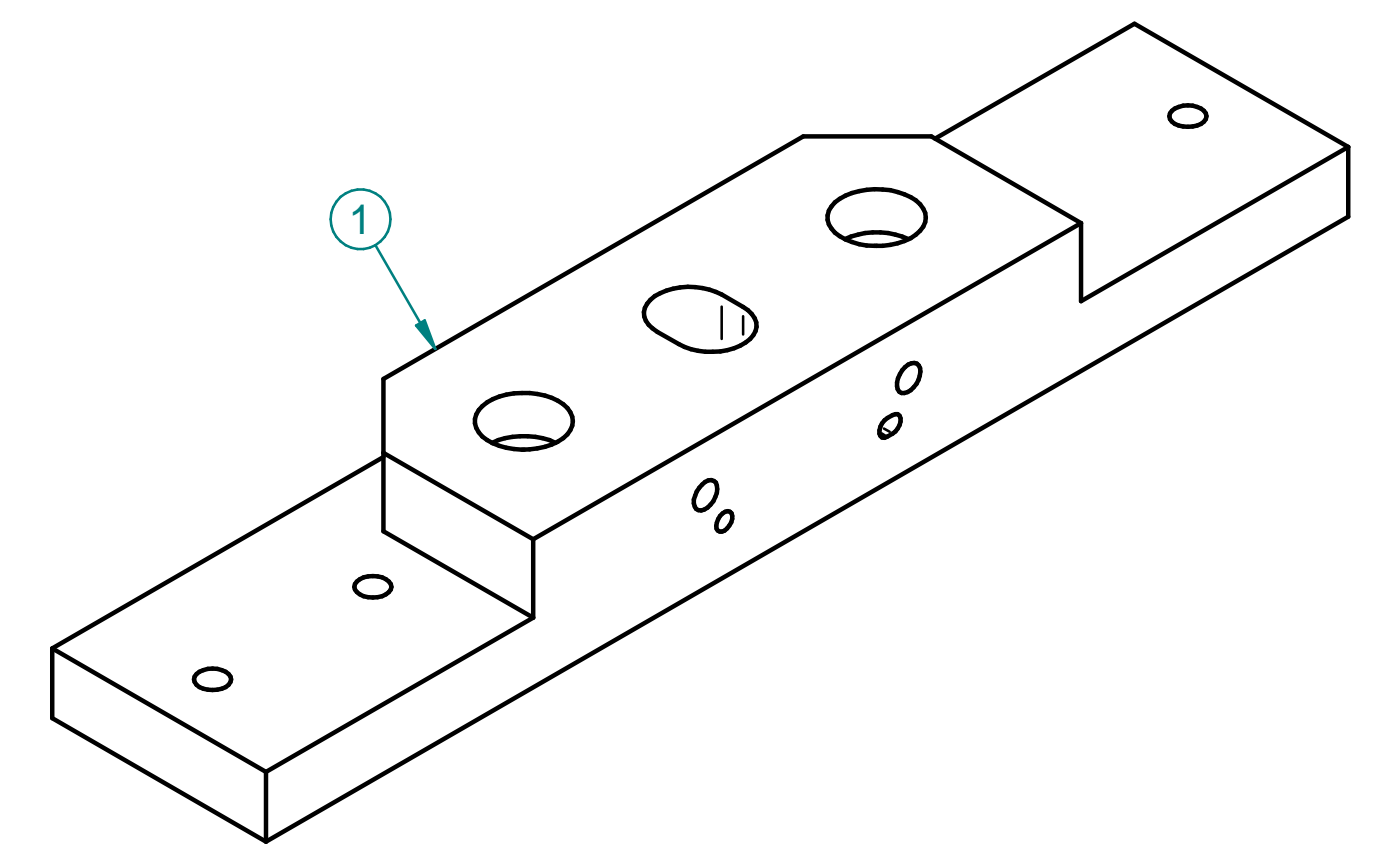
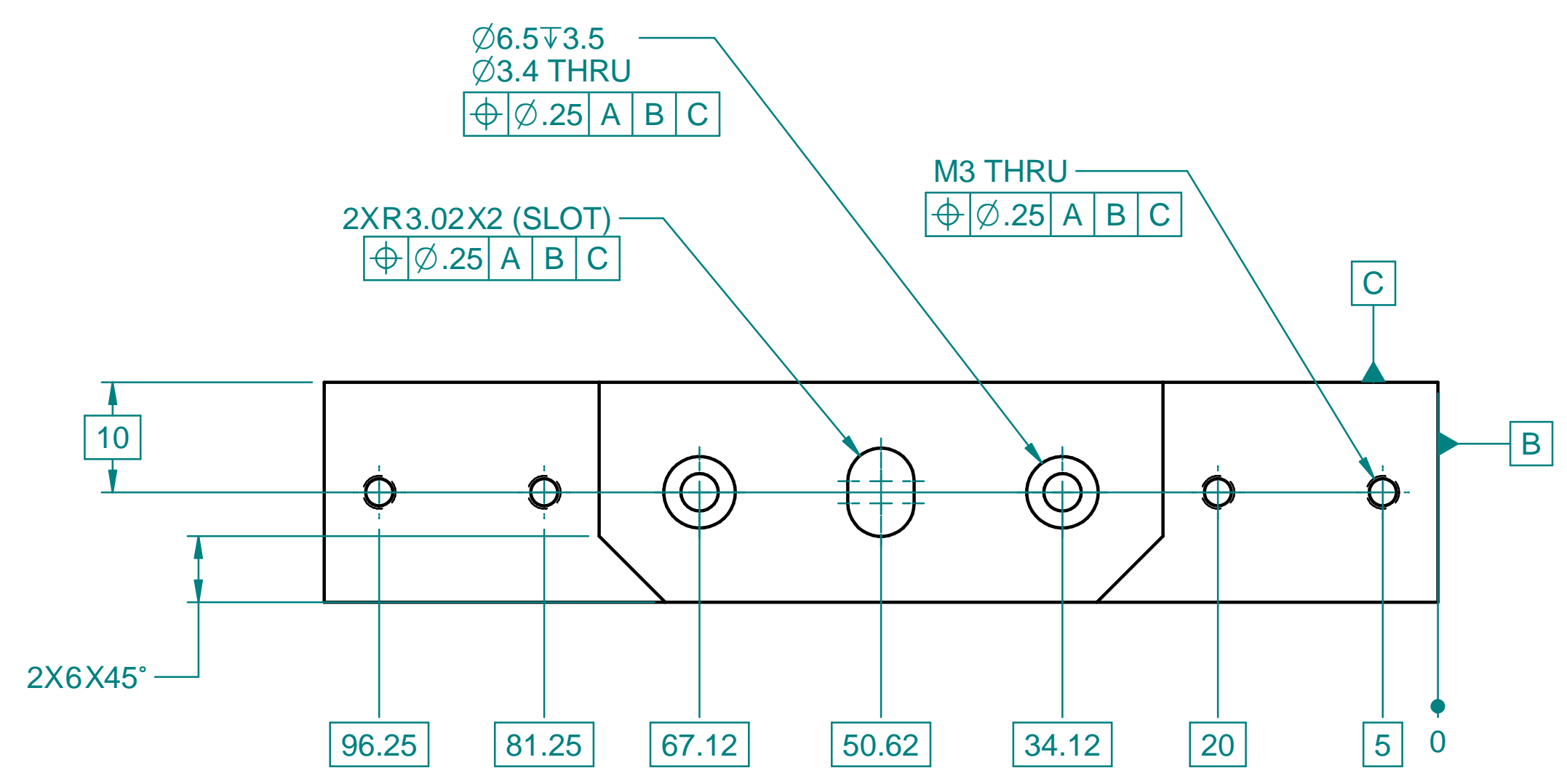

1	ALUMINUM ALLOY 6061-T6
ITEM	MATERIAL

DIMENSIONING AND TOLERANCING IS IN ACCORDANCE WITH ASME Y14.5-2009 UNLESS OTHERWISE SPECIFIED DIMENSIONS ARE IN MILLIMETERS TOLERANCES: BREAK EDGES 0.13 - 0.4 INTERNAL CORNERS R 0.4 MAX ANGLE $\pm 1^\circ$ ALL SURF $\sqrt{125}$	SCALE: 2:1 DO NOT SCALE DRAWING	ESTIMATED MASS: 0.045 kg	DWG TYPE: PART																
			ATLAS ITk RD53a, 19-1 OB STAVE MOUNTING, STAVE TO HF																
	REF-000203023 NEXT ASSEMBLIES:	ENGR S. NEWBRY DWN S. NEWBRY CHKR ---	DATE 20220211	APPROVALS --- --- ---															
<table border="1"> <tr> <td>DIMENSIONS</td> <td>< 6</td> <td>> 6</td> <td>> 30</td> <td>> 120</td> <td>> 315</td> <td>> 1000</td> <td>> 2000</td> </tr> <tr> <td>GENERAL TOLERANCES</td> <td>± 0.1</td> <td>± 0.2</td> <td>± 0.3</td> <td>± 0.5</td> <td>± 0.8</td> <td>± 1.2</td> <td>± 2</td> </tr> </table>	DIMENSIONS	< 6	> 6	> 30	> 120	> 315	> 1000	> 2000	GENERAL TOLERANCES	± 0.1	± 0.2	± 0.3	± 0.5	± 0.8	± 1.2	± 2	DRAWING NUMBER REF-000130209		REVISION NUMBER A
DIMENSIONS	< 6	> 6	> 30	> 120	> 315	> 1000	> 2000												
GENERAL TOLERANCES	± 0.1	± 0.2	± 0.3	± 0.5	± 0.8	± 1.2	± 2												

REF-000203023	1					
REV	DESCRIPTION	DWN	CHK	RAP	V	DATE

CHECK-PRINT
newbry
02-12-2022 03:40:13 PM

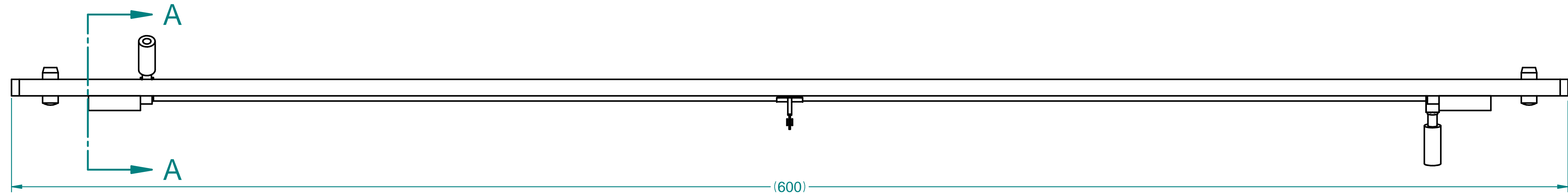
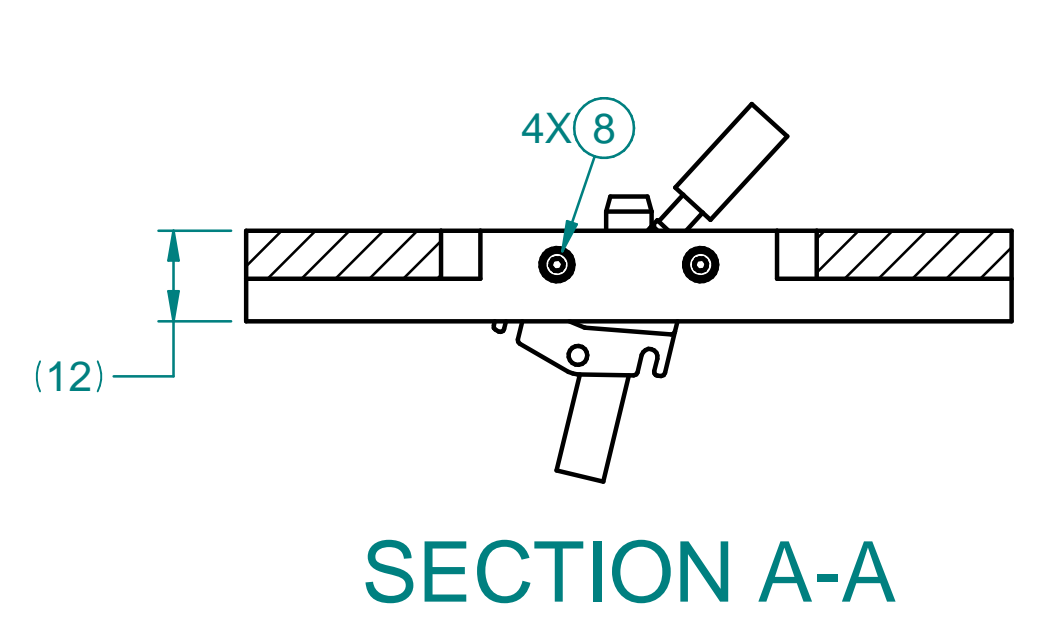
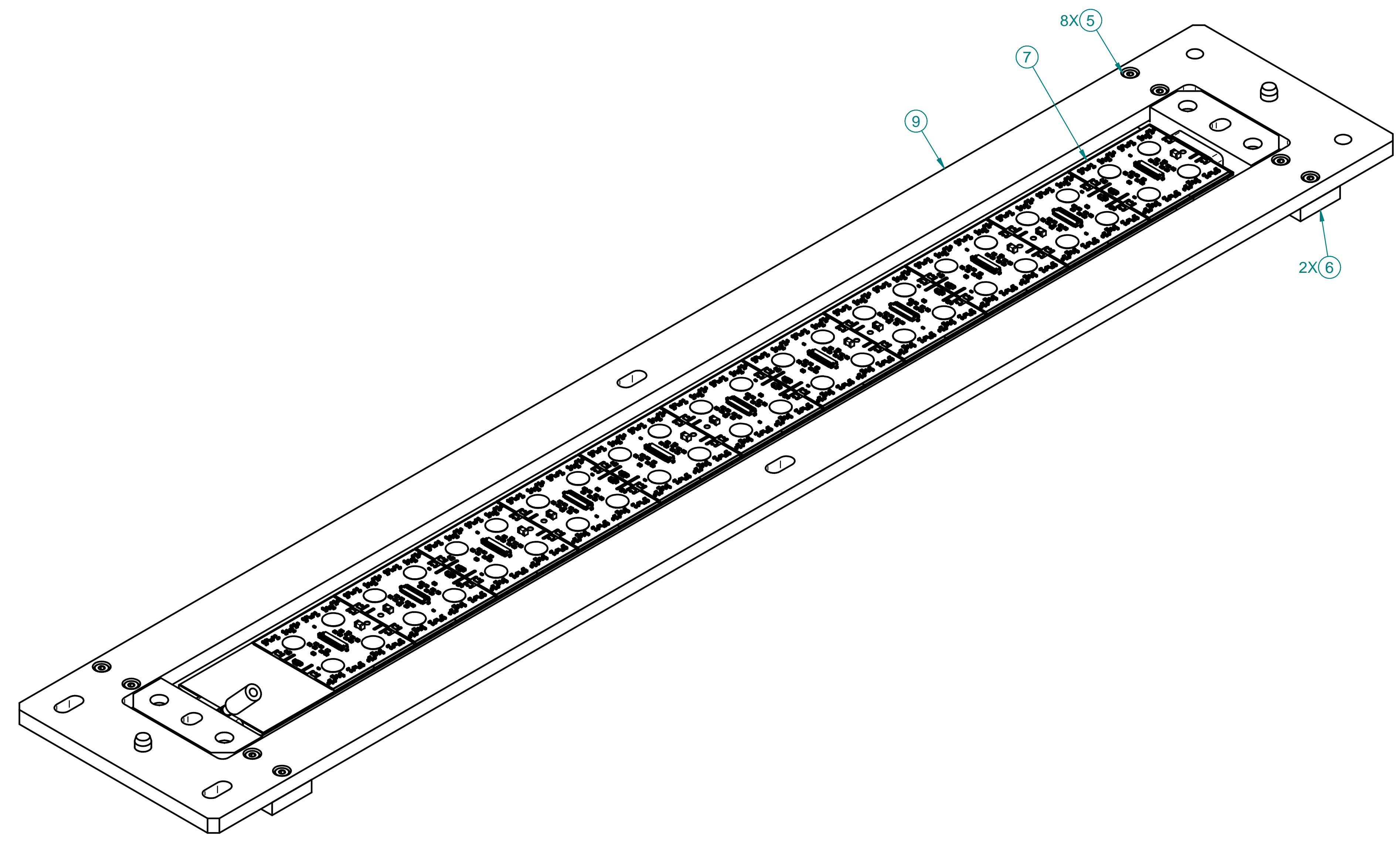

9	REF-000203572	HANDLING FRAME AND PINS, OB STAVE, 19-1	1
8	REF-000131206	MCMaster_91292A336__SHCS-M2x22_SST	4
7	REF-000202294	STAVE, OB, 19-1, PRELIMINARY	1
6	REF-000130209	MOUNTING, STAVE TO HF, OB, 19-1	2
5	R-000056594	SCREW, M3 X 8MM, LOW PROFILE SHCS	8
ITEM	PART NO	TITLE OR DESCRIPTION	QTY

---	DIMENSIONING AND TOLERANCING IS IAW ASME Y14.5-2009		SCALE: 1:1 DO NOT SCALE DRAWING	ESTIMATED MASS: 0 kg	DWG TYPE: ASSY																
---	UNLESS OTHERWISE SPECIFIED DIMENSIONS ARE IN MILLIMETERS			ATLAS ITk RD53a, 19-1 OB STAVE HANDLING FRAME																	
---	TOLERANCES: BREAK EDGES 0.13 - 0.4 INTERNAL CORNERS R 0.4 MAX ANGLE ± 1° ALL SURF 125																				
---	REF-000202041		THE DRAWINGS, SPECIFICATIONS AND OTHER DATA HEREIN PROVIDED SHALL NOT BE COPIED, PUBLISHED OR OTHERWISE FURTHER DISSEMINATED WITHOUT PRIOR WRITTEN PERMISSION OF STANFORD UNIVERSITY/SLAC	ENGR S. NEWBRY DWN S. NEWBRY CHKR ---	DATE 20220211 APPROVALS --- --- ---																
---	NEXT ASSEMBLIES:	<table border="1"> <tr> <td>DIMENSIONS</td> <td>< 6</td> <td>> 6</td> <td>> 30</td> <td>> 120</td> <td>> 315</td> <td>> 1000</td> <td>> 2000</td> </tr> <tr> <td>GENERAL TOLERANCES</td> <td>± 0.1</td> <td>± 0.2</td> <td>± 0.3</td> <td>± 0.5</td> <td>± 0.8</td> <td>± 1.2</td> <td>± 2</td> </tr> </table>	DIMENSIONS	< 6	> 6	> 30	> 120	> 315	> 1000	> 2000	GENERAL TOLERANCES	± 0.1	± 0.2	± 0.3	± 0.5	± 0.8	± 1.2	± 2	DRAWING NUMBER REF-000203023	REVISION NUMBER A	D
DIMENSIONS	< 6	> 6	> 30	> 120	> 315	> 1000	> 2000														
GENERAL TOLERANCES	± 0.1	± 0.2	± 0.3	± 0.5	± 0.8	± 1.2	± 2														

REF-00203023	1				
REV	DESCRIPTION	DWN	CHKR	APVD	DATE

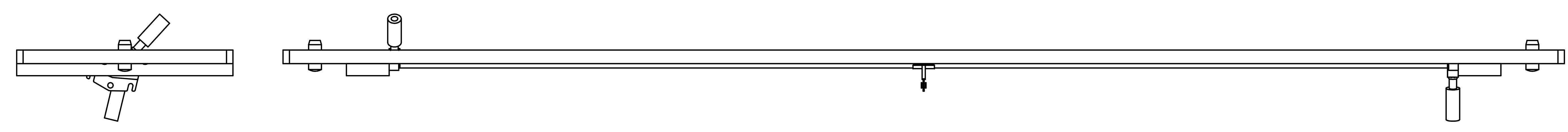
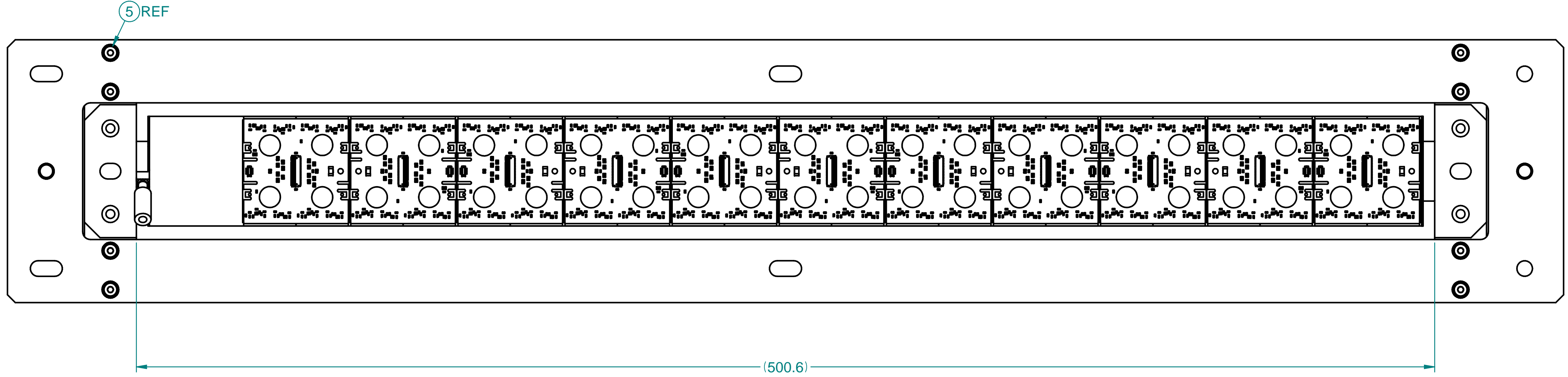

---	DIMENSIONING AND TOLERANCING IS IAW ASME Y14.5-2009	SCALE: 1:1 DO NOT SCALE DRAWING	ESTIMATED MASS: 0 kg	DWG TYPE: ASSY																							
---	UNLESS OTHERWISE SPECIFIED DIMENSIONS ARE IN MILLIMETERS		ATLAS ITk RD53a, 19-1 OB STAVE HANDLING FRAME																								
---	TOLERANCES: BREAK EDGES 0.13 - 0.4 INTERNAL CORNERS R 0.4 MAX ANGLE ± 1° ALL SURF 125		<small>THE DRAWINGS, SPECIFICATIONS AND OTHER DATA HEREIN PROVIDED SHALL NOT BE COPIED, PUBLISHED OR OTHERWISE FURTHER DISSEMINATED WITHOUT PRIOR WRITTEN PERMISSION OF STANFORD UNIVERSITY/SLAC</small>																								
REF-00202041	---	ENGR S. NEWBRY	DATE 20220211	APPROVALS																							
NEXT ASSEMBLIES:	---	DWN S. NEWBRY	---	---																							
	---	CHKR ---	---	---																							
	<table border="1"> <tr> <th>DIMENSIONS</th> <th>< 6</th> <th>> 6</th> <th>> 30</th> <th>> 120</th> <th>> 315</th> <th>> 1000</th> <th>> 2000</th> </tr> <tr> <th>GENERAL TOLERANCES</th> <td>± 0.1</td> <td>± 0.2</td> <td>± 0.3</td> <td>± 0.5</td> <td>± 0.8</td> <td>± 1.2</td> <td>± 2</td> </tr> </table>	DIMENSIONS	< 6	> 6	> 30	> 120	> 315	> 1000	> 2000	GENERAL TOLERANCES	± 0.1	± 0.2	± 0.3	± 0.5	± 0.8	± 1.2	± 2	<table border="1"> <tr> <th>DRAWING NUMBER</th> <td>REF-00203023</td> <th>REVISION NUMBER</th> <td>A</td> </tr> <tr> <td></td> <td></td> <td></td> <td>D</td> </tr> </table>	DRAWING NUMBER	REF-00203023	REVISION NUMBER	A				D	SH 2 OF 3
DIMENSIONS	< 6	> 6	> 30	> 120	> 315	> 1000	> 2000																				
GENERAL TOLERANCES	± 0.1	± 0.2	± 0.3	± 0.5	± 0.8	± 1.2	± 2																				
DRAWING NUMBER	REF-00203023	REVISION NUMBER	A																								
			D																								

REF-00203023	1				
REV	DESCRIPTION	DWN	CHKR	APVD	DATE

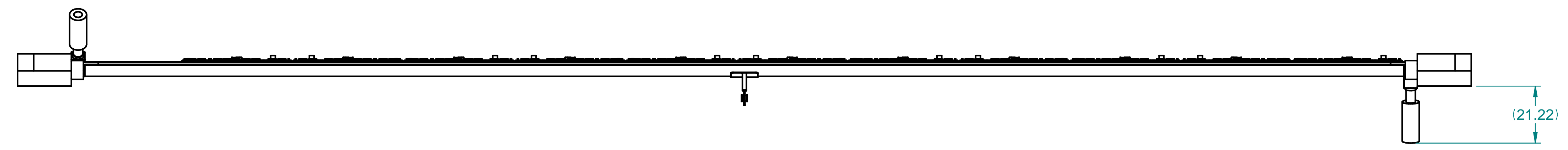
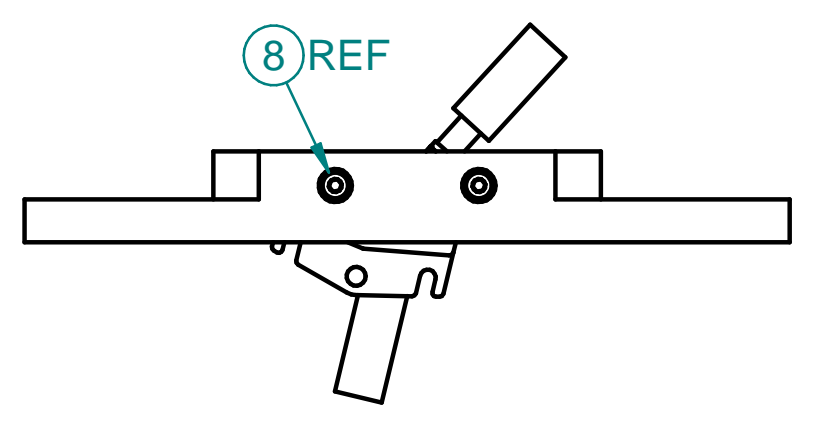
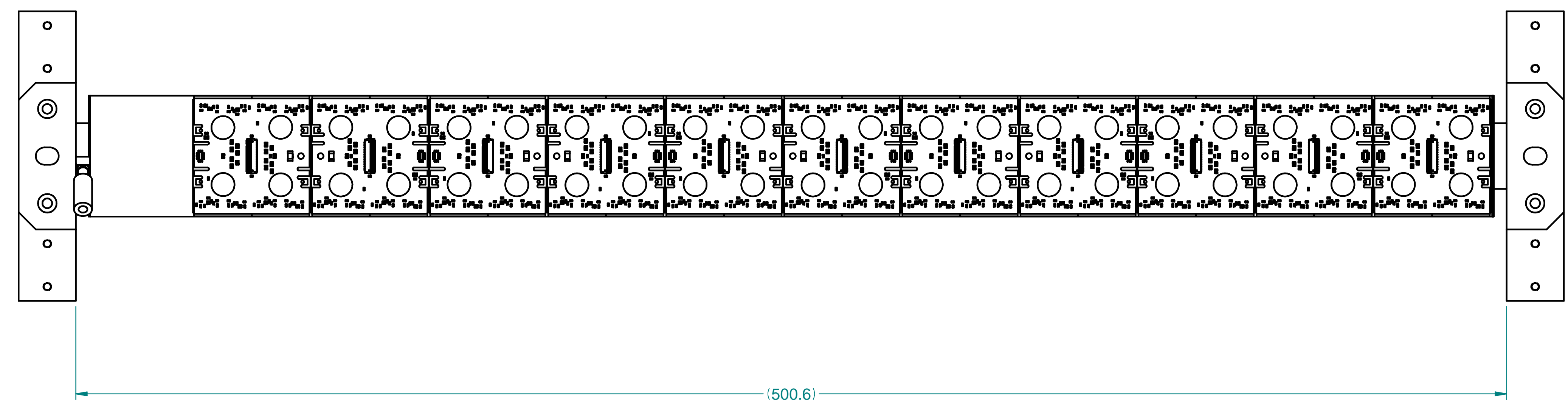

---	DIMENSIONING AND TOLERANCING IS IN ACCORDANCE WITH ASME Y14.5-2009	SCALE: 1:1 DO NOT SCALE DRAWING	ESTIMATED MASS: 0 kg	DWG TYPE: ASSY
---	UNLESS OTHERWISE SPECIFIED DIMENSIONS ARE IN MILLIMETERS	SLAC NATIONAL ACCELERATOR LABORATORY	U.S. DEPARTMENT OF ENERGY	ATLAS ITk RD53a, 19-1 OB STAVE HANDLING FRAME
---	TOLERANCES: BREAK EDGES 0.13 - 0.4 INTERNAL CORNERS R 0.4 MAX	THE DRAWINGS, SPECIFICATIONS AND OTHER DATA HEREIN PROVIDED SHALL NOT BE COPIED, PUBLISHED OR OTHERWISE FURTHER DISSEMINATED WITHOUT PRIOR WRITTEN PERMISSION OF STANFORD UNIVERSITY/SLAC		
---	ANGLE $\pm 1^\circ$ ALL SURF 125°	ENGR S. NEWBRY DWN S. NEWBRY CHKR ---	DATE 20220211	APPROVALS ---
REF-00202041	DIMENSIONS < 6 ± 0.1 6 - 30 ± 0.2 30 - 120 ± 0.3 120 - 315 ± 0.5 315 - 1000 ± 0.8 1000 - 2000 ± 1.2 > 2000 ± 2	DRAWING NUMBER REF-00203023		
NEXT ASSEMBLIES:	GENERAL TOLERANCES	REVISION NUMBER A D		

REF-000203572	1				
REV	DESCRIPTION	DWN	CHKR	APVD	DATE

NOTES UNLESS OTHERWISE SPECIFIED:
 1. MATERIAL: SEE TABLE
 2. APPLY ITEM 3 (ADHESIVE) TO JOIN ITEMS 1 AND 2

CHECK-PRINT
 newbry
 02-12-2022 04:12:05 PM

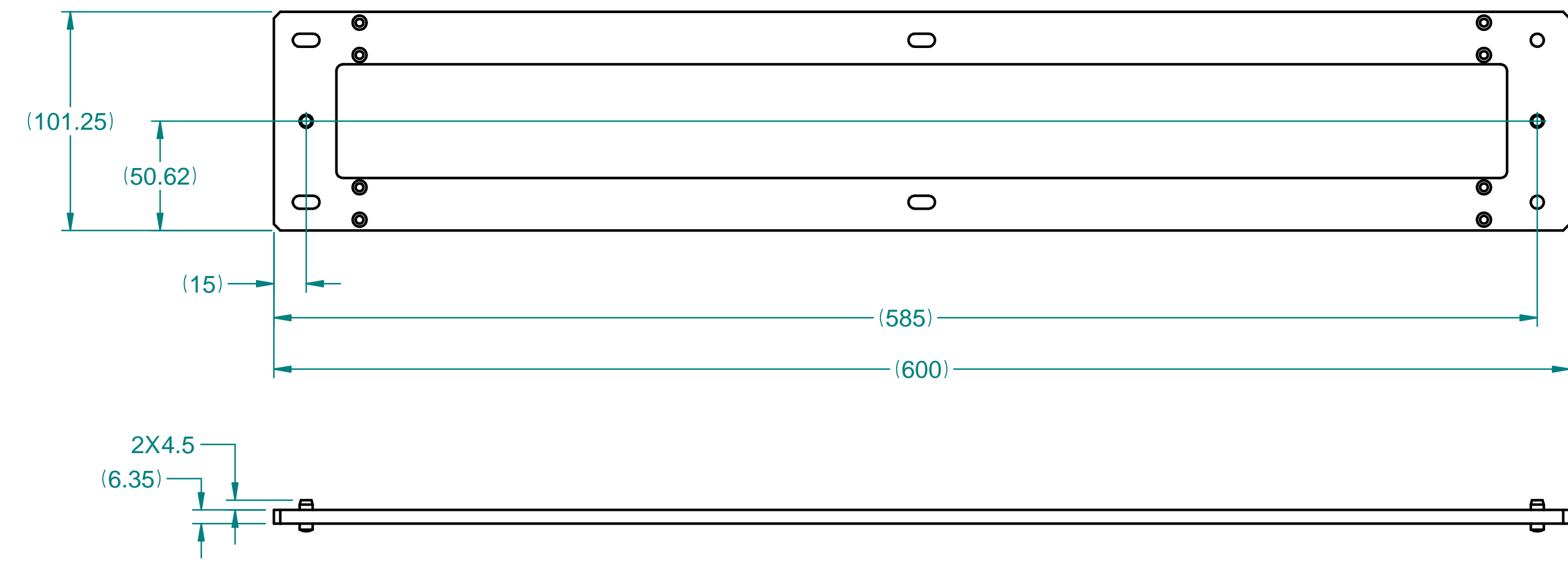
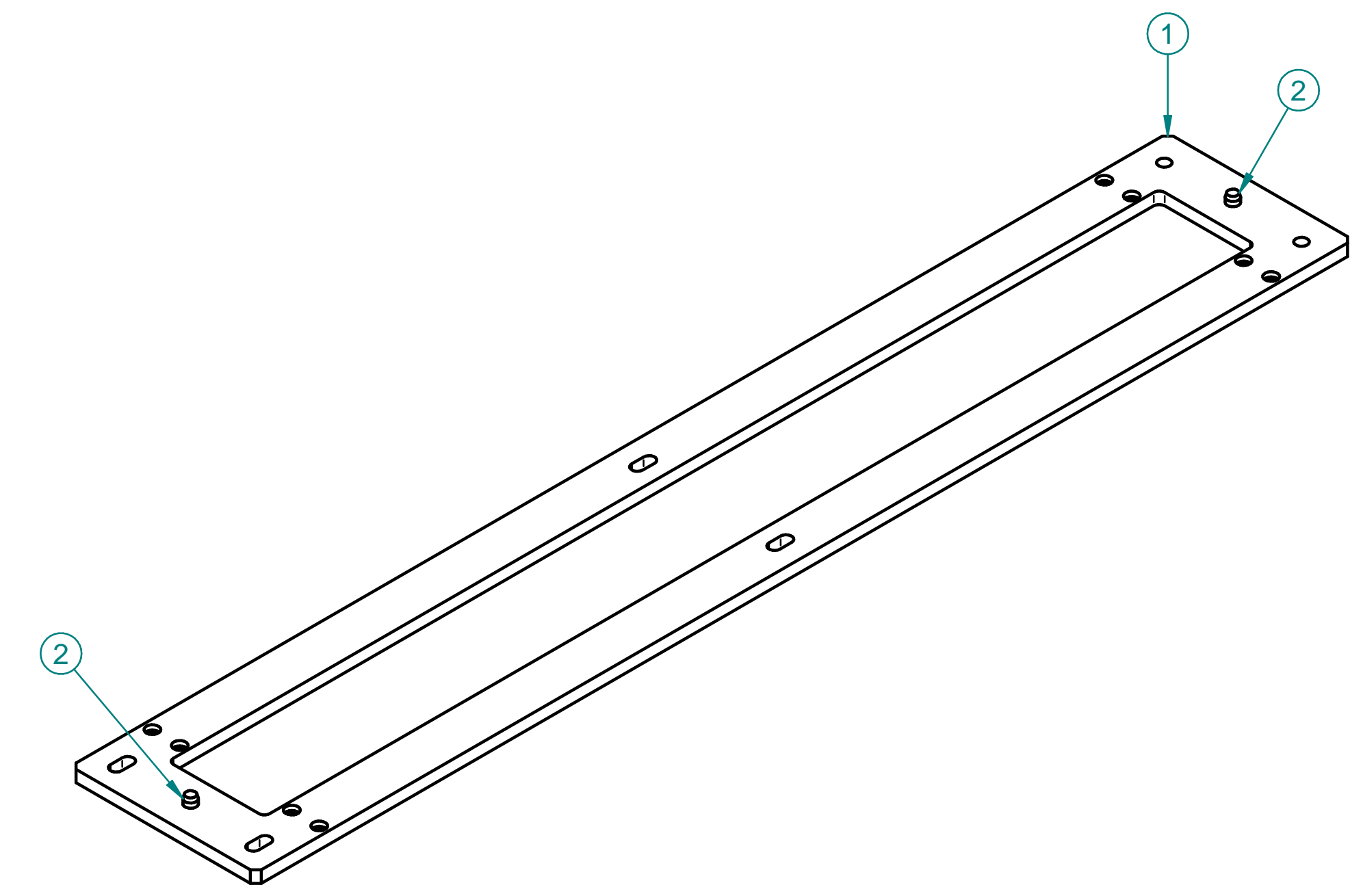

ITEM	PART NO	TITLE OR DESCRIPTION	MATERIAL	QTY
3		LOCTITE 422	ADHESIVE, 1 OZ.	1
2		MISUMI MSH6-12	SST	2
1	REF-000202292	HANDLING PLATE, LOADING, 19-1 OB STAVE	CARBON FIBER, 0/90DEG LAYUP	1

DIMENSIONING AND TOLERANCING IS IAW ASME Y14.5-2009		SCALE: 1:2 DO NOT SCALE DRAWING	ESTIMATED MASS: 0 kg	DWG TYPE: ASSY																
UNLESS OTHERWISE SPECIFIED DIMENSIONS ARE IN MILLIMETERS		ATLAS ITK CONTAINER, 19-1 OB STAVE HANDLING FRAME AND PINS																		
TOLERANCES: BREAK EDGES 0.13 - 0.4 INTERNAL CORNERS R 0.4 MAX ANGLE ± 1° ALL SURF 125		THE DRAWINGS, SPECIFICATIONS AND OTHER DATA HEREIN PROVIDED SHALL NOT BE COPIED, PUBLISHED OR OTHERWISE FURTHER DISSEMINATED WITHOUT PRIOR WRITTEN PERMISSION OF STANFORD UNIVERSITY/SLAC																		
REF-000202479	<table border="1"> <tr> <th>DIMENSIONS</th> <th>< 6</th> <th>> 6</th> <th>> 30</th> <th>> 120</th> <th>> 315</th> <th>> 1000</th> <th>> 2000</th> </tr> <tr> <td>GENERAL TOLERANCES</td> <td>± 0.1</td> <td>± 0.2</td> <td>± 0.3</td> <td>± 0.5</td> <td>± 0.8</td> <td>± 1.2</td> <td>± 2</td> </tr> </table>	DIMENSIONS	< 6	> 6	> 30	> 120	> 315	> 1000	> 2000	GENERAL TOLERANCES	± 0.1	± 0.2	± 0.3	± 0.5	± 0.8	± 1.2	± 2	ENGR S. NEWBRY DWN S. NEWBRY CHKR ---	DATE 20220212 APPROVALS --- --- ---	DRAWING NUMBER REF-000203572 REVISION NUMBER A
DIMENSIONS	< 6	> 6	> 30	> 120	> 315	> 1000	> 2000													
GENERAL TOLERANCES	± 0.1	± 0.2	± 0.3	± 0.5	± 0.8	± 1.2	± 2													
NEXT ASSEMBLIES:				D 1 OF 1 SH																

CHECK-PRINT
newbry
02-12-2022 03:47:11 PM

REV	DESCRIPTION	DWN	CHKR	APVD	DATE
1					

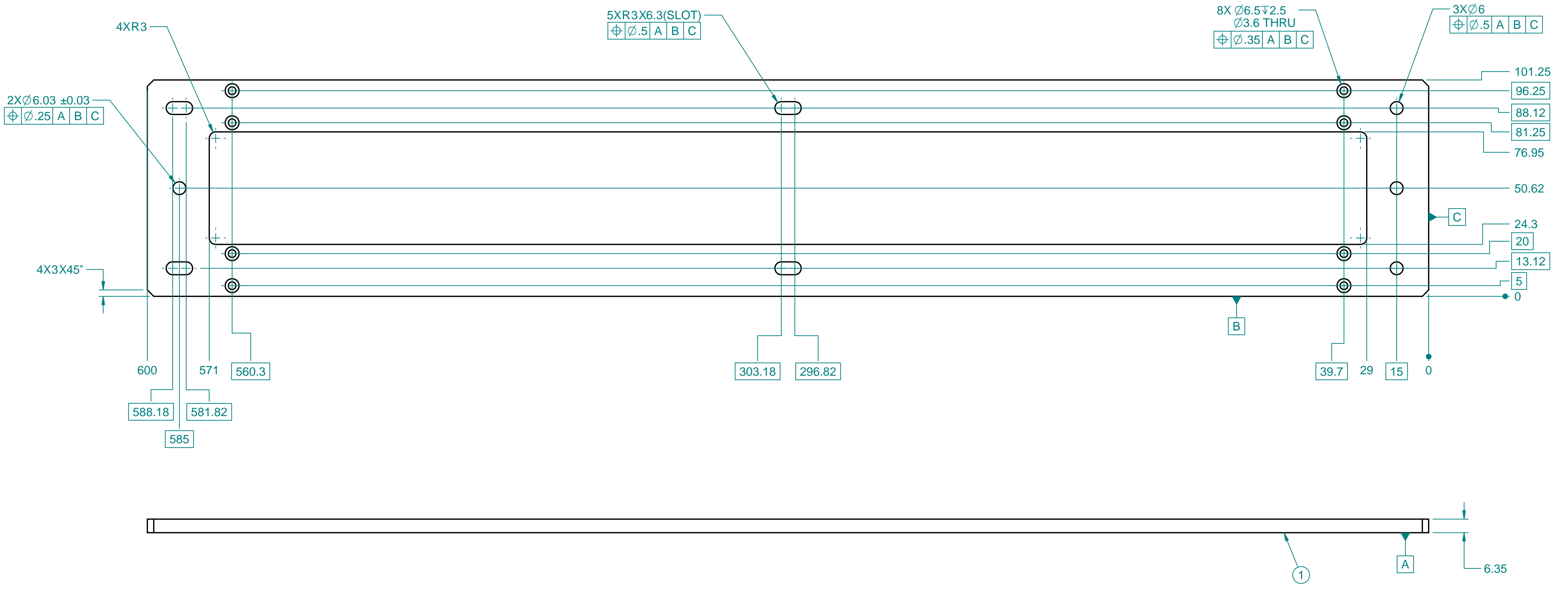

1	CARBON FIBER, 0/90DEG LAYUP
ITEM	MATERIAL

---	DIMENSIONING AND TOLERANCING IS IN ACCORDANCE WITH ASME Y14.5-2009																						
---	UNLESS OTHERWISE SPECIFIED DIMENSIONS ARE IN MILLIMETERS																						
---	TOLERANCES:																						
---	BREAK EDGES 0.13 - 0.4																						
---	INTERNAL CORNERS R 0.4 MAX																						
---	ANGLE ± 1° ALL SURF 125																						
REF-000203023	<table border="1"> <tr> <td>DIMENSIONS</td> <td>< 6</td> <td>> 6</td> <td>> 30</td> <td>> 120</td> <td>> 315</td> <td>> 1000</td> <td>> 2000</td> </tr> <tr> <td>GENERAL TOLERANCES</td> <td>± 0.1</td> <td>± 0.2</td> <td>± 0.3</td> <td>± 0.5</td> <td>± 0.8</td> <td>± 1.2</td> <td>± 2</td> </tr> </table>							DIMENSIONS	< 6	> 6	> 30	> 120	> 315	> 1000	> 2000	GENERAL TOLERANCES	± 0.1	± 0.2	± 0.3	± 0.5	± 0.8	± 1.2	± 2
DIMENSIONS	< 6	> 6	> 30	> 120	> 315	> 1000	> 2000																
GENERAL TOLERANCES	± 0.1	± 0.2	± 0.3	± 0.5	± 0.8	± 1.2	± 2																
NEXT ASSEMBLIES:																							

SCALE: 1:1
DO NOT SCALE DRAWING

SLAC
NATIONAL ACCELERATOR LABORATORY

U.S. DEPARTMENT OF ENERGY

THE DRAWINGS, SPECIFICATIONS AND OTHER DATA HEREIN PROVIDED SHALL NOT BE COPIED, PUBLISHED OR OTHERWISE FURTHER DISSEMINATED WITHOUT PRIOR WRITTEN PERMISSION OF STANFORD UNIVERSITY/SLAC

ENGR S. NEWBRY
DWN S. NEWBRY
CHKR ---

DATE 20220211

APPROVALS

ATLAS ITk
RD53a, 19-1 OB STAVE
HANDLING PLATE, LOADING

DWG TYPE: PART

ESTIMATED MASS: 0.39 kg

DRAWING NUMBER
REF-000202292

REVISION NUMBER
A

1 OF 1
SHEET

REF-000203021	1				
REV	DESCRIPTION	DWN	CHKR	APVD	DATE

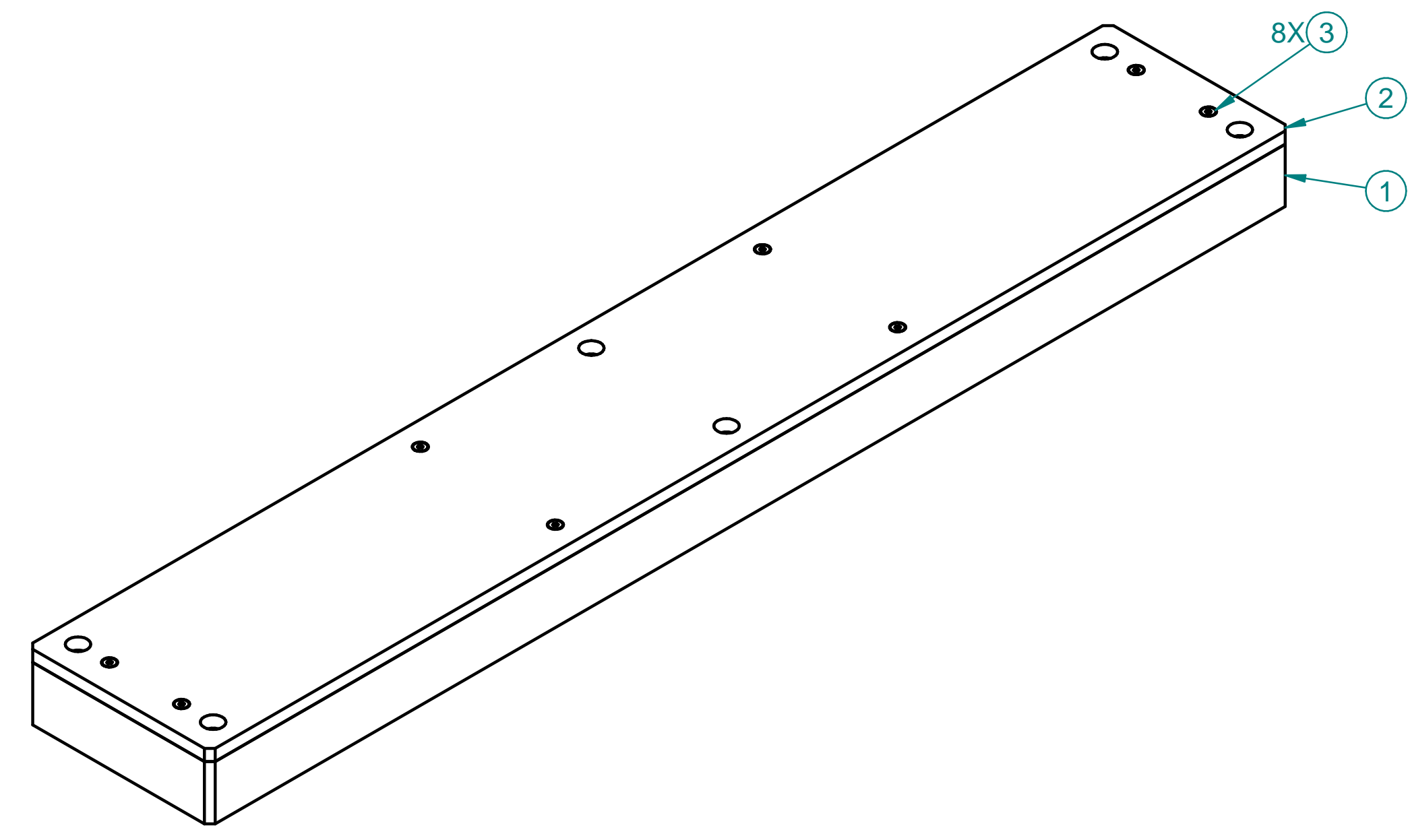

CHECK-PRINT
newbry
02-12-2022 04:44:21 PM

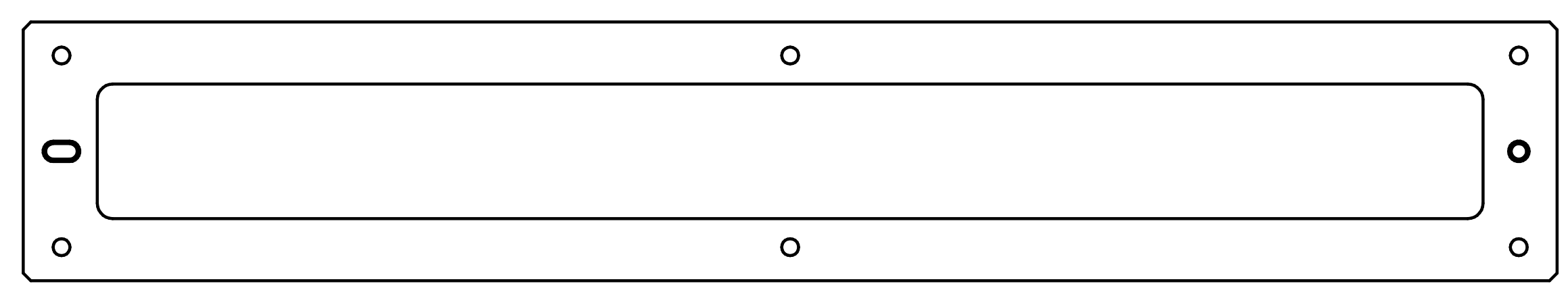
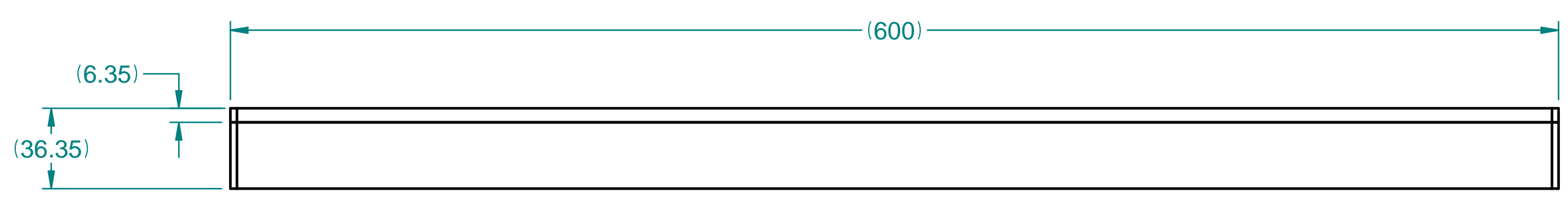
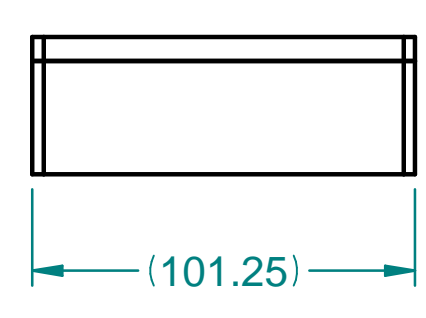

3	REF-000202478	FHCS, M3 X 0.5, 15mm LG, SST	8
2	REF-000202437	COVER PLATE, SHIPPING, 19-1 OB STAVE	1
1	REF-000202435	SPACER PLATE, SHIPPING, UPPER, 19-1 OB STAVE	1
ITEM	PART NO	TITLE OR DESCRIPTION	QTY

DIMENSIONING AND TOLERANCING IS IN ACCORDANCE WITH ASME Y14.5-2009		SCALE: 1:2 <small>DO NOT SCALE DRAWING</small>	ESTIMATED MASS: 1.501 kg	DWG TYPE: ASSY																								
UNLESS OTHERWISE SPECIFIED DIMENSIONS ARE IN MILLIMETERS TOLERANCES: BREAK EDGES 0.13 - 0.4 INTERNAL CORNERS R 0.4 MAX ANGLE ± 1° ALL SURF 125																												
REF-000202479		THE DRAWINGS, SPECIFICATIONS AND OTHER DATA HEREIN PROVIDED SHALL NOT BE COPIED, PUBLISHED OR OTHERWISE FURTHER DISSEMINATED WITHOUT PRIOR WRITTEN PERMISSION OF STANFORD UNIVERSITY/SLAC																										
NEXT ASSEMBLIES:		ENGR S. NEWBRY DWN S. NEWBRY CHKR ---	DATE 20220212	APPROVALS --- --- ---																								
<table border="1" style="font-size: small;"> <tr> <th>DIMENSIONS</th> <th>< 6</th> <th>> 6</th> <th>> 30</th> <th>> 120</th> <th>> 315</th> <th>> 1000</th> <th>> 2000</th> </tr> <tr> <th>GENERAL TOLERANCES</th> <td>± 0.1</td> <td>± 0.2</td> <td>± 0.3</td> <td>± 0.5</td> <td>± 0.8</td> <td>± 1.2</td> <td>± 2</td> </tr> </table>		DIMENSIONS	< 6	> 6	> 30	> 120	> 315	> 1000	> 2000	GENERAL TOLERANCES	± 0.1	± 0.2	± 0.3	± 0.5	± 0.8	± 1.2	± 2	<table border="1" style="font-size: small;"> <tr> <td colspan="2">DRAWING NUMBER</td> <td colspan="2">REVISION NUMBER</td> </tr> <tr> <td colspan="2" style="text-align: center;">REF-000203021</td> <td colspan="2" style="text-align: center;">A D</td> </tr> </table>			DRAWING NUMBER		REVISION NUMBER		REF-000203021		A D	
DIMENSIONS	< 6	> 6	> 30	> 120	> 315	> 1000	> 2000																					
GENERAL TOLERANCES	± 0.1	± 0.2	± 0.3	± 0.5	± 0.8	± 1.2	± 2																					
DRAWING NUMBER		REVISION NUMBER																										
REF-000203021		A D																										

REF-000203022	1				
REV	DESCRIPTION	DWN	CHKR	APVD	DATE

CHECK-PRINT
newbry
02-12-2022 04:39:31 PM

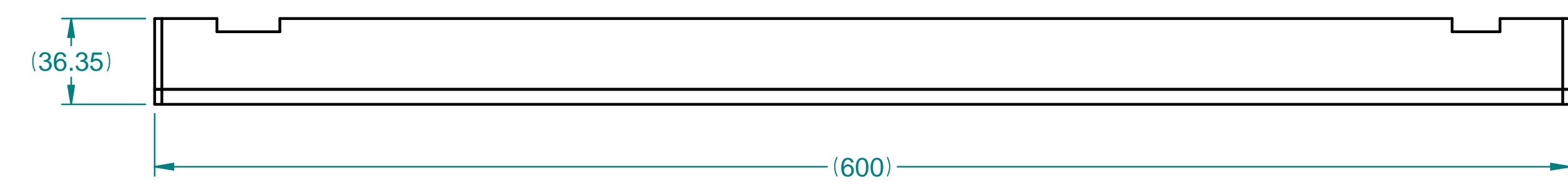
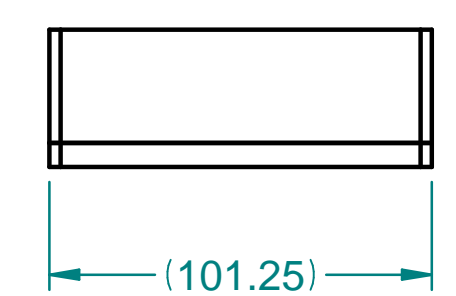
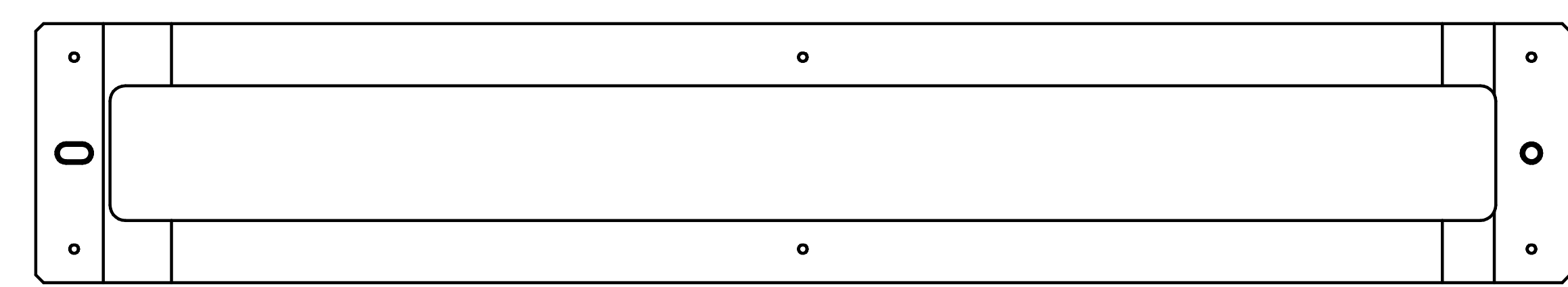
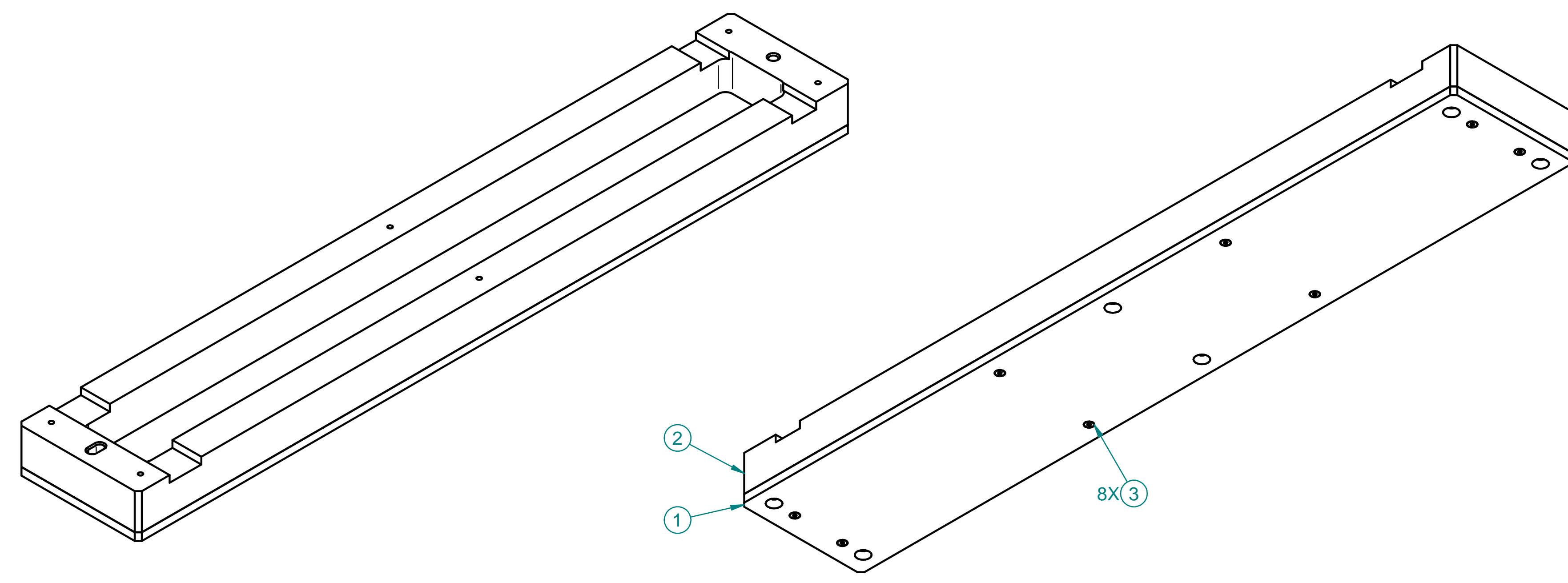

3	REF-000202478	FHCS, M3 X 0.5, 15mm LG, SST	8
2	REF-000202475	SPACER PLATE, LOWER, CONTAINER, 19-1 OB STAVE	1
1	REF-000202437	COVER PLATE, SHIPPING, 19-1 OB STAVE	1
ITEM	PART NO	TITLE OR DESCRIPTION	QTY

DIMENSIONING AND TOLERANCING IS IN ACCORDANCE WITH ASME Y14.5-2009		SCALE: 1:2 DO NOT SCALE DRAWING	ESTIMATED MASS: 1.491 kg	DWG TYPE: ASSY																
UNLESS OTHERWISE SPECIFIED DIMENSIONS ARE IN MILLIMETERS TOLERANCES: BREAK EDGES 0.13 - 0.4 INTERNAL CORNERS R 0.4 MAX ANGLE ± 1° ALL SURF 125																				
REF-000202479		THE DRAWINGS, SPECIFICATIONS AND OTHER DATA HEREIN PROVIDED SHALL NOT BE COPIED, PUBLISHED OR OTHERWISE FURTHER DISSEMINATED WITHOUT PRIOR WRITTEN PERMISSION OF STANFORD UNIVERSITY/SLAC																		
NEXT ASSEMBLIES:		ENGR S. NEWBRY DWN S. NEWBRY CHKR ---	DATE 20220212	APPROVALS --- --- ---																
<table border="1"> <tr> <td>DIMENSIONS</td> <td>< 6</td> <td>> 6</td> <td>> 30</td> <td>> 120</td> <td>> 315</td> <td>> 1000</td> <td>> 2000</td> </tr> <tr> <td>GENERAL TOLERANCES</td> <td>± 0.1</td> <td>± 0.2</td> <td>± 0.3</td> <td>± 0.5</td> <td>± 0.8</td> <td>± 1.2</td> <td>± 2</td> </tr> </table>		DIMENSIONS	< 6	> 6	> 30	> 120	> 315	> 1000	> 2000	GENERAL TOLERANCES	± 0.1	± 0.2	± 0.3	± 0.5	± 0.8	± 1.2	± 2	ATLAS ITk RD53a, 19-1 OB STAVE BOTTOM COVER, SHIPPING FIXTURE		
DIMENSIONS	< 6	> 6	> 30	> 120	> 315	> 1000	> 2000													
GENERAL TOLERANCES	± 0.1	± 0.2	± 0.3	± 0.5	± 0.8	± 1.2	± 2													
DRAWING NUMBER REF-000203022			REVISION NUMBER A	D																

REF-000202435	1
REV	DESCRIPTION
D	A

CHECK-PRINT
newbry
02-12-2022 04:25:50 PM

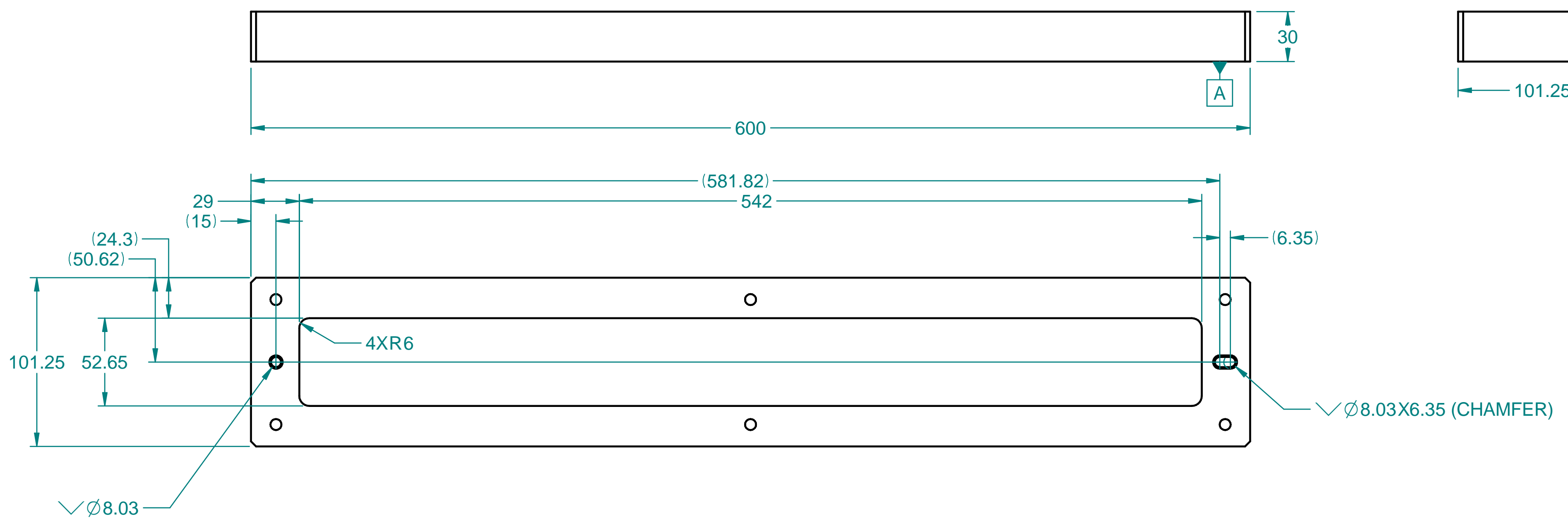
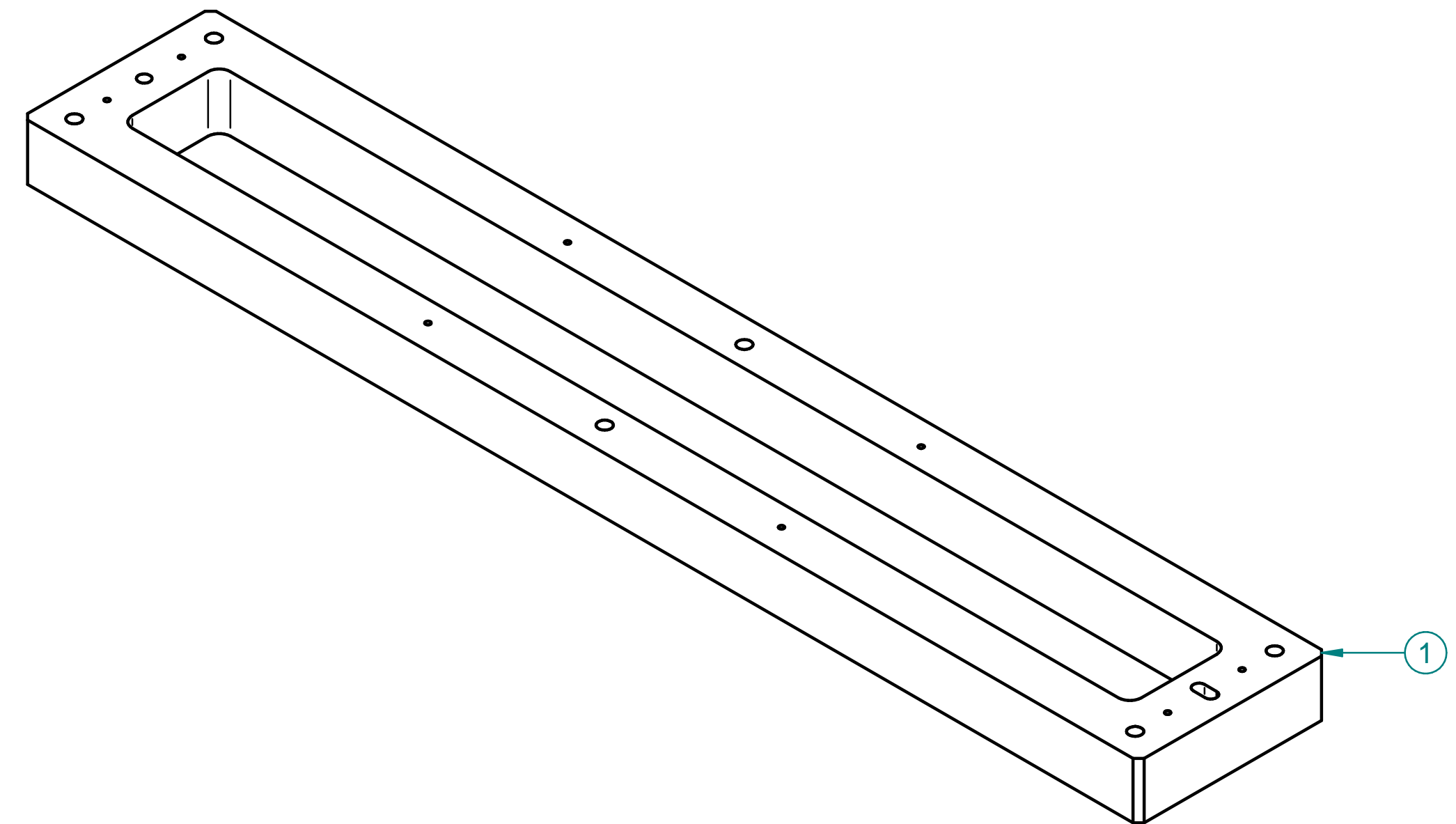
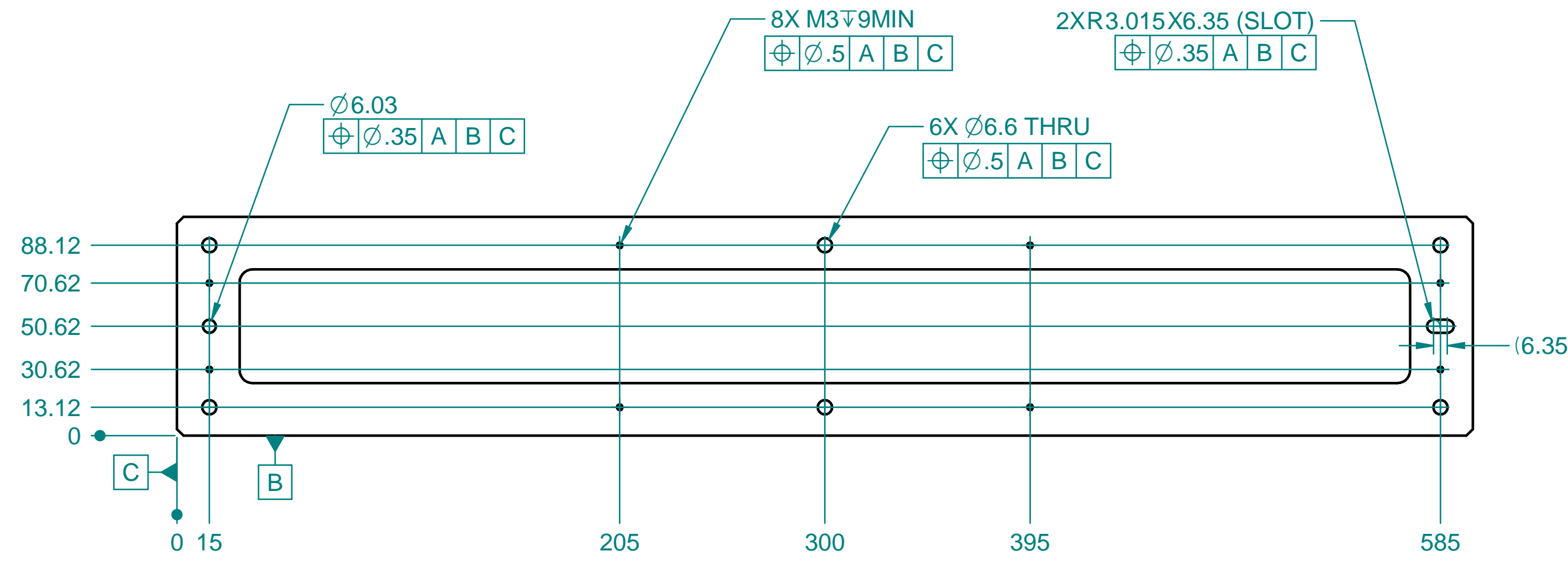

1	POLYETHYLENE, STATIC DISSIPATIVE
ITEM	MATERIAL

DIMENSIONING AND TOLERANCING IS IN ACCORDANCE WITH ASME Y14.5-2009 UNLESS OTHERWISE SPECIFIED DIMENSIONS ARE IN MILLIMETERS TOLERANCES: BREAK EDGES 0.13 - 0.4 INTERNAL CORNERS R 0.4 MAX ANGLE ± 1° ALL SURF 125 REF-000202479	SCALE: 1:2 DO NOT SCALE DRAWING	ESTIMATED MASS: 1.033 kg	DWG TYPE: PART																
			ATLAS ITk RD53a, 19-1 OB STAVE SPACER PLATE, SHIPPING, UPPER																
NEXT ASSEMBLIES:	THE DRAWINGS, SPECIFICATIONS AND OTHER DATA HEREIN PROVIDED SHALL NOT BE COPIED, PUBLISHED OR OTHERWISE FURTHER DISSEMINATED WITHOUT PRIOR WRITTEN PERMISSION OF STANFORD UNIVERSITY/SLAC	ENGR S. NEWBRY DWN S. NEWBRY CHKR ---	DATE 20220212 APPROVALS --- --- ---																
<table border="1"> <tr> <td>DIMENSIONS</td> <td>< 6</td> <td>> 6</td> <td>> 30</td> <td>> 120</td> <td>> 315</td> <td>> 1000</td> <td>> 2000</td> </tr> <tr> <td>GENERAL TOLERANCES</td> <td>± 0.1</td> <td>± 0.2</td> <td>± 0.3</td> <td>± 0.5</td> <td>± 0.8</td> <td>± 1.2</td> <td>± 2</td> </tr> </table>	DIMENSIONS	< 6	> 6	> 30	> 120	> 315	> 1000	> 2000	GENERAL TOLERANCES	± 0.1	± 0.2	± 0.3	± 0.5	± 0.8	± 1.2	± 2	DRAWING NUMBER REF-000202435	REVISION NUMBER A	D
DIMENSIONS	< 6	> 6	> 30	> 120	> 315	> 1000	> 2000												
GENERAL TOLERANCES	± 0.1	± 0.2	± 0.3	± 0.5	± 0.8	± 1.2	± 2												

CHECK-PRINT
newbry
02-12-2022 04:35:52 PM

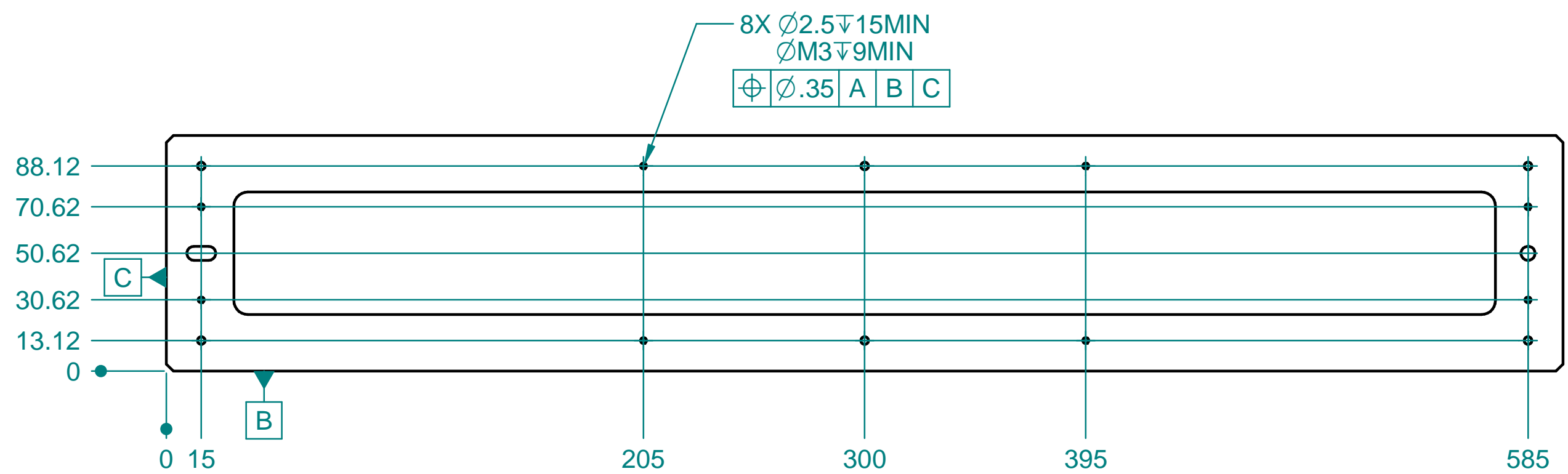
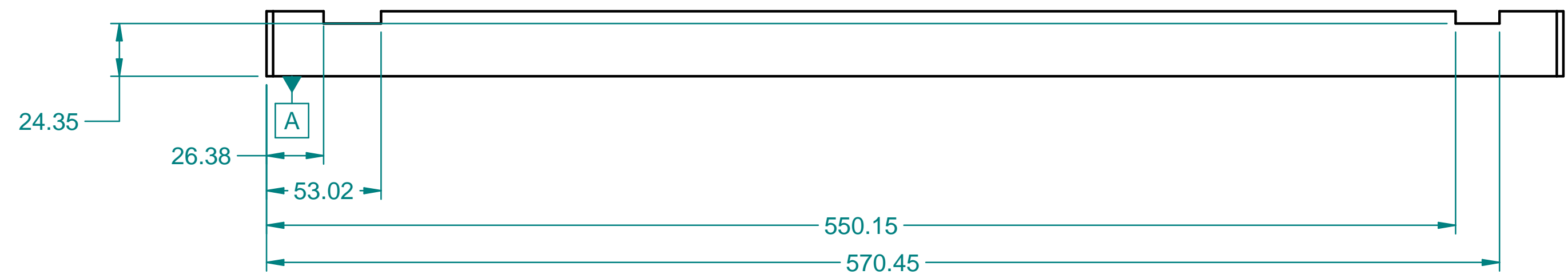
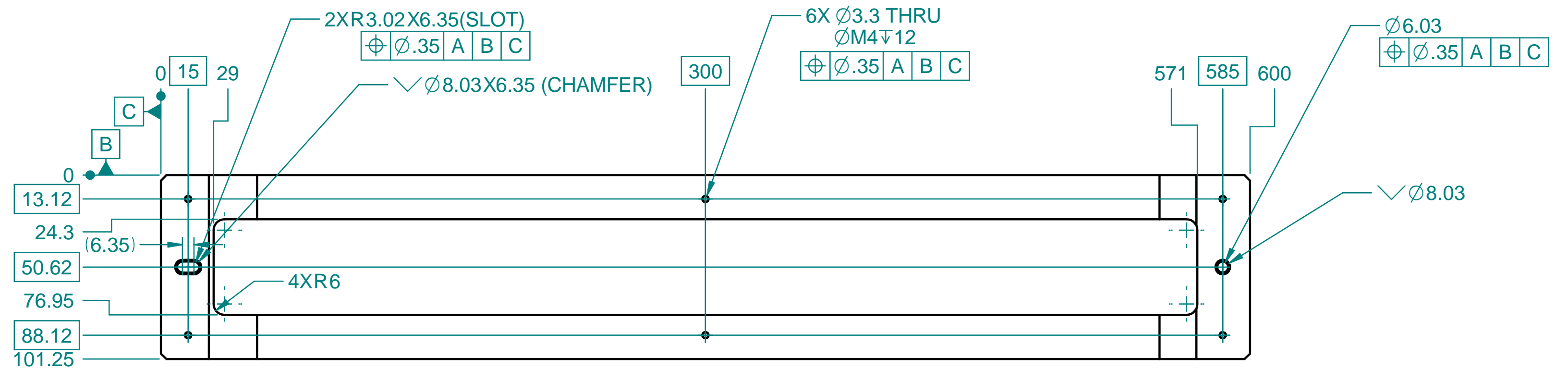
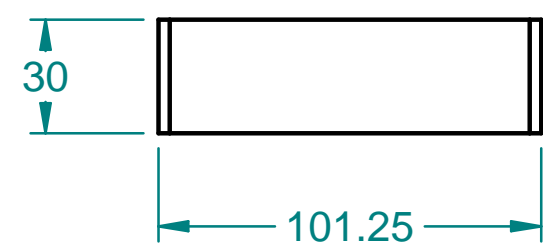
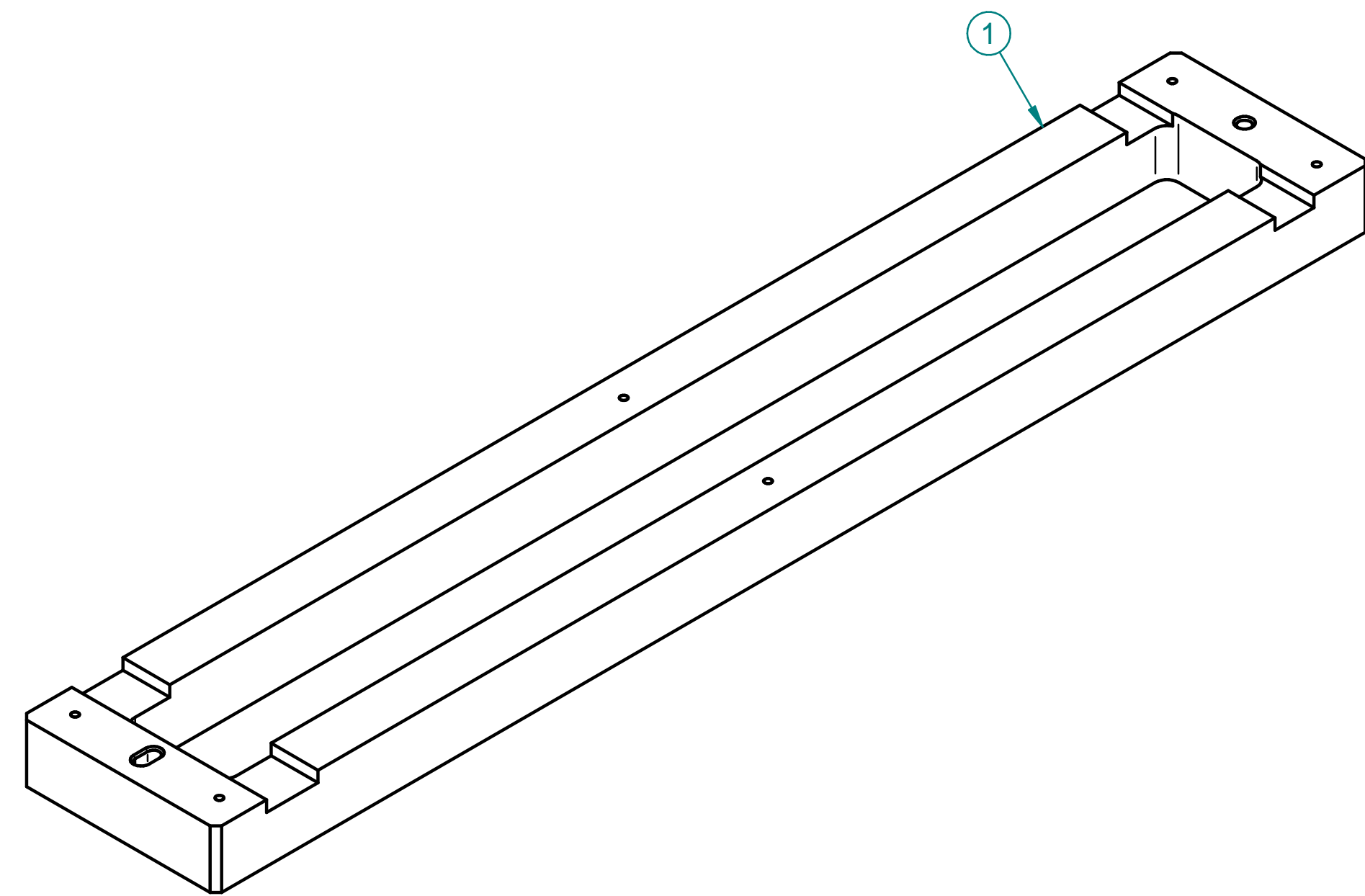

1	POLYETHYLENE, STATIC DISSIPATIVE	1
ITEM	MATERIAL	QTY

DIMENSIONING AND TOLERANCING IS IN ACCORDANCE WITH ASME Y14.5-2009		SCALE: 1:2 DO NOT SCALE DRAWING	ESTIMATED MASS: 1.023 kg	DWG TYPE: PART																		
UNLESS OTHERWISE SPECIFIED DIMENSIONS ARE IN MILLIMETERS		ATLAS ITK CONTAINER, 19-1 OB STAVE SPACER PLATE W/PINS, LOWER																				
TOLERANCES: BREAK EDGES 0.13 - 0.4 INTERNAL CORNERS R 0.4 MAX ANGLE ± 1° ALL SURF 125																						
REF-000202479	<table border="1"> <tr> <td>DIMENSIONS</td> <td>< 6</td> <td>> 6</td> <td>> 30</td> <td>> 120</td> <td>> 315</td> <td>> 1000</td> <td>> 2000</td> </tr> <tr> <td>GENERAL TOLERANCES</td> <td>± 0.1</td> <td>± 0.2</td> <td>± 0.3</td> <td>± 0.5</td> <td>± 0.8</td> <td>± 1.2</td> <td>± 2</td> </tr> </table>	DIMENSIONS	< 6	> 6	> 30	> 120	> 315	> 1000	> 2000	GENERAL TOLERANCES	± 0.1	± 0.2	± 0.3	± 0.5	± 0.8	± 1.2	± 2	ENGR S. NEWBRY DWN S. NEWBRY CHKR ---	DATE 20220212 APPROVALS --- --- ---	DRAWING NUMBER REF-000202475	REVISION NUMBER A	D
DIMENSIONS	< 6	> 6	> 30	> 120	> 315	> 1000	> 2000															
GENERAL TOLERANCES	± 0.1	± 0.2	± 0.3	± 0.5	± 0.8	± 1.2	± 2															

REF-000202437	DESCRIPTION	DWN	CHK	RAP	PVD	DATE
---------------	-------------	-----	-----	-----	-----	------

CHECK-PRINT
newbry
02-12-2022 05:11:47 PM

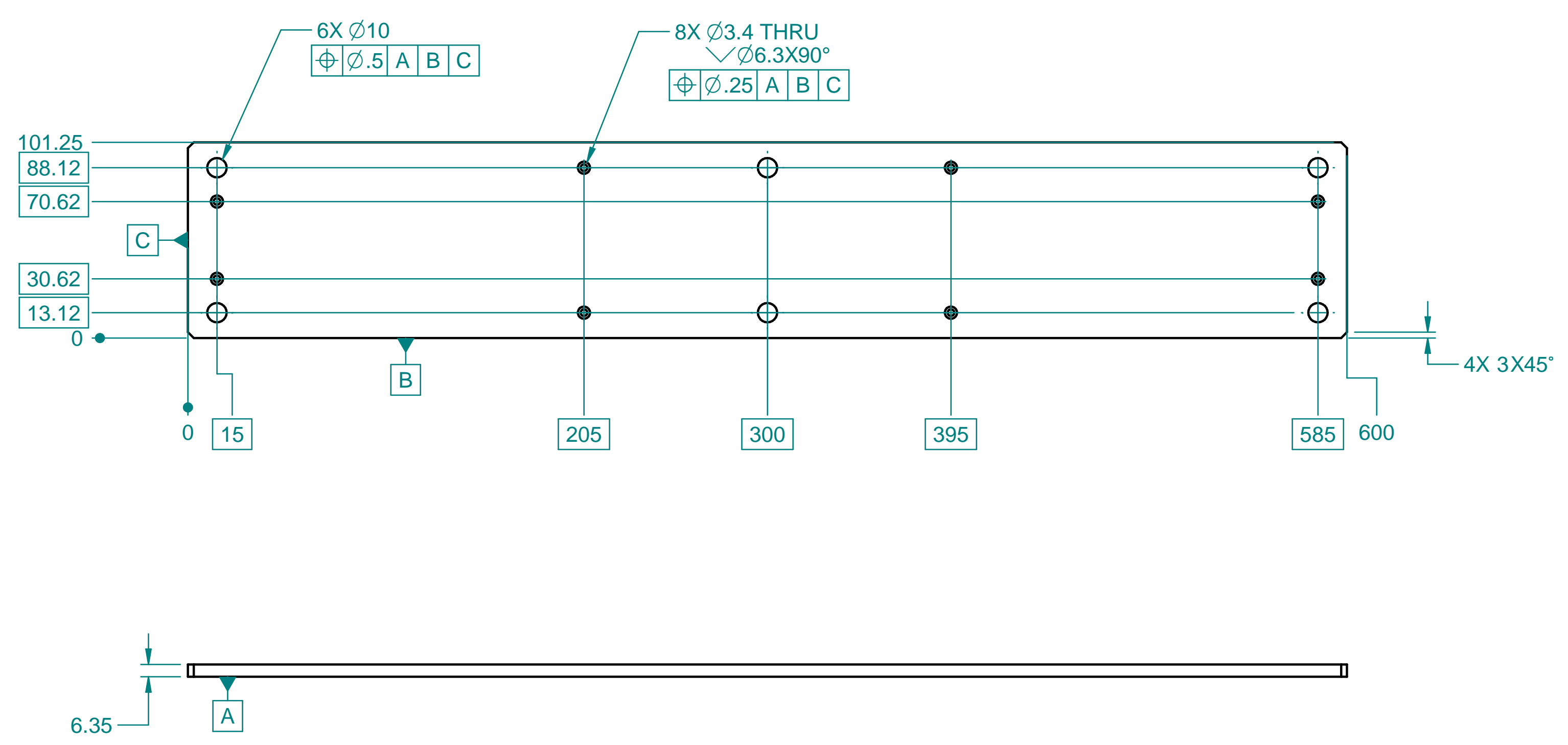
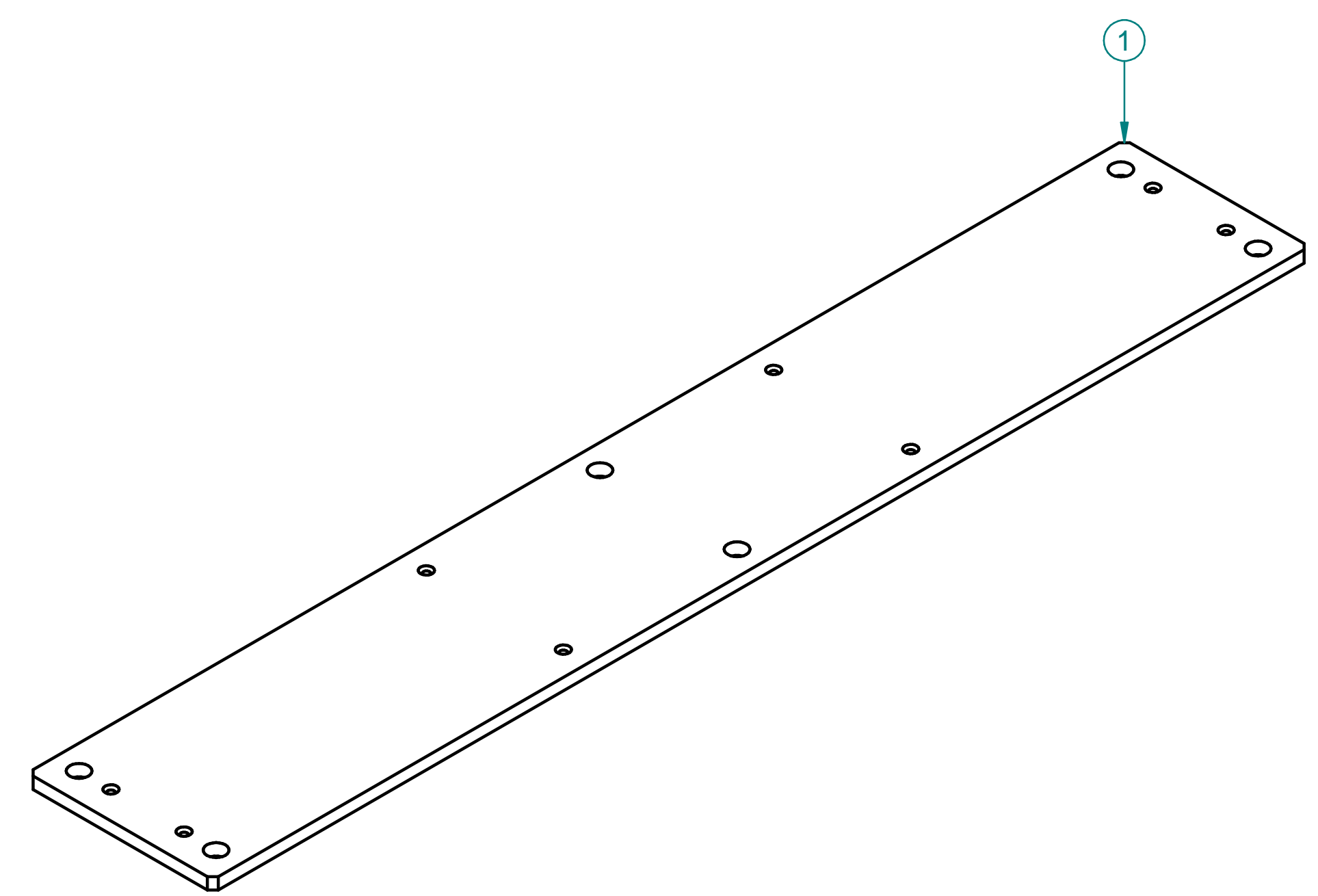

1	POLYCARBONATE, STATIC DISSIPATIVE, CLEAR	1
ITEM	MATERIAL	QTY

DIMENSIONING AND TOLERANCING IS IN ACCORDANCE WITH ASME Y14.5-2009		SCALE: 1:2 DO NOT SCALE DRAWING	ESTIMATED MASS: 0.462 kg	DWG TYPE: PART																
UNLESS OTHERWISE SPECIFIED DIMENSIONS ARE IN MILLIMETERS		 U.S. DEPARTMENT OF ENERGY NATIONAL ACCELERATOR LABORATORY	ATLAS ITK CONTAINER, 19-1 OB STAVE COVER PLATE, SHIPPING																	
TOLERANCES: BREAK EDGES 0.13 - 0.4 INTERNAL CORNERS R 0.4 MAX ANGLE ± 1° ALL SURF 125°																				
REF-000202479	<table border="1"> <tr> <td>DIMENSIONS</td> <td>< 6</td> <td>> 6</td> <td>> 30</td> <td>> 120</td> <td>> 315</td> <td>> 1000</td> <td>> 2000</td> </tr> <tr> <td>GENERAL TOLERANCES</td> <td>± 0.1</td> <td>± 0.2</td> <td>± 0.3</td> <td>± 0.5</td> <td>± 0.8</td> <td>± 1.2</td> <td>± 2</td> </tr> </table>	DIMENSIONS	< 6	> 6	> 30	> 120	> 315	> 1000	> 2000	GENERAL TOLERANCES	± 0.1	± 0.2	± 0.3	± 0.5	± 0.8	± 1.2	± 2	ENGR S. NEWBRY DWN S. NEWBRY CHKR ---	DATE 20220212	APPROVALS --- --- ---
DIMENSIONS	< 6	> 6	> 30	> 120	> 315	> 1000	> 2000													
GENERAL TOLERANCES	± 0.1	± 0.2	± 0.3	± 0.5	± 0.8	± 1.2	± 2													
NEXT ASSEMBLIES:		DRAWING NUMBER REF-000202437		REVISION NUMBER A D																