

NOTES UNLESS OTHERWISE SPECIFIED:

1. MATERIAL: SEE TABLE.
2. APPLY CHEMICAL CONVERSION COATING (ALODINE) MIL-DTL-5541 TYPE I, CLASS 1A, COLOR GOLD.
3. EMBOSS OR ENGRAVE PART AND REVISION NUMBER APPROX. WHERE SHOWN.
4. INSTALL TAPER PINS AS SHOWN. ALL DIMENSIONS APPLY AFTER PLATING AND PINS INSTALLED.

CHECK-PRINT
newbry
02-28-2022 02:20:49 PM

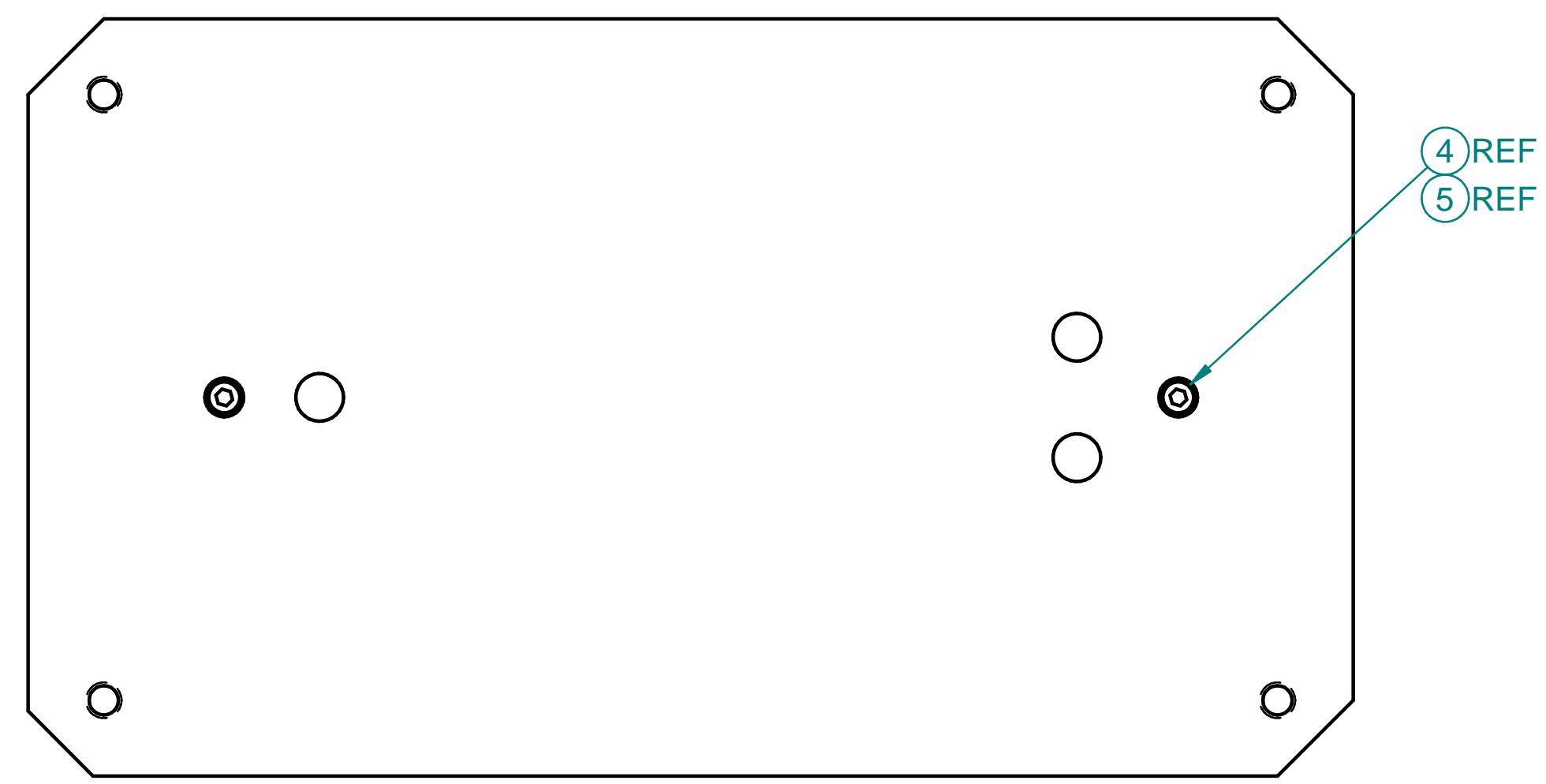
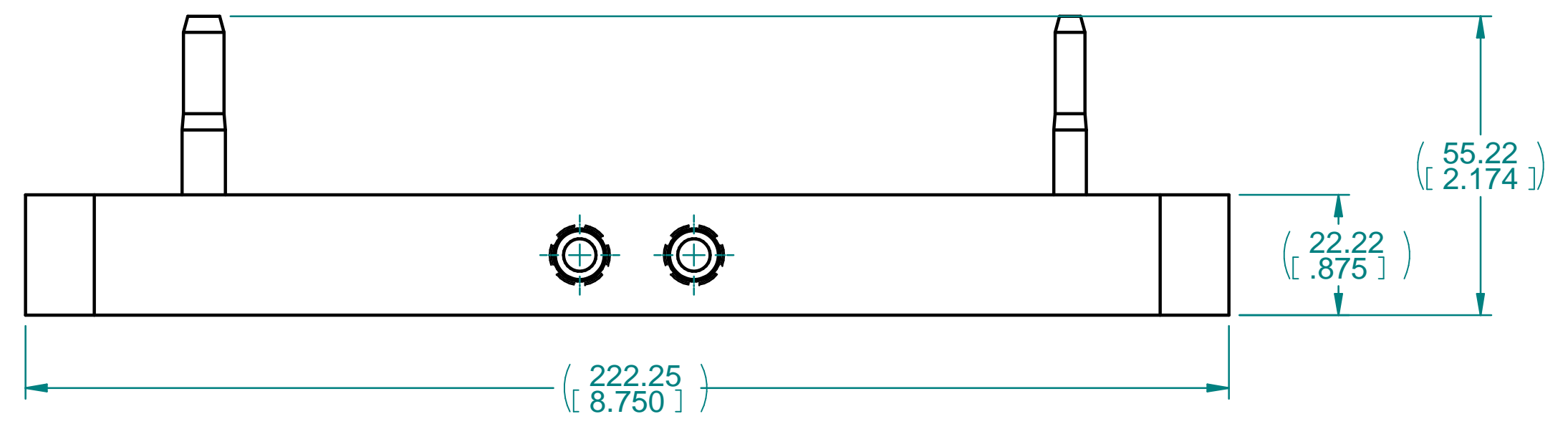
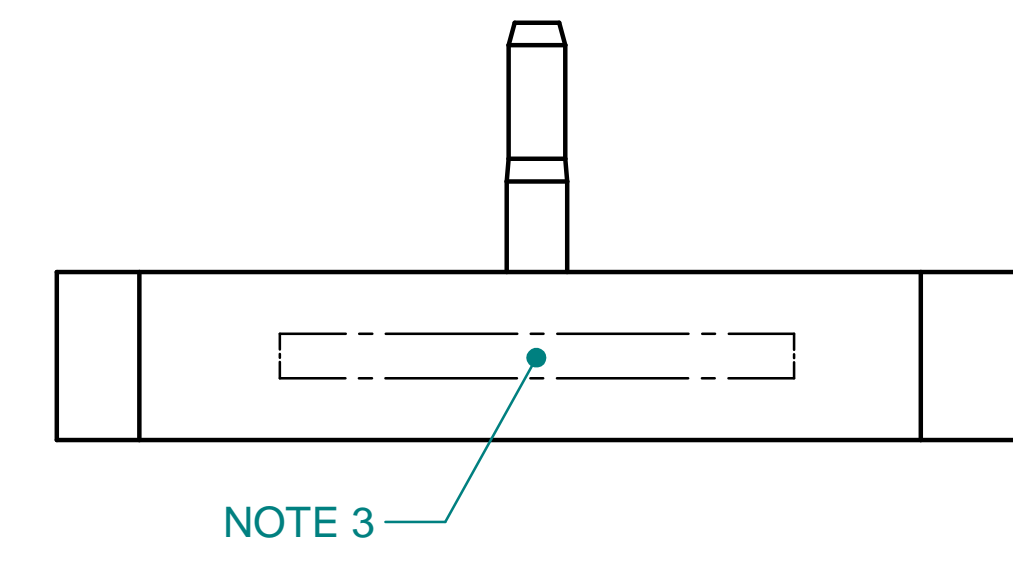
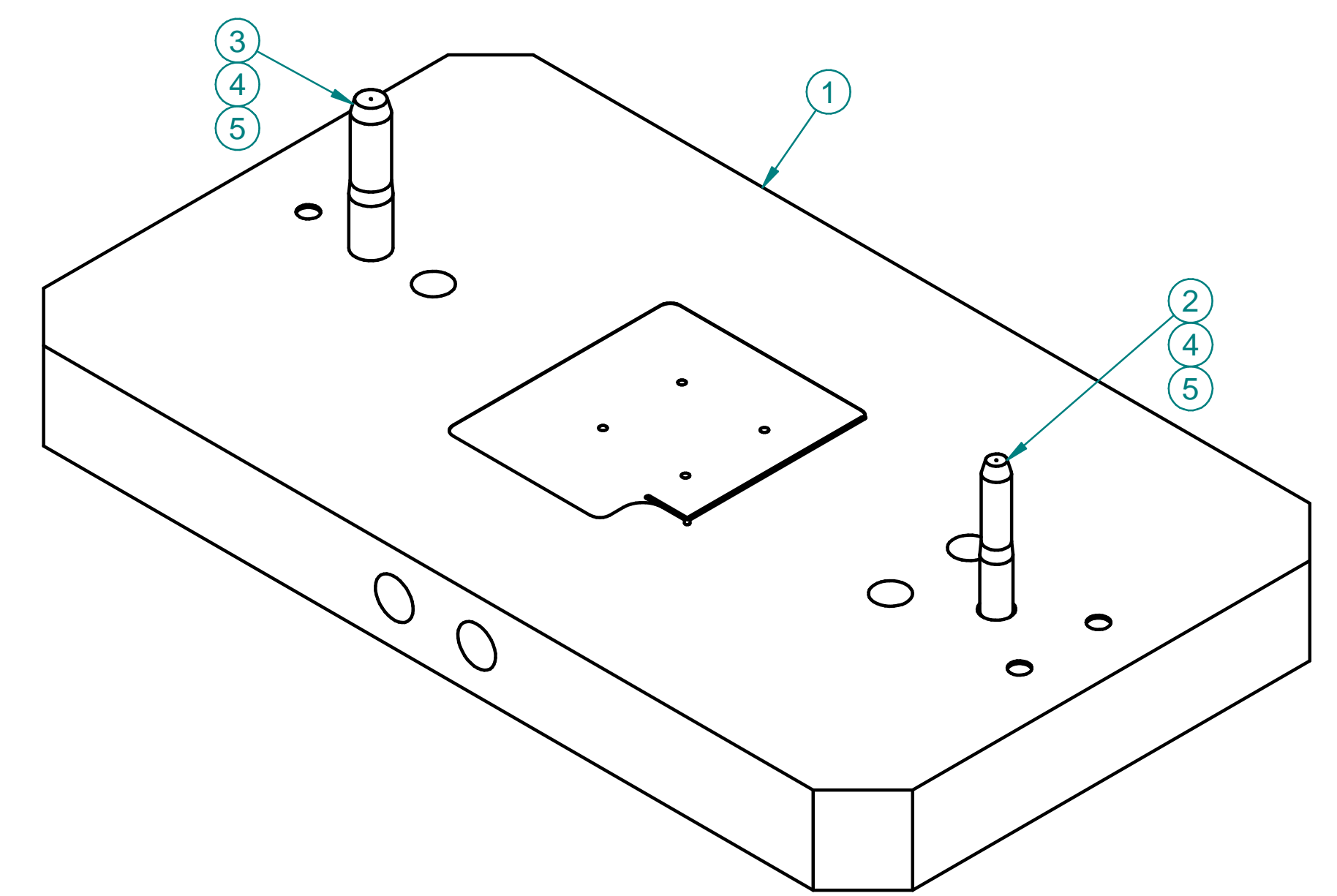
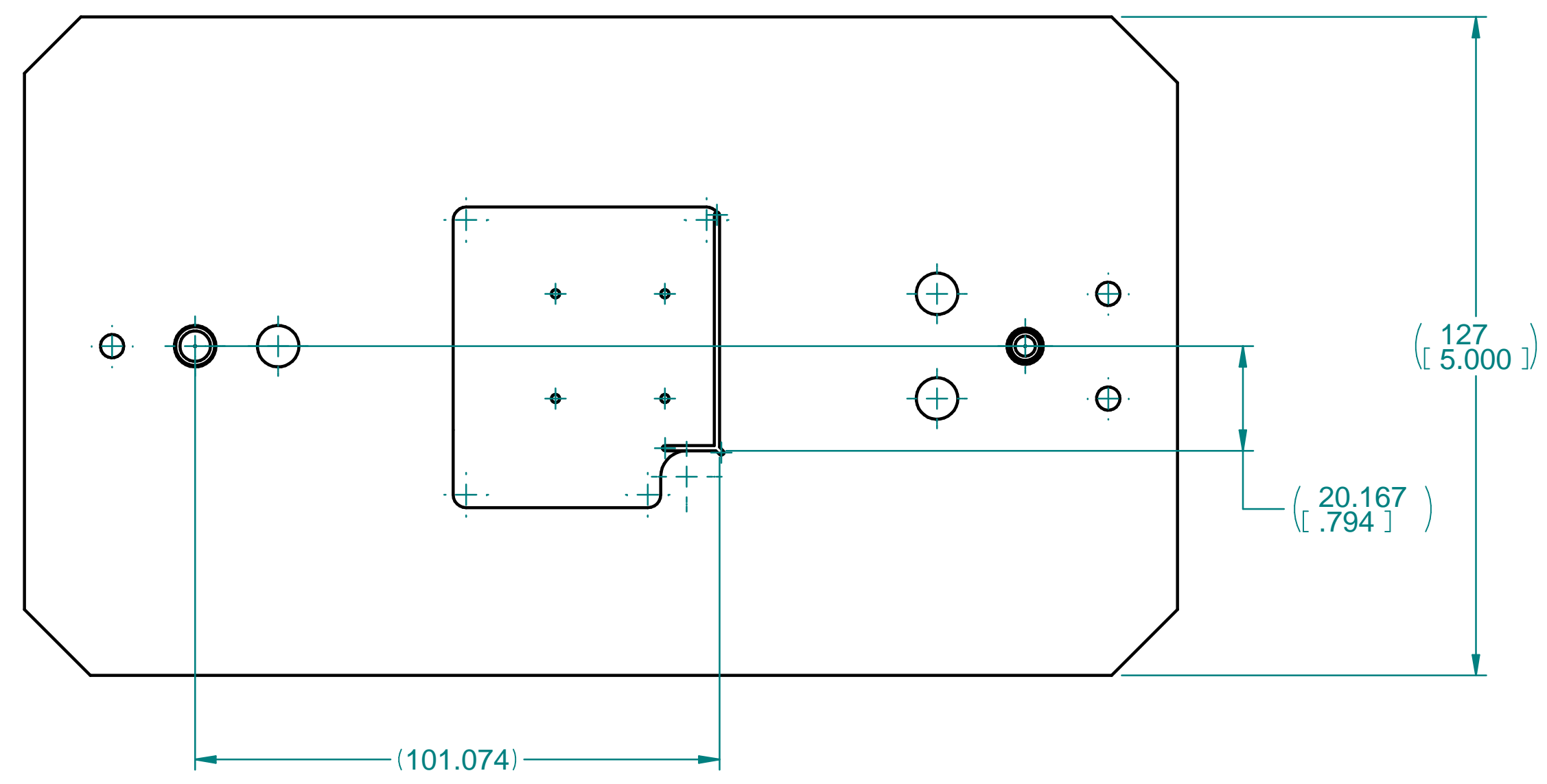

ITEM	NUMBER	DESCRIPTION	QTY
5		SCREW, CAP, SKT HD, M3X0.5 X 10mm, SST 316, COATED WS2	2
4		WASHER, FLAT, NAR, M3, SST	2
3	MISUMI HWPG6-P8.00-Q7.50-L11-B12.0-E3.0-F15.0	DOWEL PIN, STEPPED, 8 OD, H7 TOL., SST	1
2	MISUMI SWPG6-P6.00-Q5.50-L12-B12.0-E3.0-F15.0	DOWEL PIN, STEPPED, 6 OD, H7 TOL., SST	1
1		ALUMINUM TOOLING PLATE, ATP5 OR EQUIVALENT	1

DIMENSIONING AND TOLERANCING IS IN ACCORDANCE WITH ASME Y14.5-2009 UNLESS OTHERWISE SPECIFIED DIMENSIONS ARE IN MILLIMETERS TOLERANCES: BREAK EDGES 0.13 - 0.4 INTERNAL CORNERS R 0.4 MAX ANGLE ± 1° ALL SURF 0.8 		SCALE: 1:1 DO NOT SCALE DRAWING SLAC NATIONAL ACCELERATOR LABORATORY U.S. DEPARTMENT OF ENERGY THE DRAWINGS, SPECIFICATIONS AND OTHER DATA HEREIN PROVIDED SHALL NOT BE COPIED, PUBLISHED OR OTHERWISE FURTHER DISSEMINATED WITHOUT PRIOR WRITTEN PERMISSION OF STANFORD UNIVERSITY/SLAC	ESTIMATED MASS: 4.74 kg DWG TYPE: PART ATLAS INNER PIXEL MECH 19-1 OB STAVE LOADING PICK UP TABLE, RD53a QUAD																
REF-000203014 NEXT ASSEMBLIES:	<table border="1"> <tr> <th>DIMENSIONS</th> <th>< 6</th> <th>> 6</th> <th>> 30</th> <th>> 120</th> <th>> 315</th> <th>> 1000</th> <th>> 2000</th> </tr> <tr> <td>GENERAL TOLERANCES</td> <td>± 0.1</td> <td>± 0.2</td> <td>± 0.3</td> <td>± 0.5</td> <td>± 0.8</td> <td>± 1.2</td> <td>± 2</td> </tr> </table>	DIMENSIONS	< 6	> 6	> 30	> 120	> 315	> 1000	> 2000	GENERAL TOLERANCES	± 0.1	± 0.2	± 0.3	± 0.5	± 0.8	± 1.2	± 2	DATE: 20220228 ENGR: S. NEWBRY DWN: S. NEWBRY CHKR: ---	APPROVALS: --- DRAWING NUMBER: REF-000205158 REVISION NUMBER: A DATE: D
DIMENSIONS	< 6	> 6	> 30	> 120	> 315	> 1000	> 2000												
GENERAL TOLERANCES	± 0.1	± 0.2	± 0.3	± 0.5	± 0.8	± 1.2	± 2												

REF-000205158	REV	DESCRIPTION	DWN	CHK	RAP	PVD	DATE
---------------	-----	-------------	-----	-----	-----	-----	------

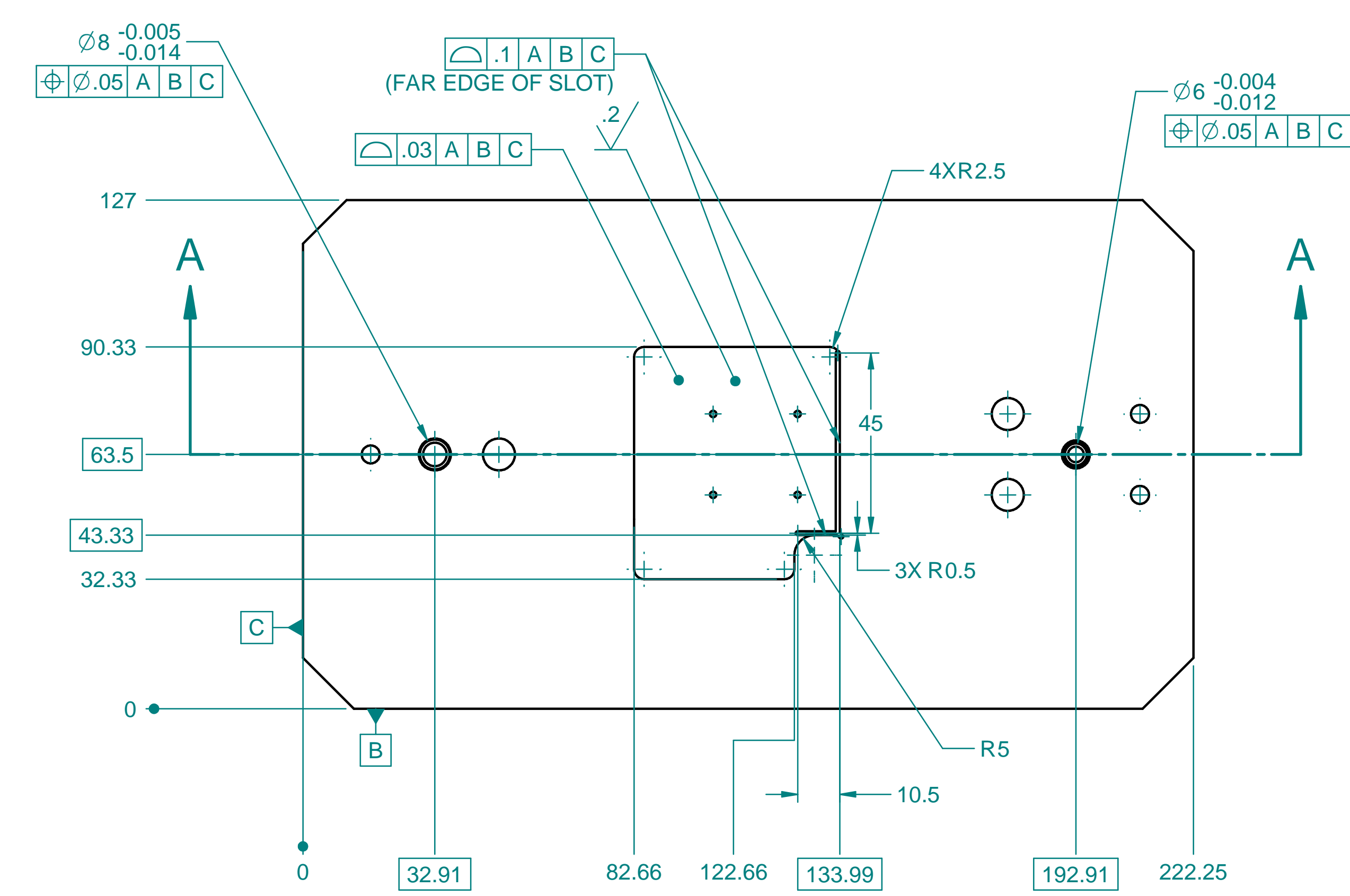
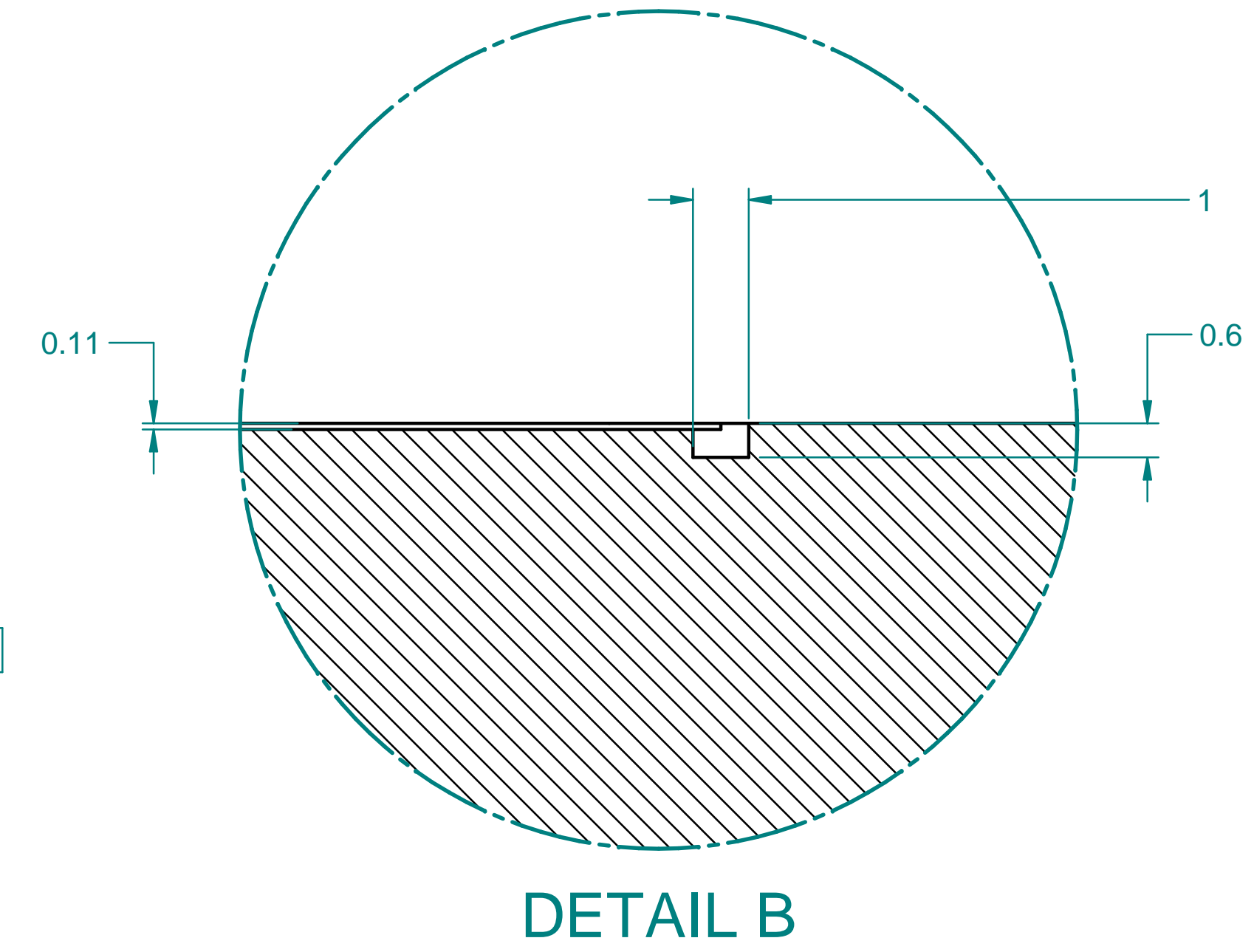
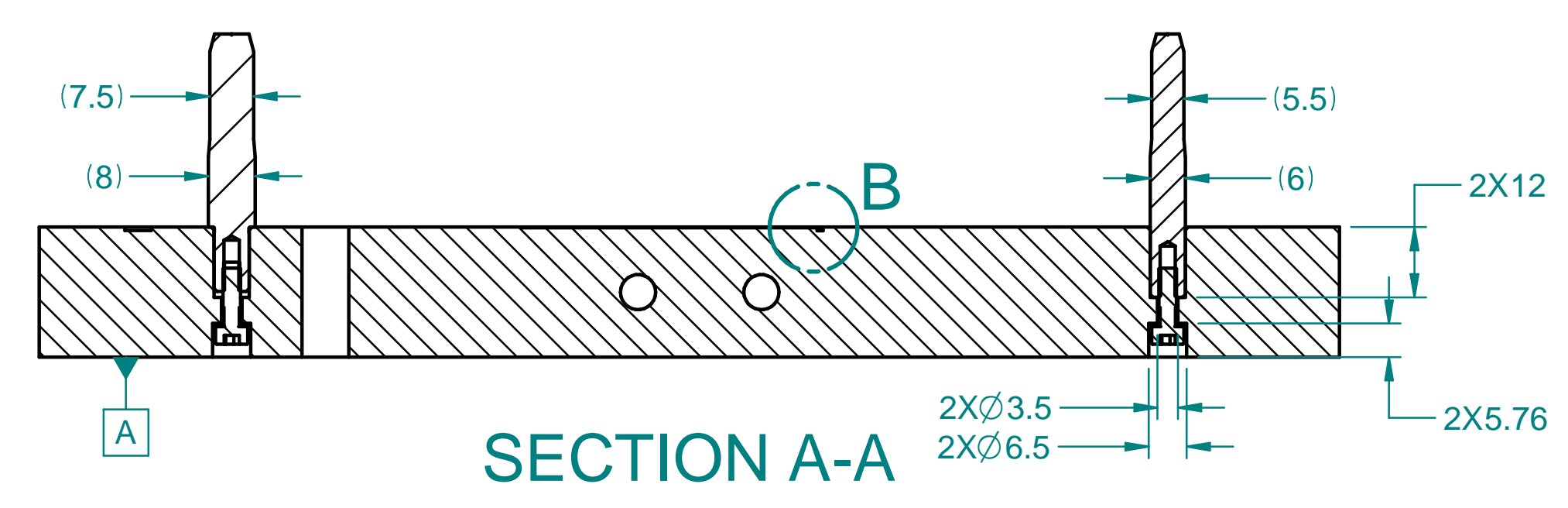

---	DIMENSIONING AND TOLERANCING IS IN ACCORDANCE WITH ASME Y14.5-2009		SCALE: 1:1 DO NOT SCALE DRAWING	ESTIMATED MASS: 4.74 kg	DWG TYPE: PART															
---	UNLESS OTHERWISE SPECIFIED DIMENSIONS ARE IN MILLIMETERS			ATLAS INNER PIXEL MECH 19-1 OB STAVE LOADING PICK UP TABLE, RD53a QUAD																
---	TOLERANCES: BREAK EDGES 0.13 - 0.4 INTERNAL CORNERS R 0.4 MAX ANGLE ± 1° ALL SURF 0.8			THE DRAWINGS, SPECIFICATIONS AND OTHER DATA HEREIN PROVIDED SHALL NOT BE COPIED, PUBLISHED OR OTHERWISE FURTHER DISSEMINATED WITHOUT PRIOR WRITTEN PERMISSION OF STANFORD UNIVERSITY/SLAC																
REF-000203014	NEXT ASSEMBLIES:		ENGR S. NEWBRY DWN S. NEWBRY CHKR ---	DATE 20220228 APPROVALS --- --- ---	DRAWING NUMBER REF-000205158 REVISION NUMBER A															
---	<table border="1"> <tr> <td>DIMENSIONS</td> <td>< 6</td> <td>> 6</td> <td>> 30</td> <td>> 120</td> <td>> 315</td> <td>> 1000</td> <td>> 2000</td> </tr> <tr> <td>GENERAL TOLERANCES</td> <td>± 0.1</td> <td>± 0.2</td> <td>± 0.3</td> <td>± 0.5</td> <td>± 0.8</td> <td>± 1.2</td> <td>± 2</td> </tr> </table>		DIMENSIONS	< 6	> 6	> 30	> 120	> 315	> 1000	> 2000	GENERAL TOLERANCES	± 0.1	± 0.2	± 0.3	± 0.5	± 0.8	± 1.2	± 2	DRAWING NUMBER REF-000205158 REVISION NUMBER A	
DIMENSIONS	< 6	> 6	> 30	> 120	> 315	> 1000	> 2000													
GENERAL TOLERANCES	± 0.1	± 0.2	± 0.3	± 0.5	± 0.8	± 1.2	± 2													
---	---		CAD FILE NAME: REF-000205158.dft		SHEET 2 OF 3															

D	A	REF-000205158	1		
REV	DESCRIPTION	DWN	CHKR	PVD	DATE

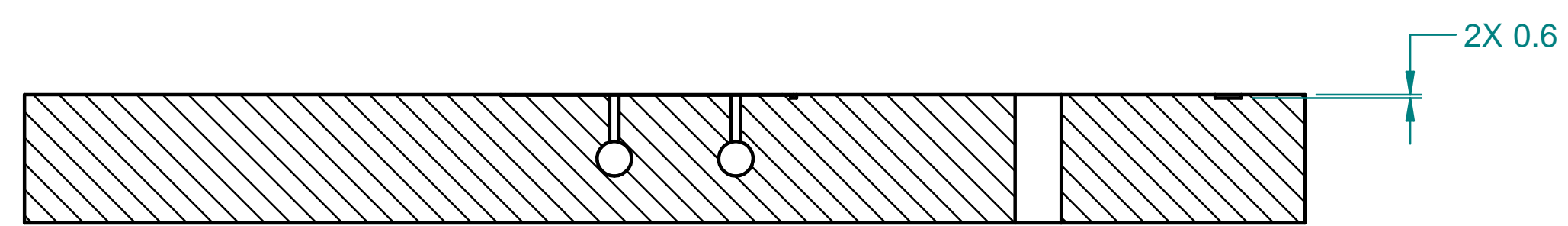

SECTION C-C

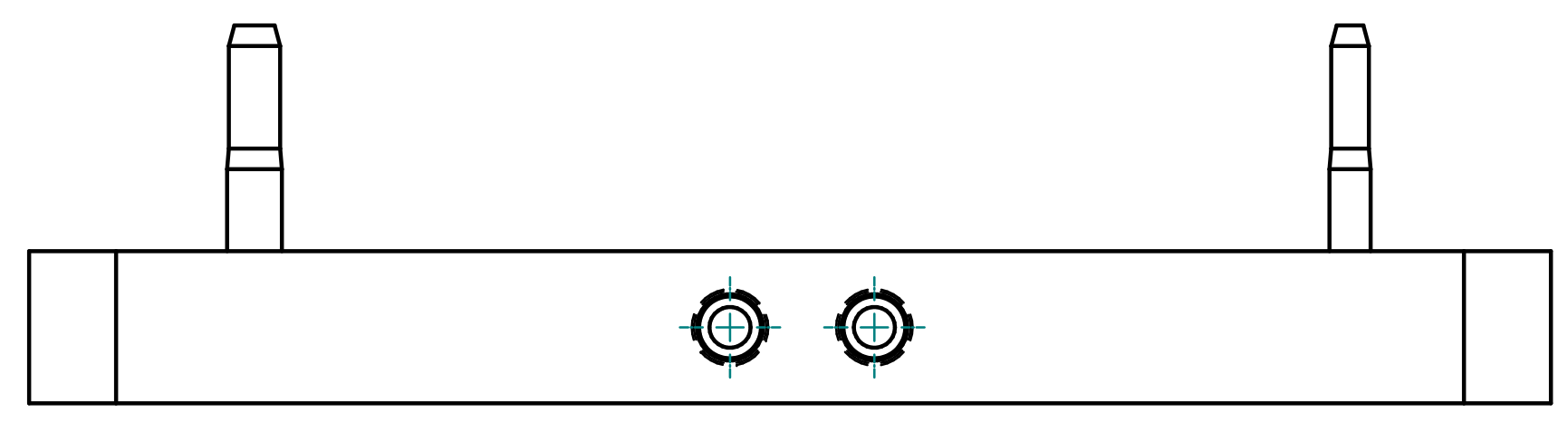
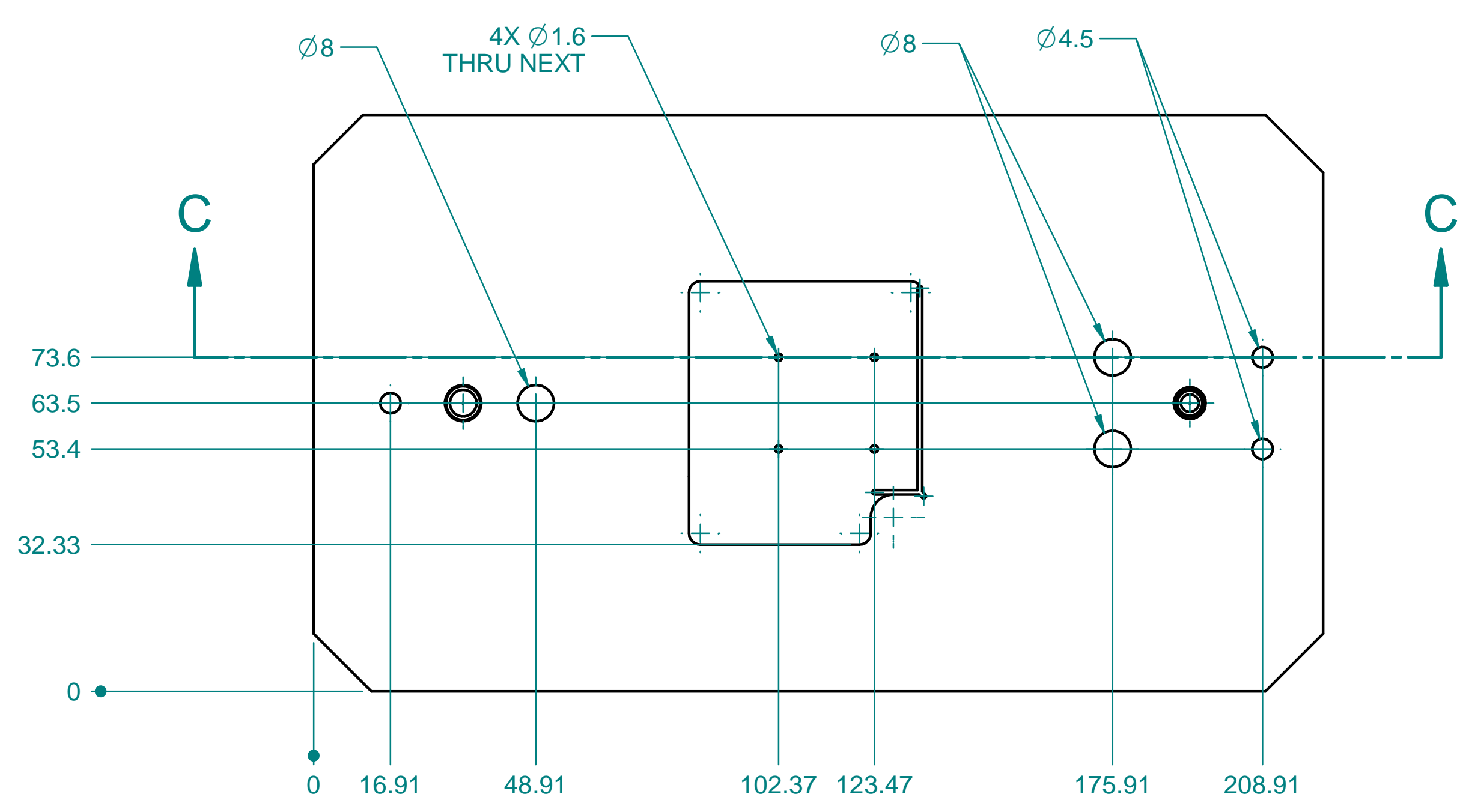

---	DIMENSIONING AND TOLERANCING IS IN ACCORDANCE WITH ASME Y14.5-2009		SCALE: 1:1 DO NOT SCALE DRAWING	ESTIMATED MASS: 4.74 kg	DWG TYPE: PART														
---	UNLESS OTHERWISE SPECIFIED DIMENSIONS ARE IN MILLIMETERS			ATLAS INNER PIXEL MECH 19-1 OB STAVE LOADING PICK UP TABLE, RD53a QUAD															
---	TOLERANCES: BREAK EDGES 0.13 - 0.4 INTERNAL CORNERS R 0.4 MAX ANGLE ± 1° ALL SURF 0.8			THE DRAWINGS, SPECIFICATIONS AND OTHER DATA HEREIN PROVIDED SHALL NOT BE COPIED, PUBLISHED OR OTHERWISE FURTHER DISSEMINATED WITHOUT PRIOR WRITTEN PERMISSION OF STANFORD UNIVERSITY/SLAC															
REF-000203014	NEXT ASSEMBLIES:		ENGR S. NEWBRY DWN S. NEWBRY CHKR ---	DATE 20220228 APPROVALS --- --- ---	DRAWING NUMBER REF-000205158 REVISION NUMBER A D														
	DIMENSIONS	GENERAL TOLERANCES	<table border="1"> <tr> <td>< 6</td> <td>> 6</td> <td>> 30</td> <td>> 120</td> <td>> 315</td> <td>> 1000</td> <td>> 2000</td> </tr> <tr> <td>± 0.1</td> <td>± 0.2</td> <td>± 0.3</td> <td>± 0.5</td> <td>± 0.8</td> <td>± 1.2</td> <td>± 2</td> </tr> </table>	< 6	> 6	> 30	> 120	> 315	> 1000	> 2000	± 0.1	± 0.2	± 0.3	± 0.5	± 0.8	± 1.2	± 2	CAD FILE NAME: REF-000205158.dft	
< 6	> 6	> 30	> 120	> 315	> 1000	> 2000													
± 0.1	± 0.2	± 0.3	± 0.5	± 0.8	± 1.2	± 2													