

NOTES UNLESS OTHERWISE SPECIFIED:

1. MATERIAL: SEE TABLE. DO NOT SUBSTITUTE.
2. EMBOSS OR ENGRAVE PART AND REVISION NUMBER APPROX. WHERE SHOWN.
3. ALL DIMENSIONS APPLY IN A FREE STATE CONDITION.
4. DEGREASE WITH ALCOHOL AND CUSHION TO PROTECT FROM HANDLING DAMAGE.

**CHECK-PRINT**  
newbry  
02-24-2022 07:44:00 AM

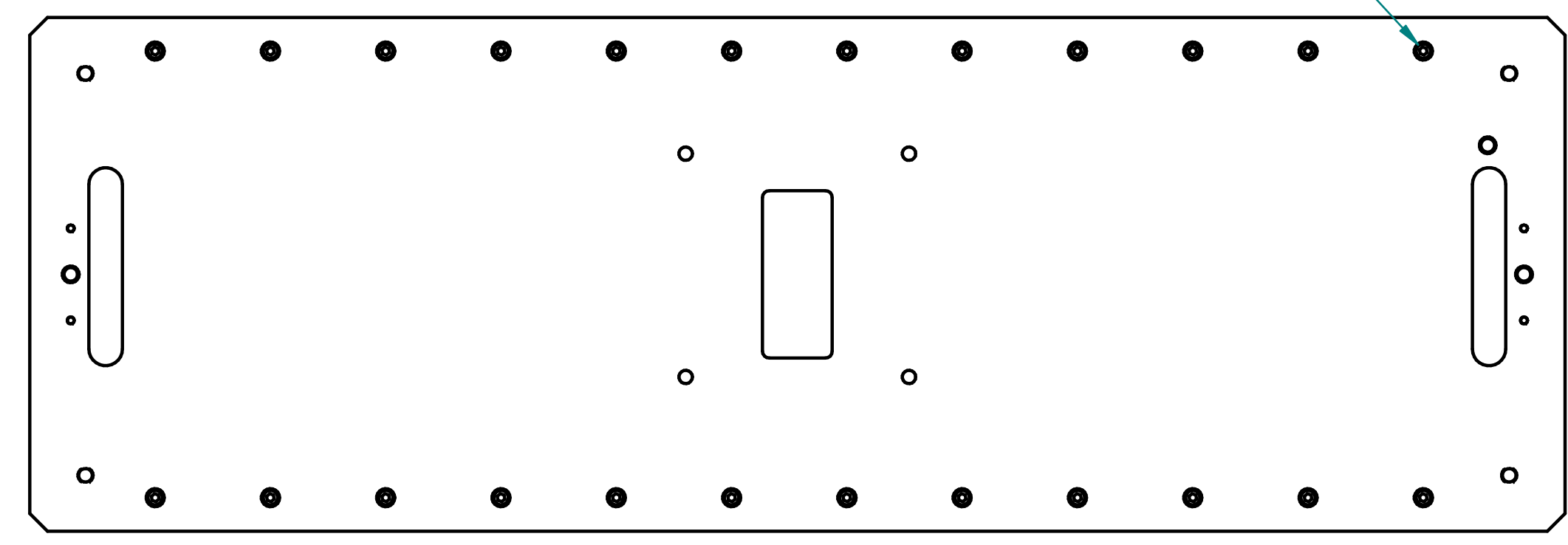
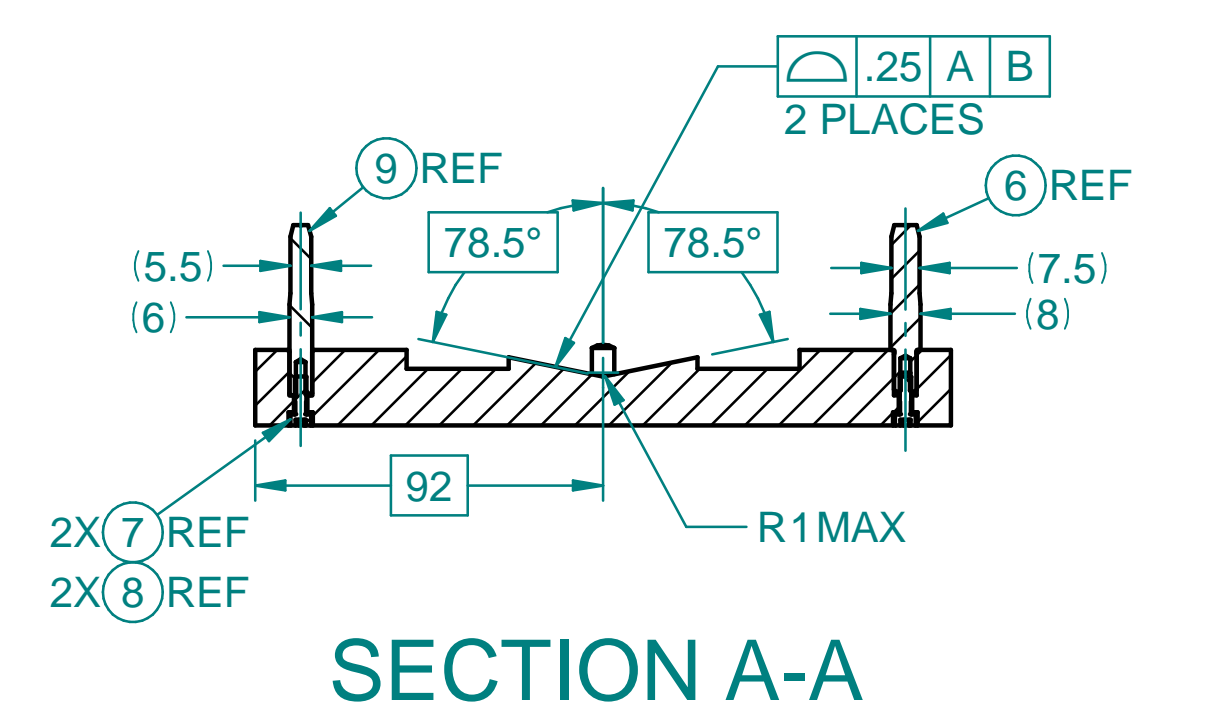
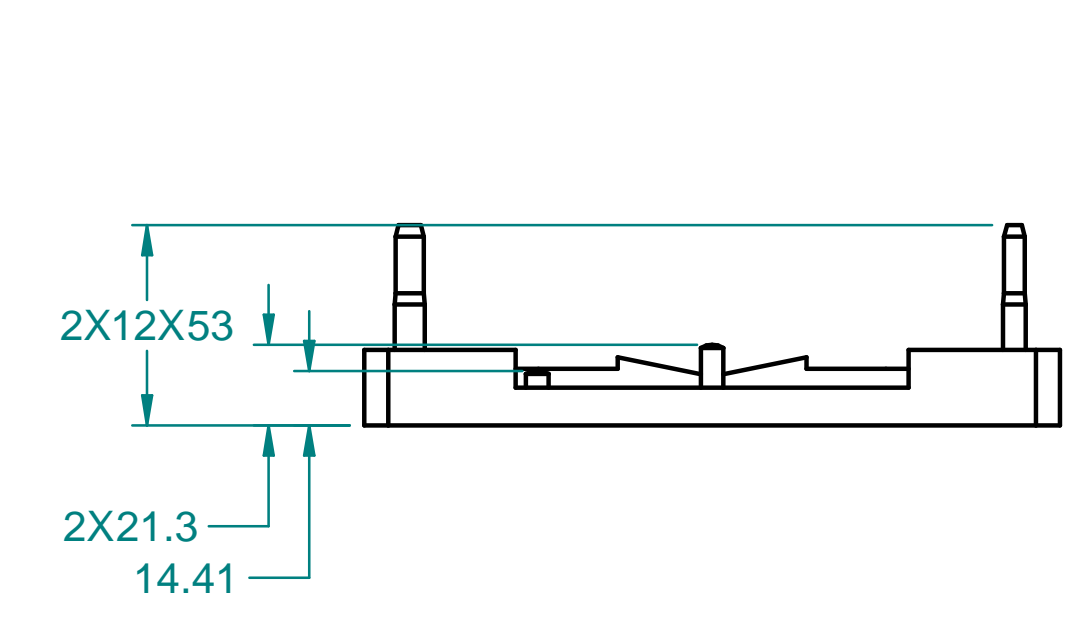
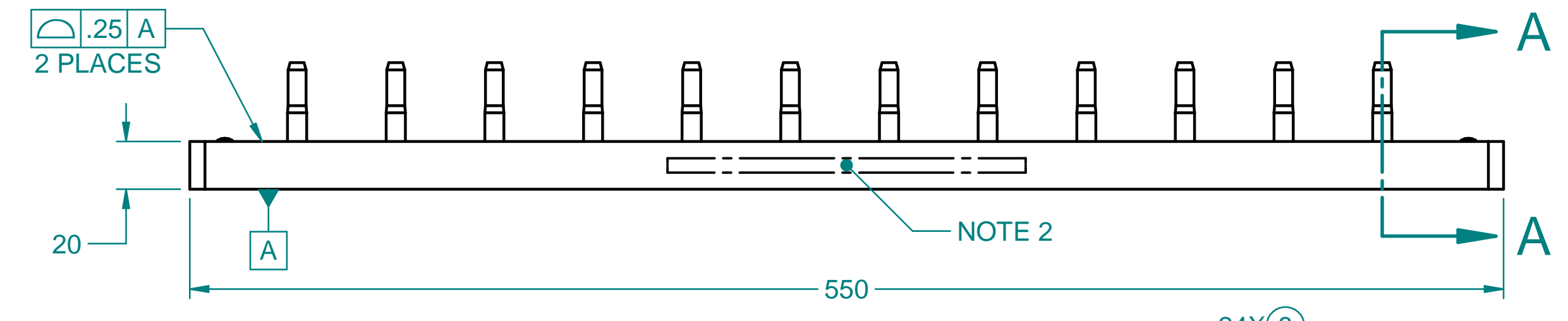
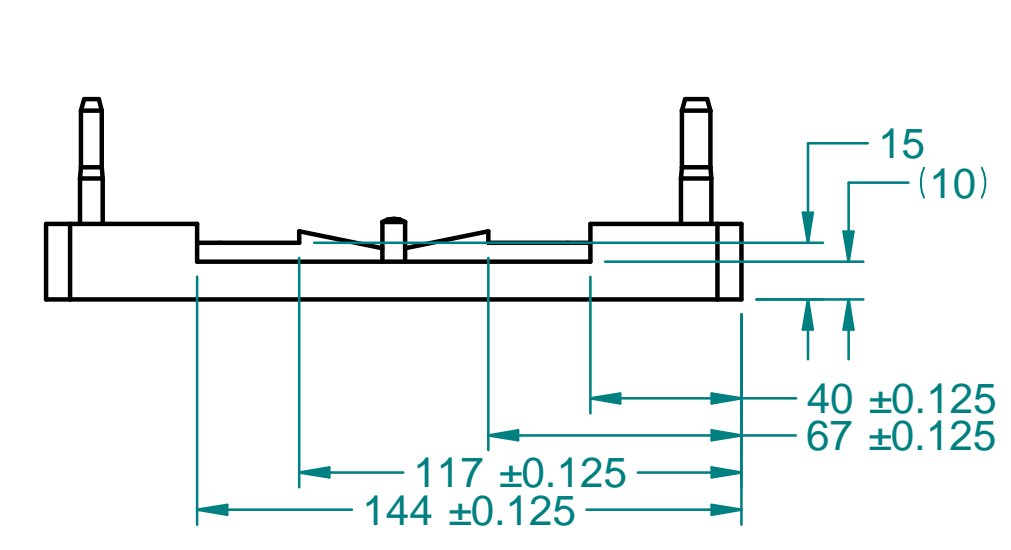
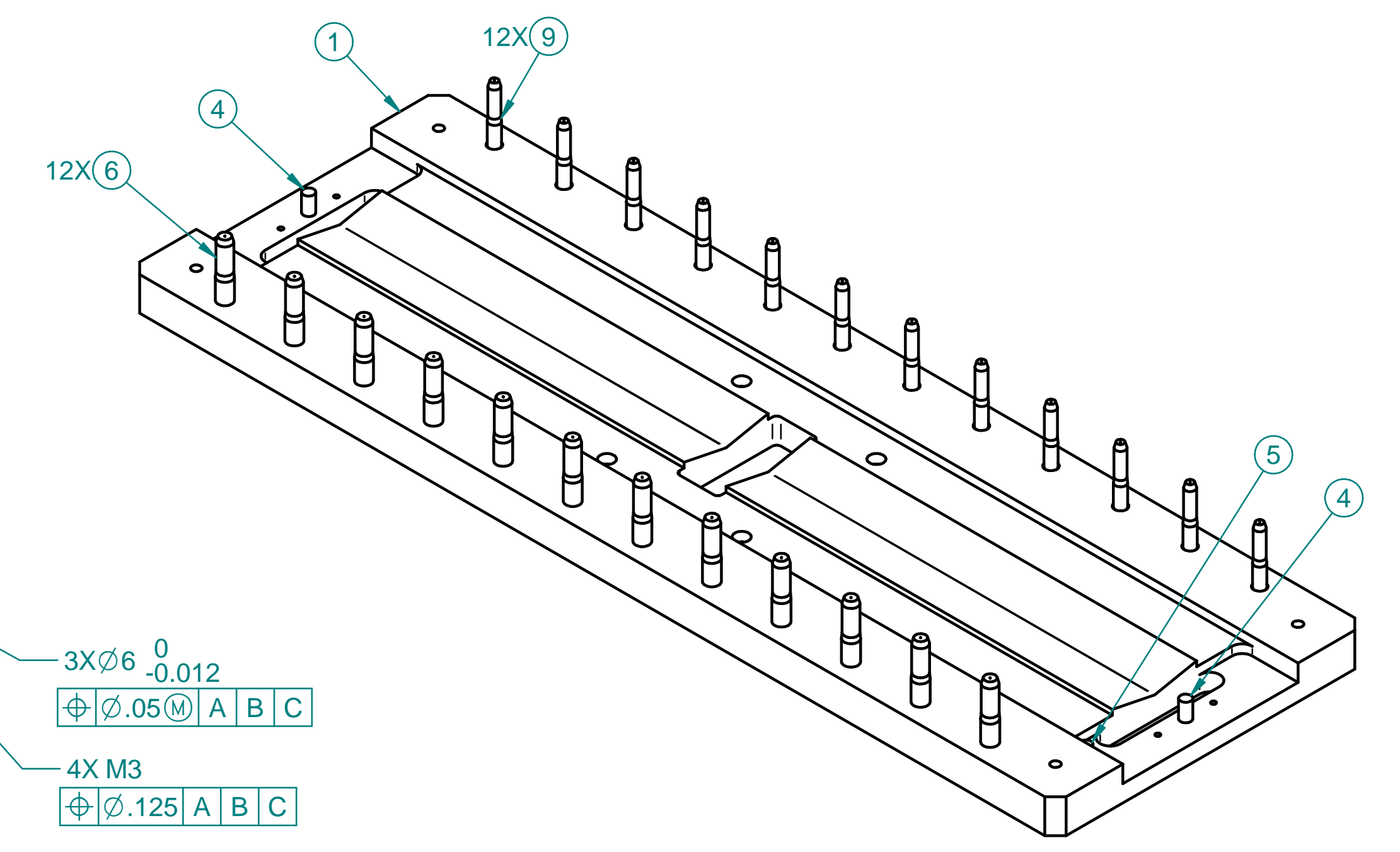
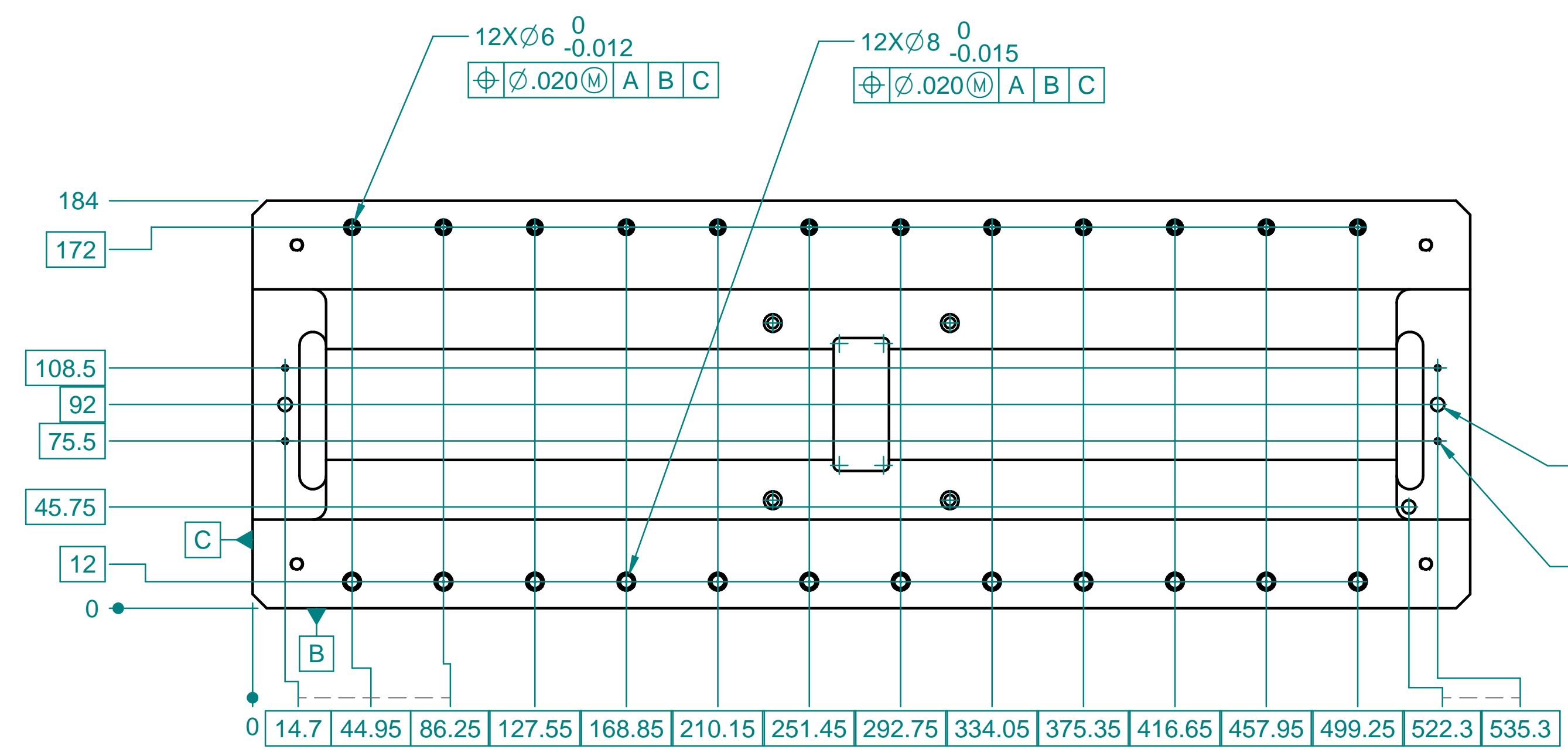

ITEM	TITLE OR DESCRIPTION	MATERIAL	QTY
9	MISUMI SWPG6-P6_00-Q5_50-L12-B12_0-E3_0-F15_0	SST AISI TYPE 304	12
8	WASHER, FLAT, NAR, M3, SST	SST AISI TYPE 316	24
7	SCREW, CAP, SKT HD, M3 X 0.5 X 10 mm, SST 316, COATED WS2	SST AISI TYPE 316	24
6	MISUMI HWPG6-P8_00-Q7_50-L11-B12_0-E3_0-F15_0	SST AISI TYPE 304	12
5	MISUMI MSH6-12	SST	1
4	MISUMI MSH6-20	SST	2
1		ALUMINUM TOOLING PLATE (ATP-5 OR EQUIVALENT)	1

DIMENSIONING AND TOLERANCING IS IN ACCORDANCE WITH ASME Y14.5-2009		SCALE: 1:2 DO NOT SCALE DRAWING	ESTIMATED MASS: 4.934 kg	DWG TYPE: ASSY																		
UNLESS OTHERWISE SPECIFIED DIMENSIONS ARE IN MILLIMETERS		<b>ATLAS ITk LOADING FIXTURE, 19-1 OB STAVE, BASEPLATE AND PINS</b>																				
TOLERANCES: BREAK EDGES 0.13 - 0.4 INTERNAL CORNERS R 0.4 MAX ANGLE ± 1° ALL SURF		THE DRAWINGS, SPECIFICATIONS AND OTHER DATA HEREIN PROVIDED SHALL NOT BE COPIED, PUBLISHED OR OTHERWISE FURTHER DISSEMINATED WITHOUT PRIOR WRITTEN PERMISSION OF STANFORD UNIVERSITY/SLAC																				
REF-000202041	<table border="1"> <tr> <th>DIMENSIONS</th> <td>&lt; 6</td> <td>&gt; 6</td> <td>&gt; 30</td> <td>&gt; 120</td> <td>&gt; 315</td> <td>&gt; 1000</td> <td>&gt; 2000</td> </tr> <tr> <th>GENERAL TOLERANCES</th> <td>± 0.1</td> <td>± 0.2</td> <td>± 0.3</td> <td>± 0.5</td> <td>± 0.8</td> <td>± 1.2</td> <td>± 2</td> </tr> </table>	DIMENSIONS	< 6	> 6	> 30	> 120	> 315	> 1000	> 2000	GENERAL TOLERANCES	± 0.1	± 0.2	± 0.3	± 0.5	± 0.8	± 1.2	± 2	ENGR S. NEWBRY DWN S. NEWBRY CHKR ---	DATE 20220214 APPROVALS --- --- ---	DRAWING NUMBER <b>REF-000203575</b>	REVISION NUMBER <b>A</b>	<b>D</b>
DIMENSIONS	< 6	> 6	> 30	> 120	> 315	> 1000	> 2000															
GENERAL TOLERANCES	± 0.1	± 0.2	± 0.3	± 0.5	± 0.8	± 1.2	± 2															
NEXT ASSEMBLIES:		CAD FILE NAME: REF-000203575.dft																				

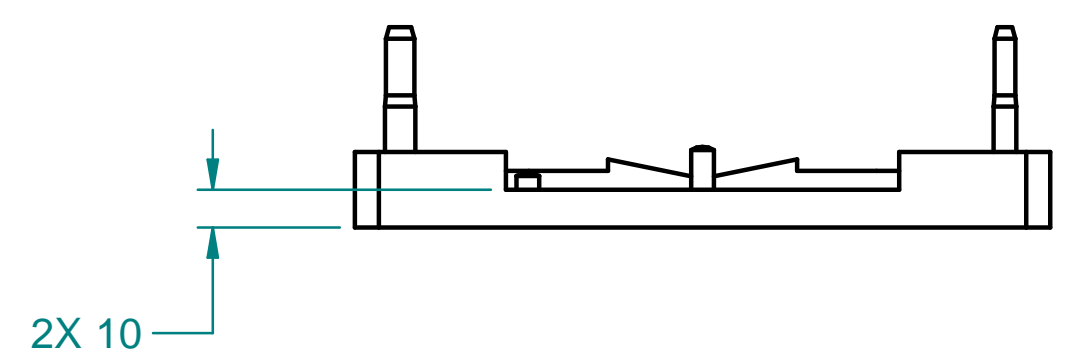
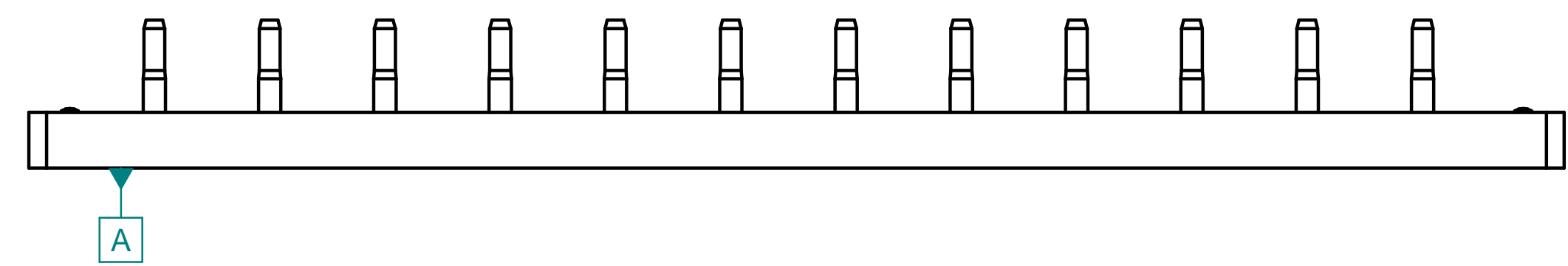
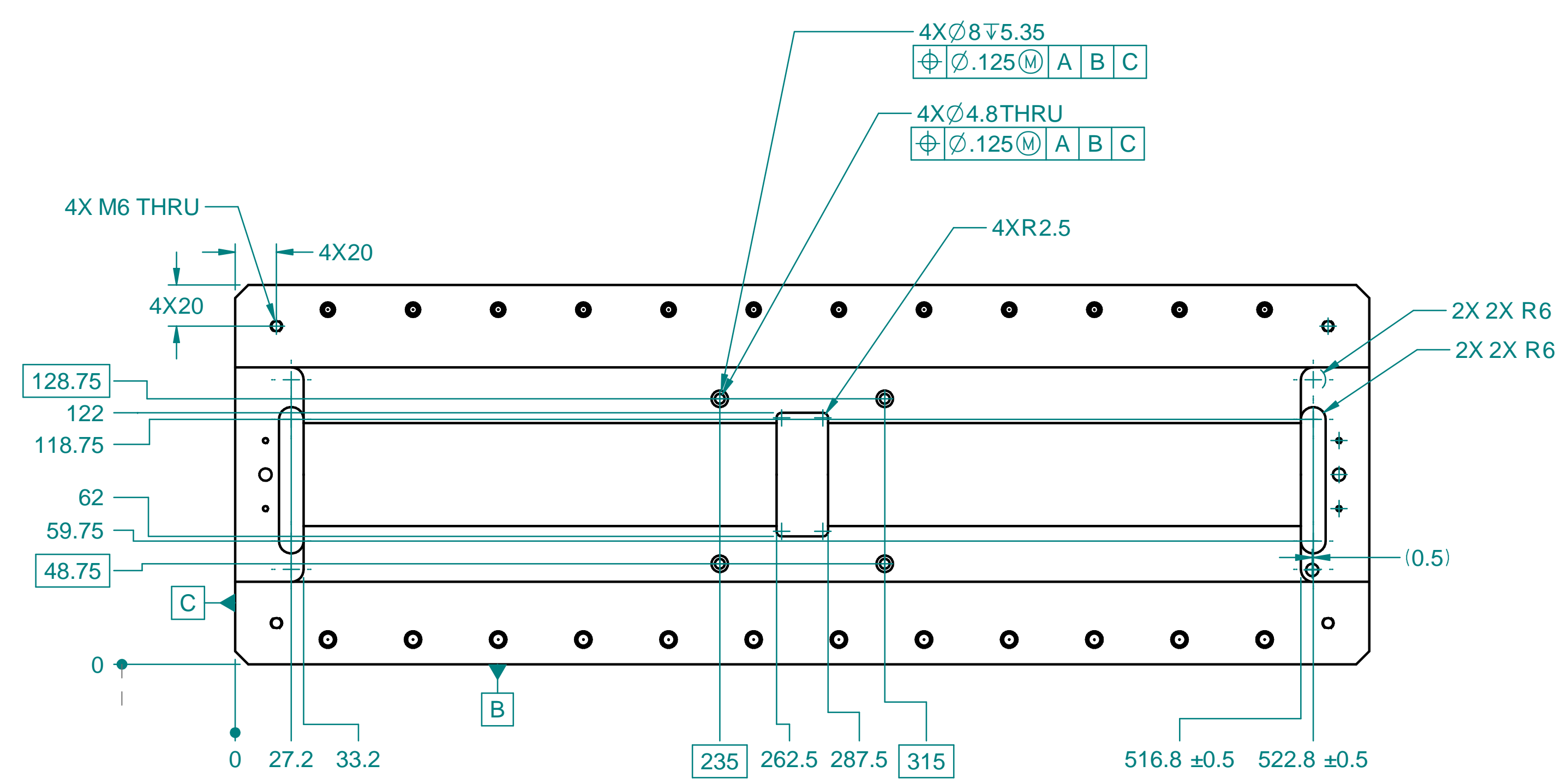

---	DIMENSIONING AND TOLERANCING IS IN ACCORDANCE WITH ASME Y14.5-2009	SCALE: 1:2 DO NOT SCALE DRAWING	ESTIMATED MASS: 4.934 kg	DWG TYPE: ASSY
---	UNLESS OTHERWISE SPECIFIED DIMENSIONS ARE IN MILLIMETERS	<b>SLAC</b> NATIONAL ACCELERATOR LABORATORY	<b>U.S. DEPARTMENT OF ENERGY</b>	<b>ATLAS ITk LOADING FIXTURE, 19-1 OB STAVE, BASEPLATE AND PINS</b>
---	TOLERANCES: BREAK EDGES 0.13 - 0.4 INTERNAL CORNERS R 0.4 MAX	THE DRAWINGS, SPECIFICATIONS AND OTHER DATA HEREIN PROVIDED SHALL NOT BE COPIED, PUBLISHED OR OTHERWISE FURTHER DISSEMINATED WITHOUT PRIOR WRITTEN PERMISSION OF STANFORD UNIVERSITY/SLAC		
---	ANGLE ± 1° ALL SURF $\sqrt{125}$	ENGR S. NEWBRY DWN S. NEWBRY CHKR ---	DATE 20220214	APPROVALS ---
REF-000202041	DIMENSIONS <6 >6 >30 >120 >315 >1000 >2000	DRAWING NUMBER: REF-000203575		
NEXT ASSEMBLIES:	GENERAL TOLERANCES ±0.1 ±0.2 ±0.3 ±0.5 ±0.8 ±1.2 ±2	REVISION NUMBER: A D		