

NOTES UNLESS OTHERWISE SPECIFIED:

1. MATERIAL: SEE TABLE. DO NOT SUBSTITUTE.
2. EMBOSS OR ENGRAVE PART AND REVISION NUMBER APPROX. WHERE SHOWN.
3. FINAL PROTECTIVE FINISH PER MIL-DTL-5541 TYPE II CLASS 3 (CLEAR ALODINE)
4. INSTALL PINS AS SHOWN. ALL DIMENSIONS APPLY AFTER PINS INSTALLED.
5. DEGREASE WITH ALCOHOL AND CUSHION TO PROTECT FROM HANDLING DAMAGE.

**CHECK-PRINT**  
newbry  
03-07-2022 12:19:31 PM

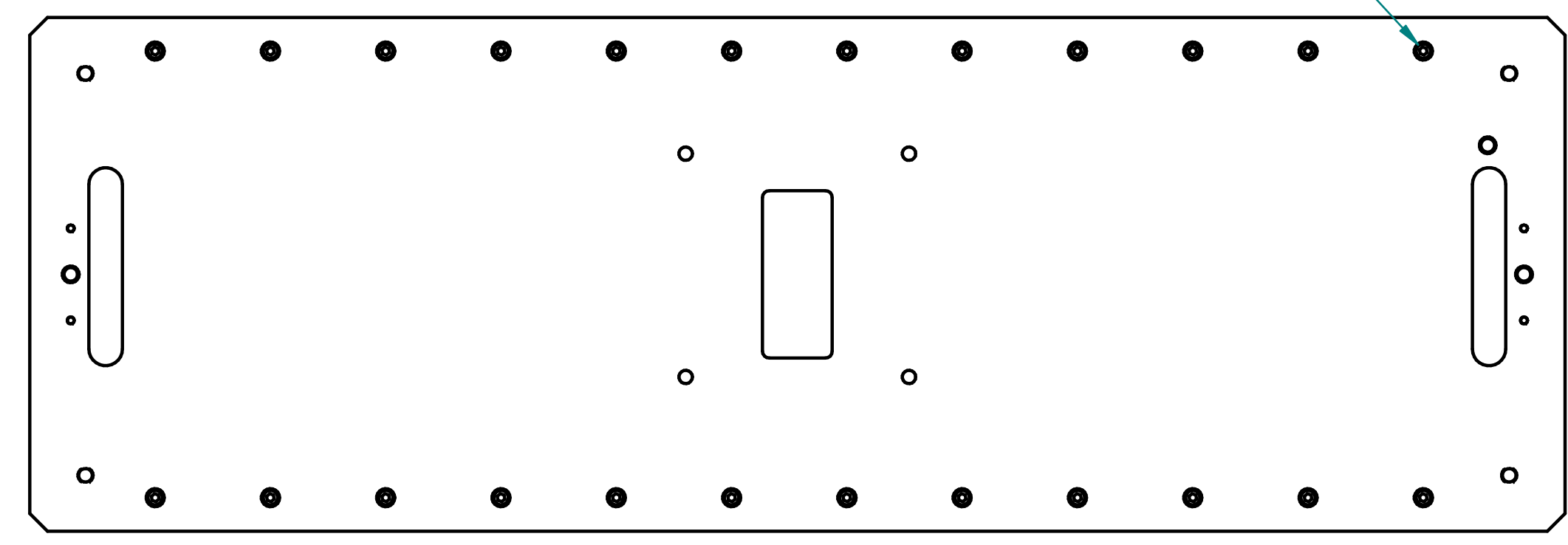
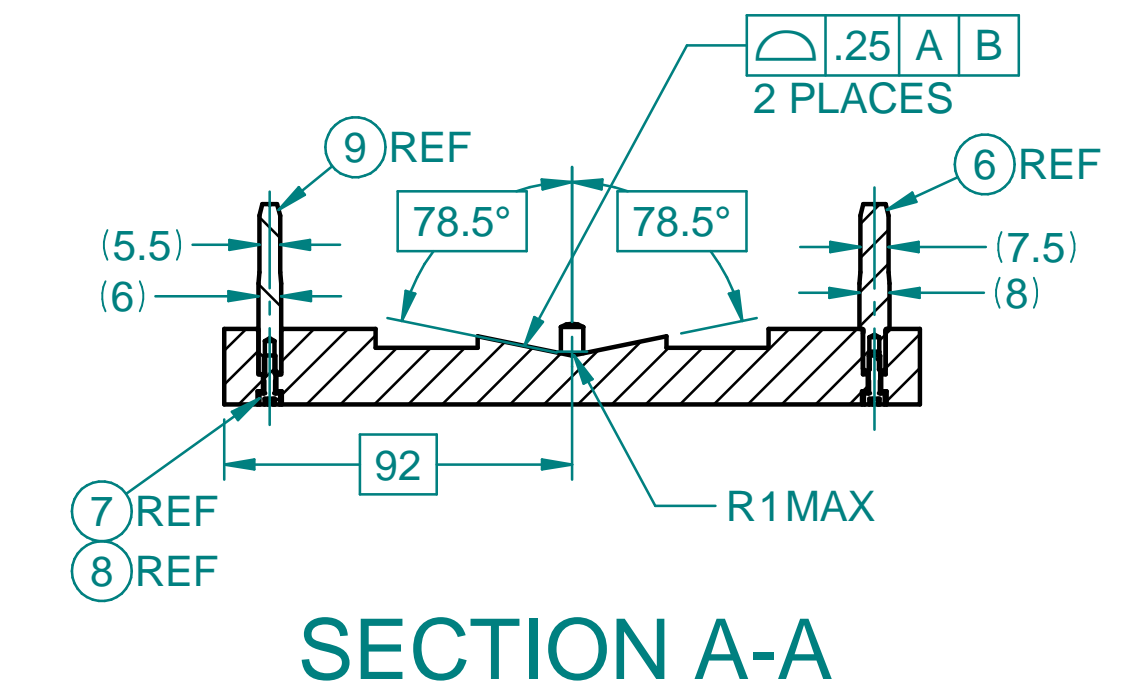
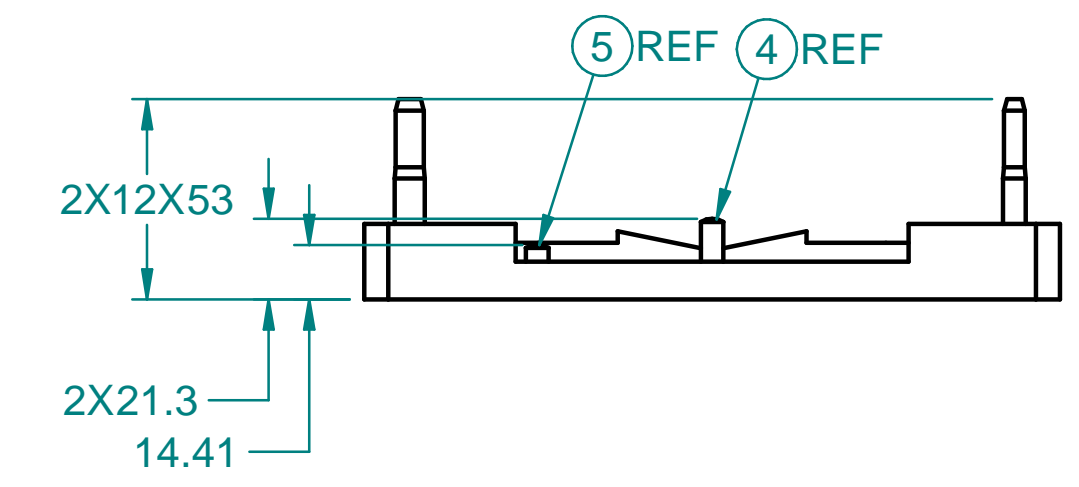
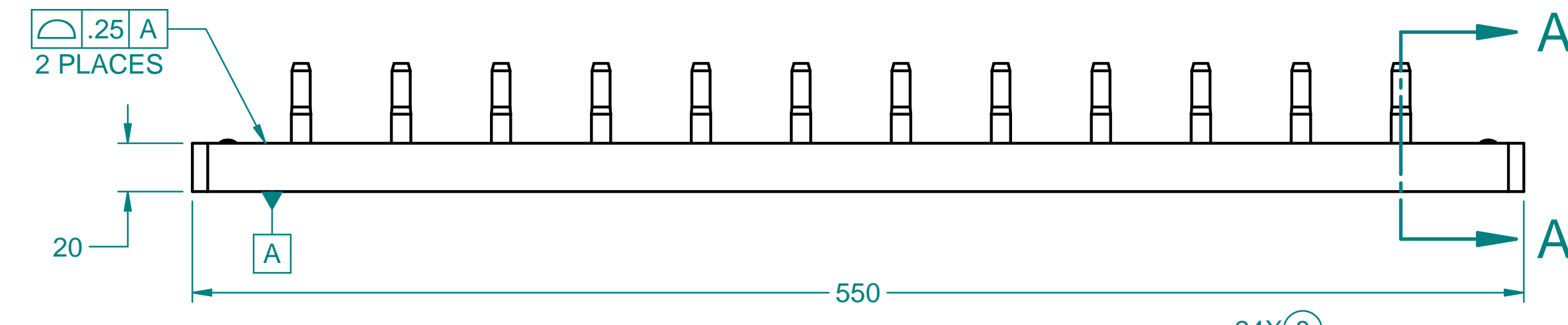
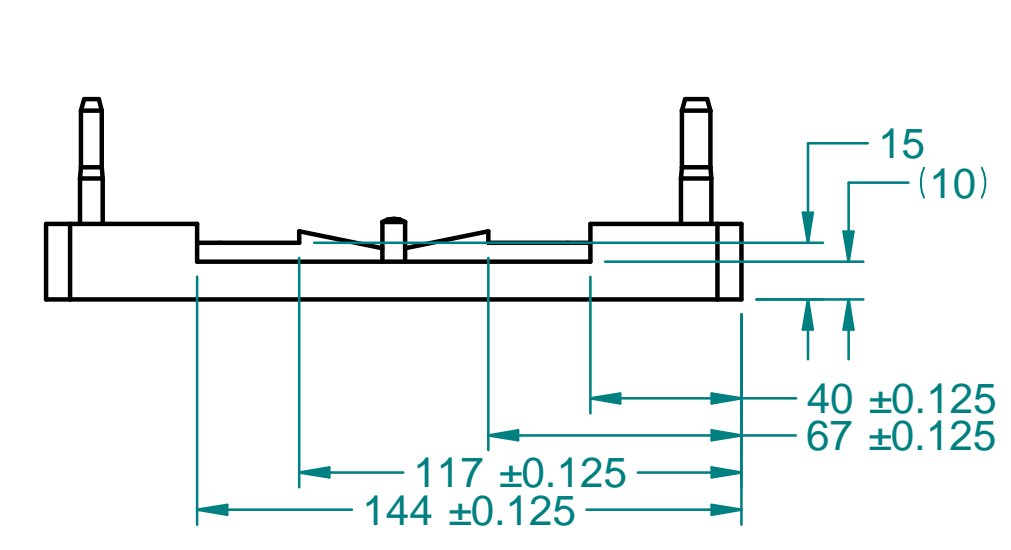
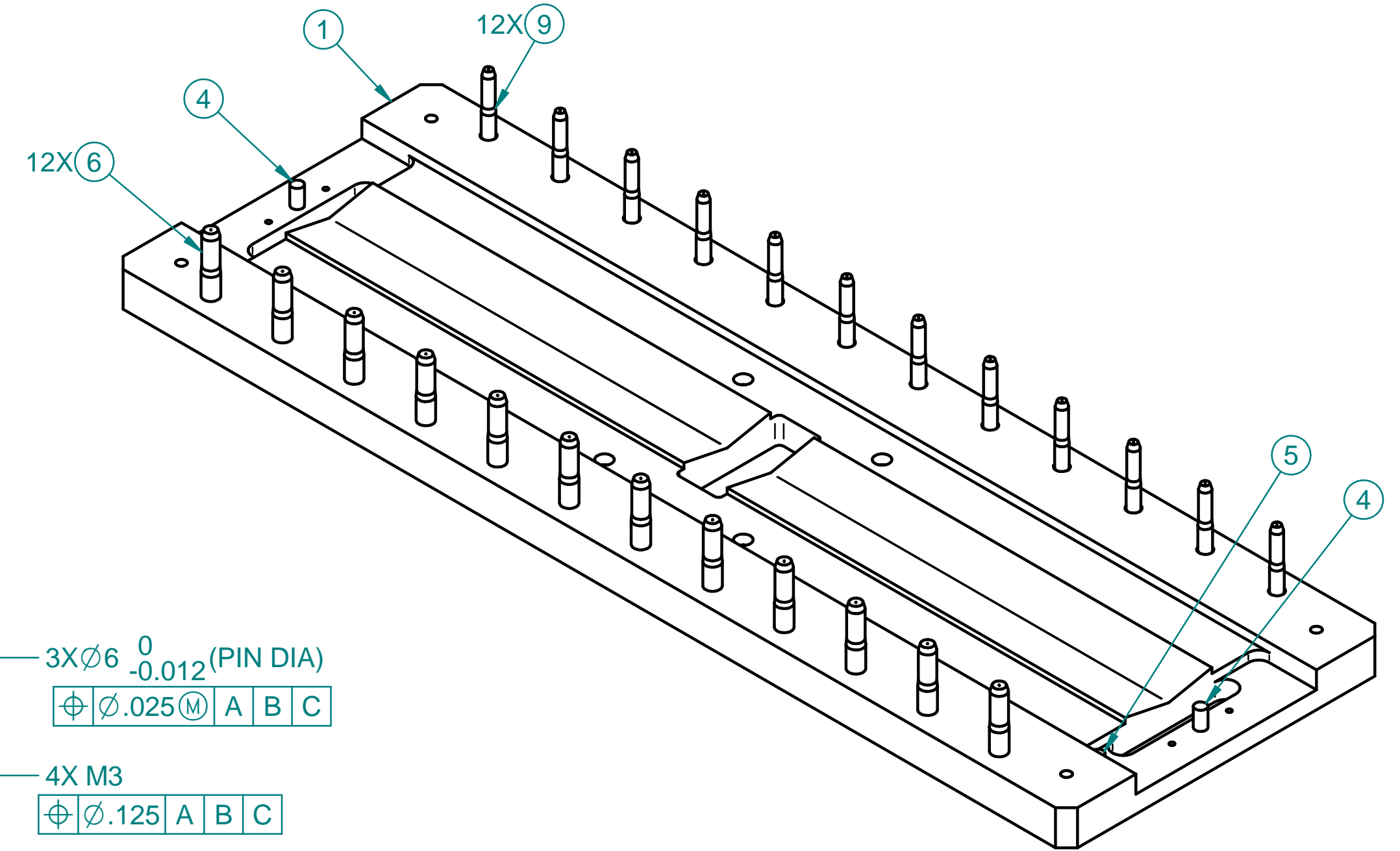
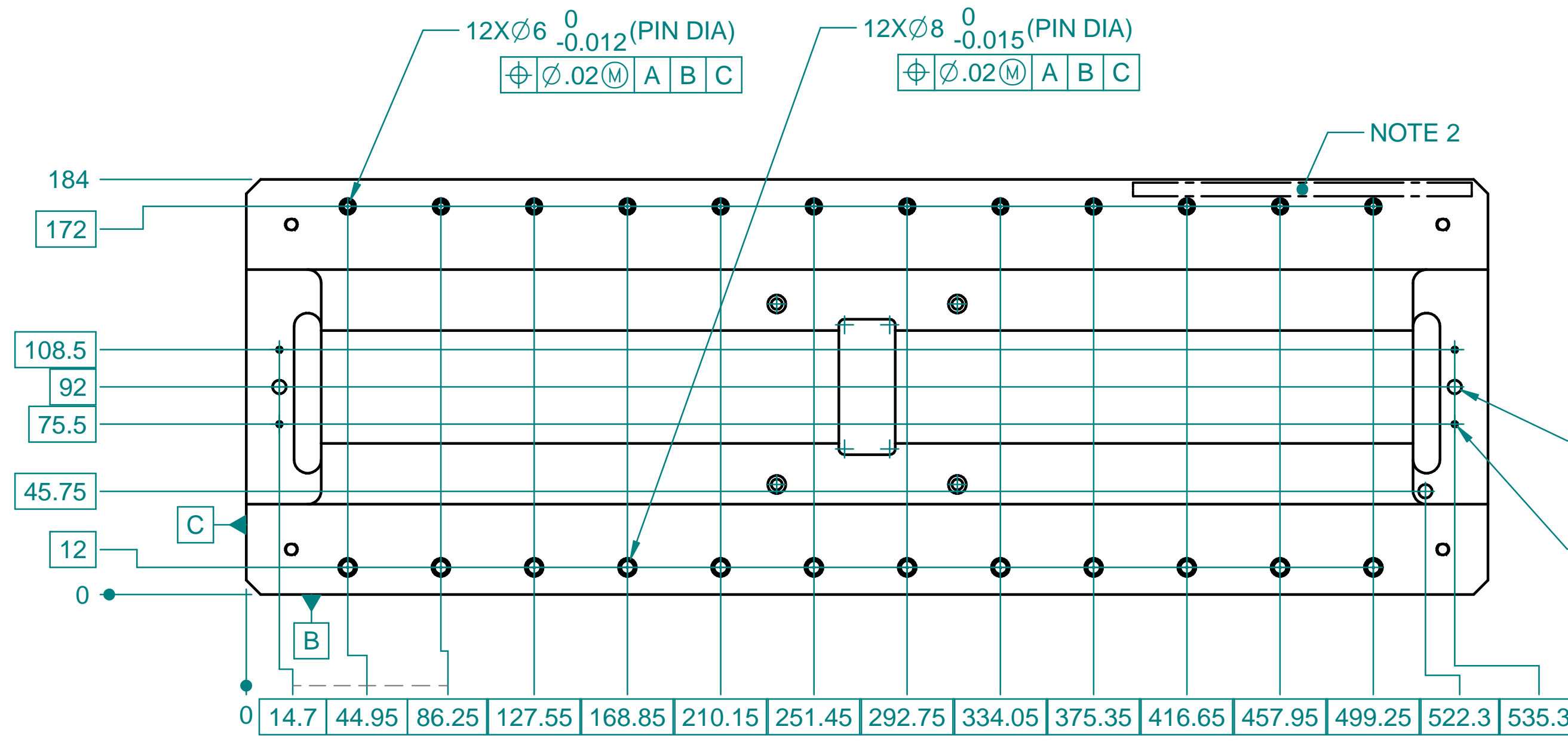

ITEM	NUMBER	DESCRIPTION	QTY
9	MISUMI SWPG6-P6.00-Q5.50-L12-B12.0-E3.0-F15.0	DOWEL PIN, STEPPED, 6 OD, H7 TOL., SST	12
8		WASHER, FLAT, NAR, M3, SST	24
7	UC COMPONENTS MC -310-NW	SCREW, CAP, SKT HD, M3X0.5 X 10mm, SST 316, COATED WS2	24
6	MISUMI HWP6-P8.00-Q7.50-L11-B12.0-E3.0-F15.0	DOWEL PIN, STEPPED, 8 OD, H7 TOL., SST	12
5	MISUMI MSH6-30	DOWEL PIN, UNDERSIZED, 6 DIA, 30 LG, SST	1
4	MISUMI MSH6-30	DOWEL PIN, UNDERSIZED, 6 DIA, 30 LG, SST	2
1		MATERIAL: ALUMINUM TOOLING PLATE, ATP5 OR EQUIVALENT	1

DIMENSIONING AND TOLERANCING IS IN ACCORDANCE WITH ASME Y14.5-2009		SCALE: 1:2 DO NOT SCALE DRAWING	ESTIMATED MASS: 4.934 kg	DWG TYPE: ASSY																	
UNLESS OTHERWISE SPECIFIED DIMENSIONS ARE IN MILLIMETERS		 <b>U.S. DEPARTMENT OF ENERGY</b> NATIONAL ACCELERATOR LABORATORY	<b>ATLAS ITk LOADING FIXTURE, 19-1 OB STAVE, BASEPLATE AND PINS</b>																		
TOLERANCES: BREAK EDGES 0.13 - 0.4 INTERNAL CORNERS R 0.4 MAX ANGLE ± 1° ALL SURF																					
REF-000202041		ENGR S. NEWBRY DWN S. NEWBRY CHKR ---	DATE 20220214	APPROVALS --- --- ---																	
NEXT ASSEMBLIES:	<table border="1"> <tr> <th>DIMENSIONS</th> <th>&lt; 6</th> <th>&gt; 6</th> <th>&gt; 30</th> <th>&gt; 120</th> <th>&gt; 315</th> <th>&gt; 1000</th> <th>&gt; 2000</th> </tr> <tr> <td>GENERAL TOLERANCES</td> <td>± 0.1</td> <td>± 0.2</td> <td>± 0.3</td> <td>± 0.5</td> <td>± 0.8</td> <td>± 1.2</td> <td>± 2</td> </tr> </table>	DIMENSIONS	< 6	> 6	> 30	> 120	> 315	> 1000	> 2000	GENERAL TOLERANCES	± 0.1	± 0.2	± 0.3	± 0.5	± 0.8	± 1.2	± 2	THE DRAWINGS, SPECIFICATIONS AND OTHER DATA HEREIN PROVIDED SHALL NOT BE COPIED, PUBLISHED OR OTHERWISE FURTHER DISSEMINATED WITHOUT PRIOR WRITTEN PERMISSION OF STANFORD UNIVERSITY/SLAC		DRAWING NUMBER <b>REF-000203575</b>	REVISION NUMBER <b>A</b>
DIMENSIONS	< 6	> 6	> 30	> 120	> 315	> 1000	> 2000														
GENERAL TOLERANCES	± 0.1	± 0.2	± 0.3	± 0.5	± 0.8	± 1.2	± 2														

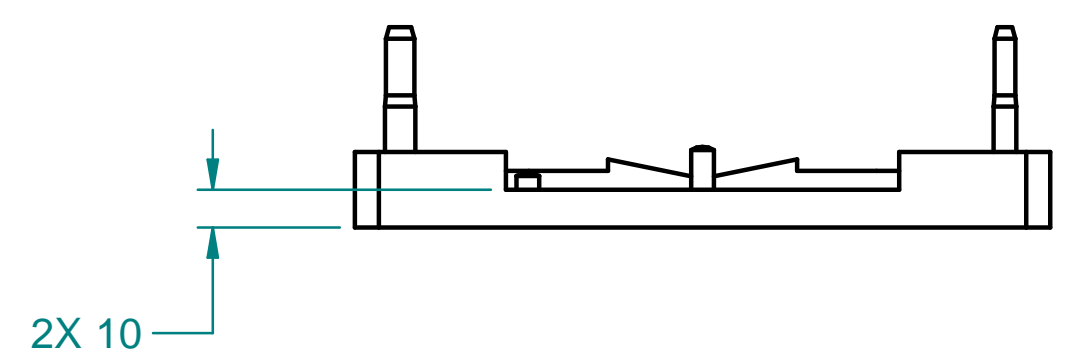
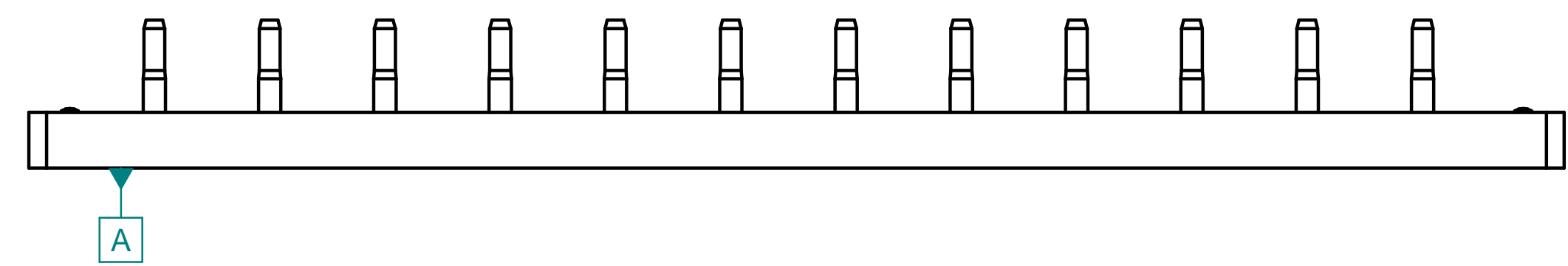
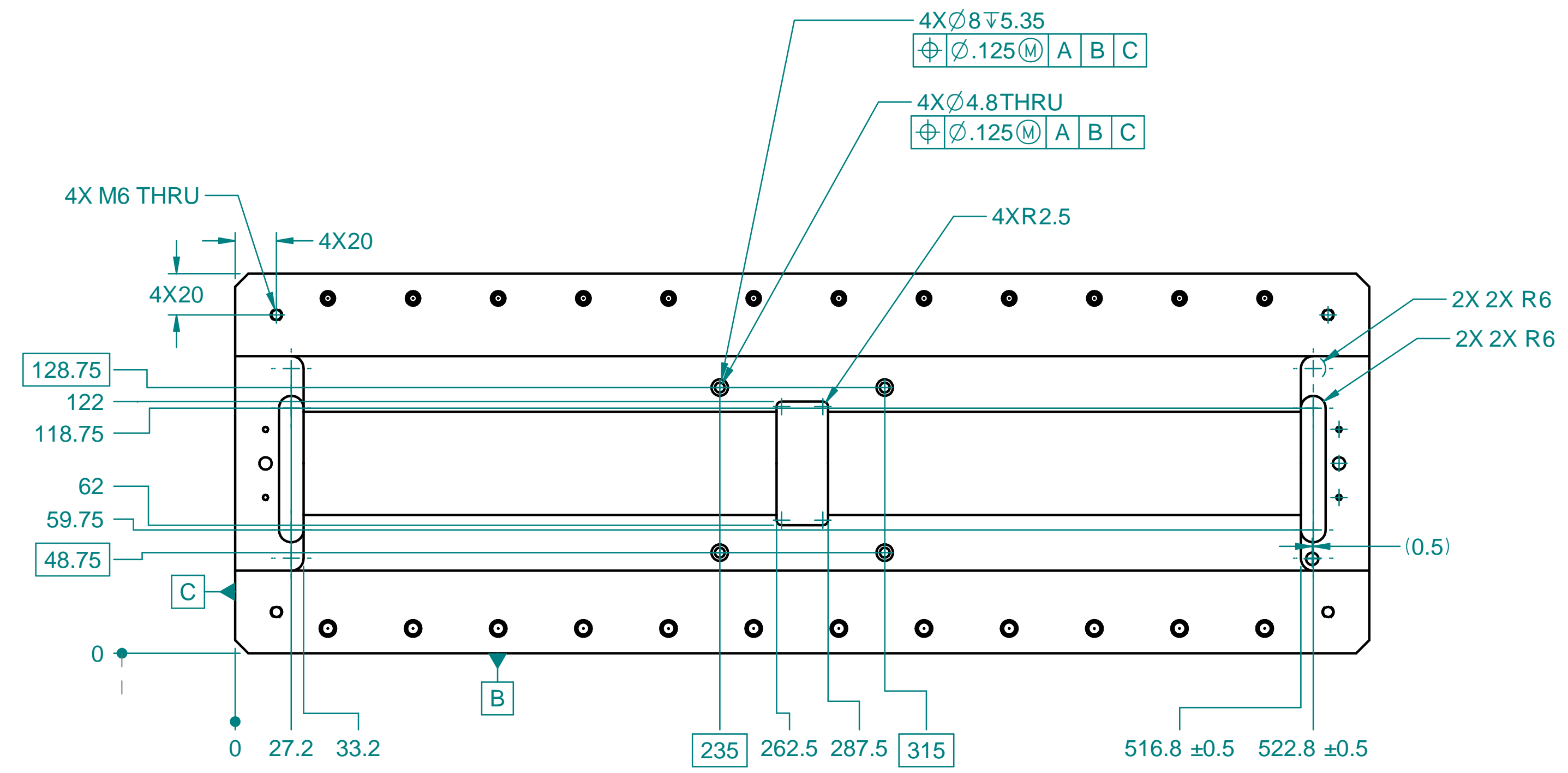

---	DIMENSIONING AND TOLERANCING IS IN ACCORDANCE WITH ASME Y14.5-2009	SCALE: 1:2 DO NOT SCALE DRAWING	ESTIMATED MASS: 4.934 kg	DWG TYPE: ASSY								
---	UNLESS OTHERWISE SPECIFIED DIMENSIONS ARE IN MILLIMETERS	<b>SLAC</b> NATIONAL ACCELERATOR LABORATORY	<b>U.S. DEPARTMENT OF ENERGY</b>	<b>ATLAS ITk LOADING FIXTURE, 19-1 OB STAVE, BASEPLATE AND PINS</b>								
---	TOLERANCES: BREAK EDGES 0.13 - 0.4 INTERNAL CORNERS R 0.4 MAX	THE DRAWINGS, SPECIFICATIONS AND OTHER DATA HEREIN PROVIDED SHALL NOT BE COPIED, PUBLISHED OR OTHERWISE FURTHER DISSEMINATED WITHOUT PRIOR WRITTEN PERMISSION OF STANFORD UNIVERSITY/SLAC										
---	ANGLE ± 1° ALL SURF $\sqrt{125}$	ENGR S. NEWBRY DWN S. NEWBRY CHKR ---										
REF-000202041	DIMENSIONS	< 6	> 6	> 30	> 120	> 315	> 1000	> 2000	DATE: 20220214	APPROVALS	DRAWING NUMBER	REVISION NUMBER
NEXT ASSEMBLIES:	GENERAL TOLERANCES	± 0.1	± 0.2	± 0.3	± 0.5	± 0.8	± 1.2	± 2	---	---	REF-000203575	A
											D	---