

REV	DESCRIPTION	DWN	CHKR	APVD	DATE

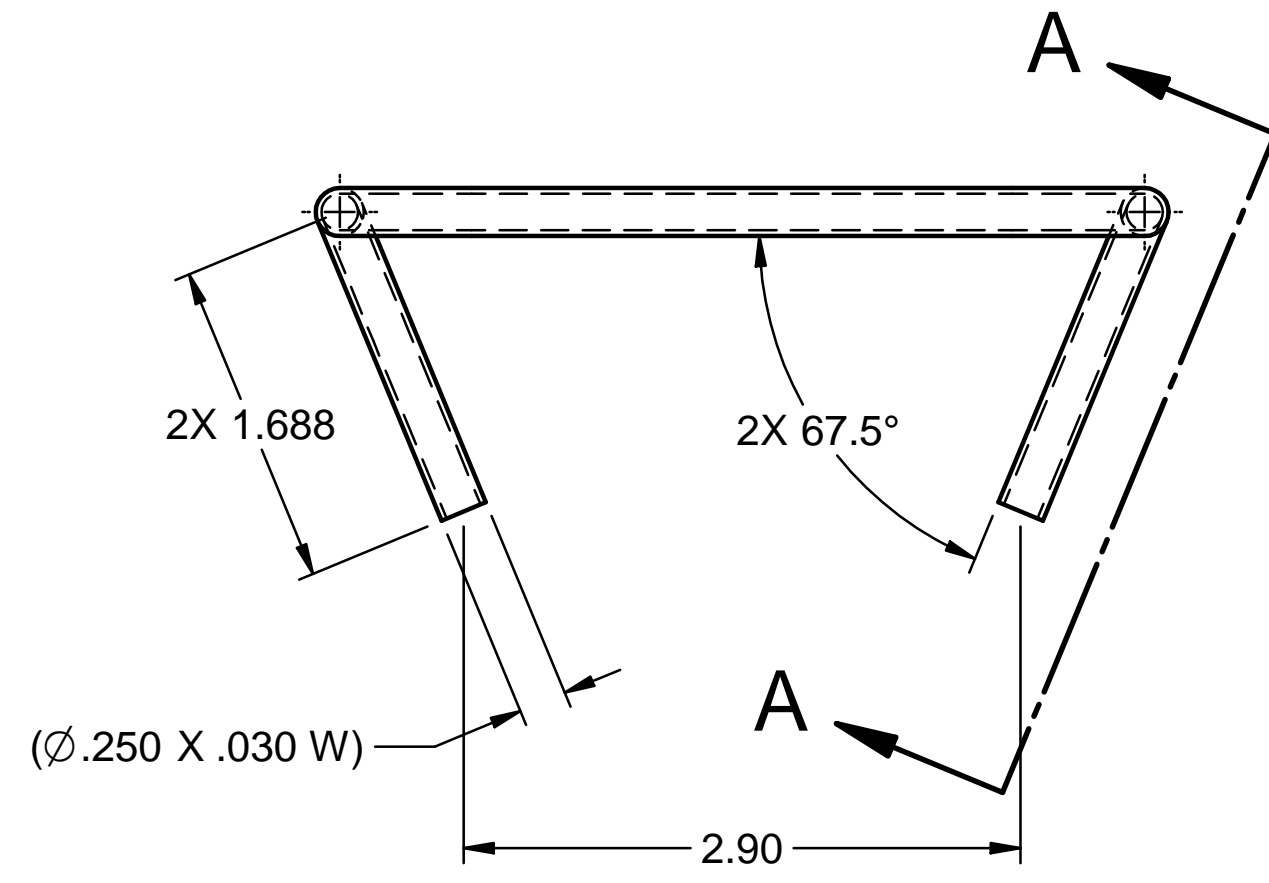
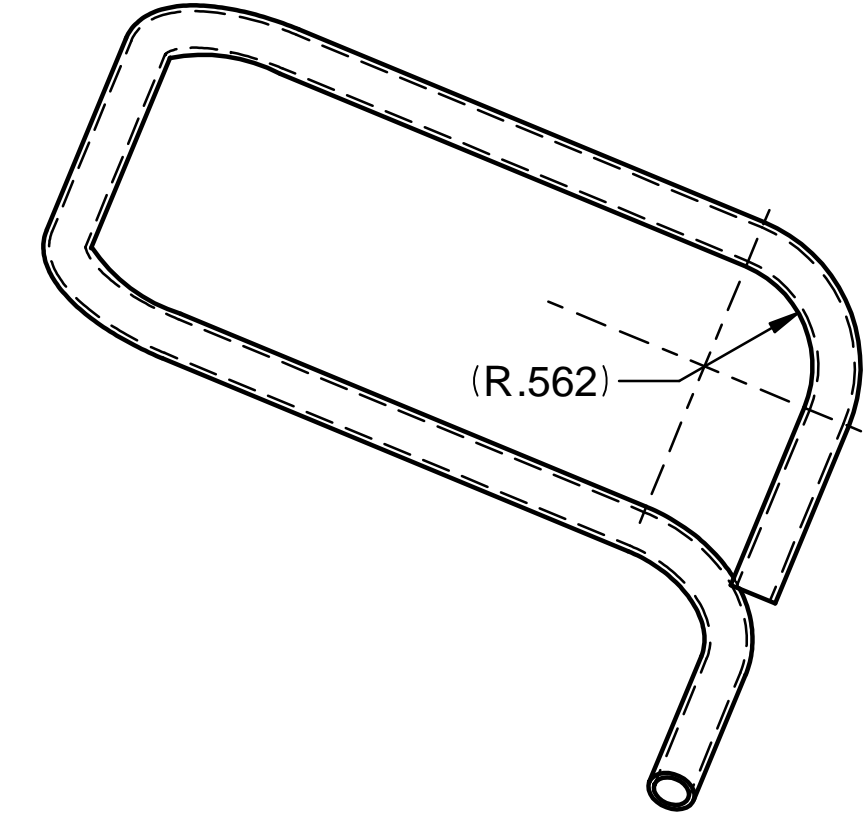
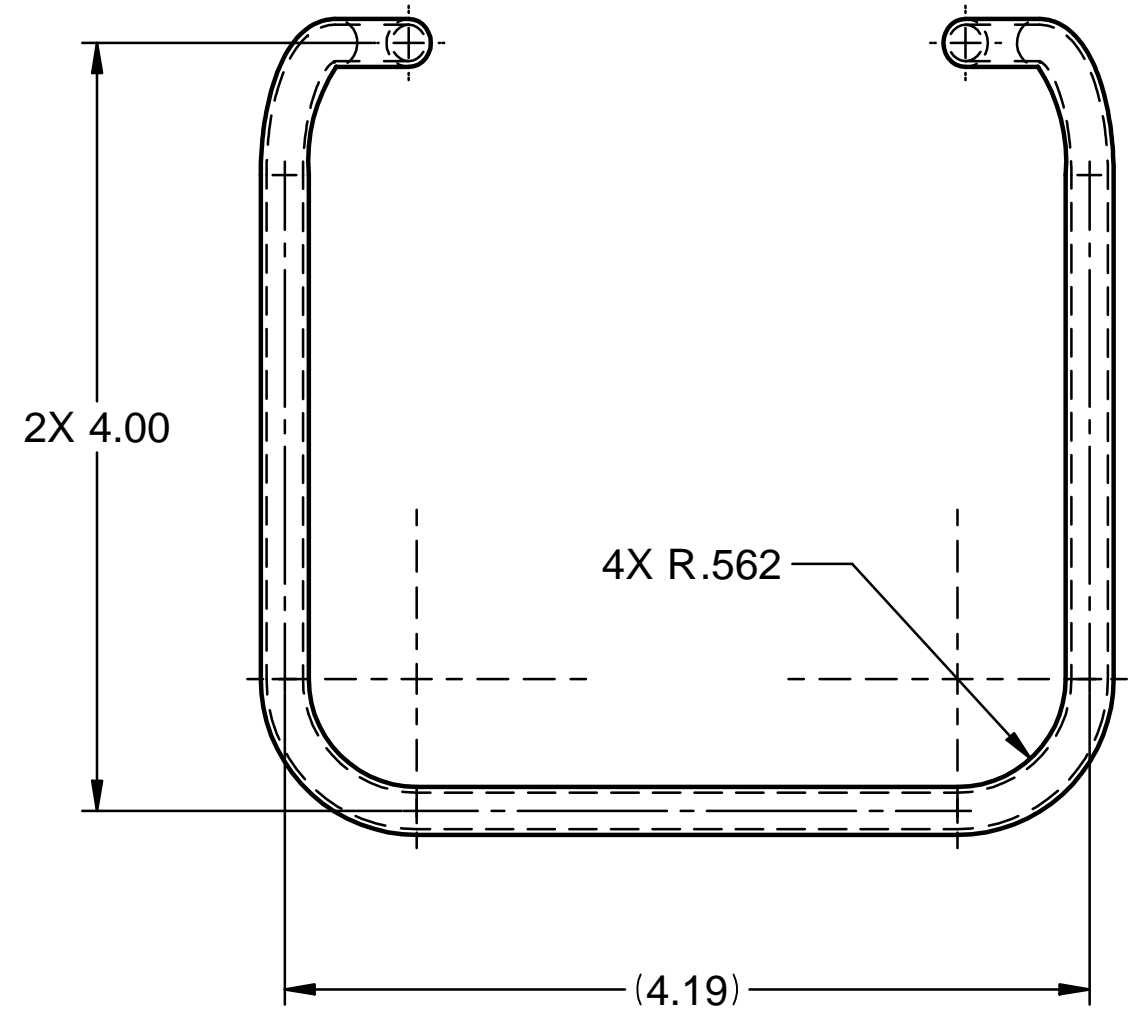
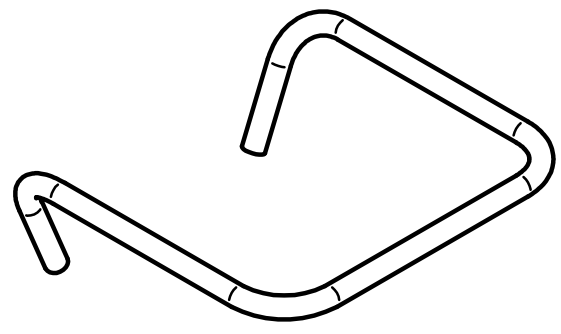

- NOTES: (UNLESS OTHERWISE SPECIFIED)
1. THIS IS AN ULTRA HIGH VACUUM COMPONENT. FABRICATE IN ACCORDANCE WITH SLAC SPECIFICATION FP-202-631-14.
 2. MATERIAL: .250 OD X .030 WALL SST TUBING.

SSRL BLS
UHV/BRAZE PART
 MATERIAL CERTIFICATIONS REQUIRED
 SLAC FP-202-631-14 APPLIES
 SEE NOTES

---	DIMENSIONING AND TOLERANCING IS IAW ASME Y14.5-2009	SCALE: 1:1 DO NOT SCALE DRAWING	ESTIMATED MASS: .084 LB	CAD FILE NAME: pf45143353-0.dft
---	UNLESS OTHERWISE SPECIFIED DIMENSIONS ARE IN INCHES.	SLAC NATIONAL ACCELERATOR LABORATORY	U.S. DEPARTMENT OF ENERGY	SSRL BEAMLINE 16 BL16-2 EXPER. FLOOR INSTALL PGM UPSTREAM APERTURE CUSTOM TUBE BENDUP
---	TOLERANCES: BREAK EDGES .005-.015 INTERNAL CORNERS R.015 MAX	THE DRAWINGS, SPECIFICATIONS AND OTHER DATA HEREIN PROVIDED SHALL NOT BE COPIED, PUBLISHED OR OTHERWISE FURTHER DISSEMINATED WITHOUT PRIOR WRITTEN PERMISSION OF STANFORD UNIVERSITY/SLAC		
---	FRACTIONS ± --- DEC .XX± .01 .XXX± .005 .XXXX± --- ANGLE ± 1/2	ENGR M. CHURCH DWN S. WEAVER CHKR M. CHURCH	DATE 20170526 APPROVALS M. CHURCH 05-24-2017	
---	SA-451-433-49	DRAWING NUMBER PF-451-433-53		REVISION NUMBER 0
---	NEXT ASSEMBLIES:			C

PF-451-433-53 0 C SH 1 OF 1